

ZTE

ZTE Warp™ Basics Guide

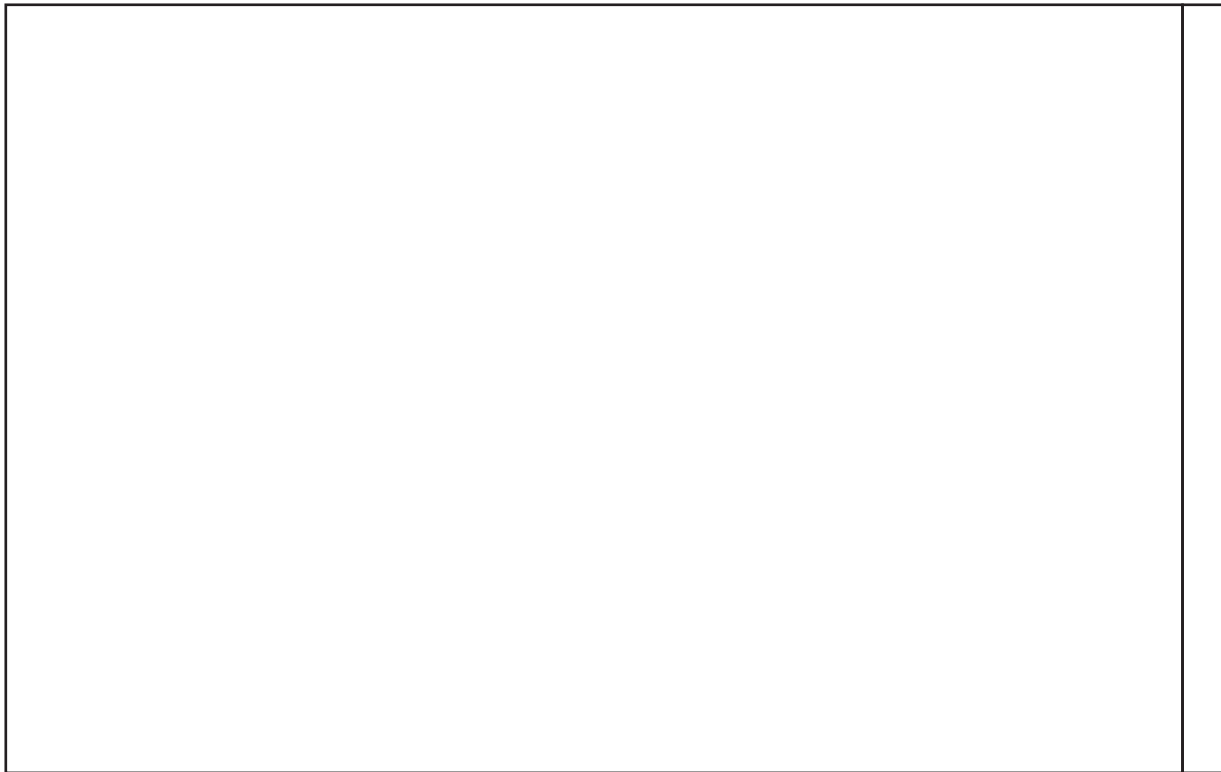

WWW.ZTEUSA.COM



Basics Guide

ZTE Warp™

www.boostmobile.com

ZTE

To find the full user guide, please visit www.boostmobile.com/userguides.
Spanish language user guide is also available online.

Table of Contents

Getting Started	13
Overview	14
Keys Explained	16
Starting Up	17
Installing the microSD Card and Battery	17
Removing the Battery and microSD Card	19
Charging the Battery	19
Extending the Battery Life	21
Switching Your Phone On/Off	21
Activating Your Phone	22
Menu Outline	22
Switching to Sleep Mode	25
Waking Up Your Phone	25
Setting Up Your Voicemail	26
Getting Around Your Phone	27
Touch Control	27
Home Screen	27
Status and Notification Icons	32
Using the Notification Panel	33
Changing the Screen Orientation	34
Settings Preview	35

Phone Calls.....	37
Making Calls.....	37
Calling from the Dialer	37
Calling from Your Contacts	37
Calling from Your Call Log.....	37
Calling from a Text Message	38
Using Speed Dial	38
Making Emergency Calls	39
Making International Calls (Plus Code Dialing).....	40
Making a 3-Way Call.....	40
Dialing Options	41
Receiving Calls.....	41
Answering a Call	41
Rejecting a Call.....	41
In-Call Options.....	42
Muting a Call	42
Turning the Speaker On/Off.....	42
Putting a Call on Hold	42
Adding a Call.....	42
Using the Dialpad.....	42
Using Bluetooth Headset	43
Ending a Call.....	43
Contacts	44

Creating a Contact	44
Contacts Menu Options	45
Contacts Entry Options	45
Adding a Number to a Contact	46
Importing and Exporting Contacts	46
Entering Text	47
Android Keypad	47
XT9 Text Input	48
Messaging.....	53
Sending a Text Message	53
Sending an MMS Message.....	53
Managing Messages and Their 'Threads'	55
Replying to a Message.....	55
Deleting a Message Thread	55
Message Settings.....	55
Email.....	57
Creating an Email Account	57
Setting Up a Microsoft Exchange Email	57
Opening Email	58
Composing Email.....	58
Getting Connected to the Internet.....	60
Enabling Data Access Over CDMA/EvDo	60

Turning on Wi-Fi.....	60
Connecting to a Wi-Fi Network.....	60
Adding a Wi-Fi Network.....	61
Checking the Wi-Fi Network Status.....	61
Using Airplane Mode.....	62
Browsing the Internet.....	63
Downloading Links from the Web.....	63
Using Bookmarks.....	63
Adding a Bookmark.....	63
Editing a Bookmark.....	64
Deleting a Bookmark.....	64
Adding Bookmarks to Your Home Screen.....	64
Creating a New Home Page.....	64
Bluetooth®.....	65
Turning Bluetooth On/Off.....	65
Making Your Phone Visible.....	65
Pairing With Another Bluetooth Device.....	66
Deleting a Paired Device (Unpair).....	66
Making the Most of Multimedia.....	67
Taking Pictures With Your Camera.....	67
Adjusting Camera Settings.....	67
Shooting Video With Your Camcorder.....	68

Adjusting Video Settings	68
Playing Your Music	69
Creating Playlists	70
Setting a Song as Ringtone	70
Playing Your Videos	70
Viewing Your Gallery	71
Using Your Google™ Applications	73
Creating a Google Account	73
Signing In to Your Google Account	73
Android Market	74
Accessing the Market	74
Installing a Google Application	74
Launching an Installed Google Application	75
Google Search	75
Launching the Google Search Box	75
Using Google Search	76
Gmail	77
Opening Gmail	77
Composing Gmail	77
Google Calendar	78
Google Maps	78
Enabling Location Mode	78
Launching Google Maps	79

Finding Your Location	79
Navigation	79
Places	80
Latitude	80
Google Talk	81
Phone Settings	82
Setting Time and Date Format	82
Call Settings	82
TTY Mode	82
Hearing Aids	83
DTMF Tones	83
Speed Dial	83
Plus Code Dialing Setting	83
Call Forwarding	84
Internet Call Settings	84
Sound Settings	85
Setting the Phone Ringtone	85
Setting the Notification Ringtone	86
Switching to Silent Mode	86
Switching to Vibrate	86
Display Settings	87
Adjusting Screen Brightness	87
Adjusting Screen-timeout	87

Changing Screen Orientation	88
Language Settings	88
Mobile Network Services	88
Enabling Data Services	88
Switching Network Modes	89
Location Settings	89
Security Settings	89
Protecting Your Phone With a Screen Unlock Pattern	90
Disabling Screen Lock Settings	93
Calling in Lock Mode	93
Application Settings	93
Installing an Application	93
Viewing Installed Applications	94
Removing an Application	94
Clearing an Application's Cache	94
Moving an Application Between the Phone and Memory Card	94
Managing Running Services	95
Storage Use	95
Battery Use	95
Managing Memory Card	95
Turning On/Off USB Mass Storage	95
Checking Memory Card Space	96
Unmounting the Memory Card	96
Erasing the Memory Card	96

Checking Phone Memory	96
Accessibility Settings	97
Resetting Your Phone	97
System Updates and Phone Information.....	98
Updating the System.....	98
Viewing Phone Information	98
Other Applications	100
Alarms	100
Calculator	100
Docs To Go	100
My Files	100
Global Time	101
Note Pad	101
Stopwatch.....	101
Task Manager	101
Voice Dialer	102
Calling a Contact With Voice Dialer	102
Specifications	103
For Your Safety	104
General Safety	104
Radio Frequency (RF) Energy	105
FCC Compliance	106

Using Your Phone With a Hearing Aid Device.....	107
Turning on the HAC Setting.....	108
Distraction.....	108
Driving.....	108
Operating Machinery.....	109
Product Handling.....	109
General Statement on Handling and Use.....	109
Battery.....	110
Small Children.....	110
Demagnetization.....	111
Antennas.....	111
Normal Use Position.....	111
Air Bags.....	112
Seizures/Blackouts.....	112
Repetitive Strain Injuries.....	113
Emergency Calls.....	113
Loud Noise.....	113
Phone Heating.....	113
Electrical Safety.....	114
Accessories.....	114
Connection to a Car.....	114
Faulty and Damaged Products.....	114
Radio Frequency Interference.....	114
General Statement on Interference.....	114

Pacemakers	115
Hearing Aids	115
Medical Equipment	115
Aircraft.....	115
Interference in Vehicles	116
Explosive Environments	116
Gas Stations and Explosive Atmospheres.....	116
Blasting Caps and Areas	116
Consumer Limited Warranty	117

Getting Started

Thanks for choosing the ZTE Warp. Please read this guide carefully and keep it for future reference.

The pictures and icons presented in this guide are meant for illustrative purposes only and may not accurately represent the actual pictures and icons found on the phone. Your phone contains the most up to date information.

The main way to control your phone is by using your finger to manipulate icons, buttons, menu items, the onscreen keypad, and other items on the touchscreen. You can 'tap' an item to select and open it, 'slide' left or right on the Home screen, 'hold' files until a list of shortcuts pops up, 'drag' items into the bin, or 'pinch' images and web pages to zoom in or zoom out.

WARNING: Please refer to the "For Your Safety" section on page 104 to learn about information that will help you safely use your phone. Failure to read and follow the important "For Your Safety" information in this phone guide may result in serious bodily injury, death, or property damage.

Overview

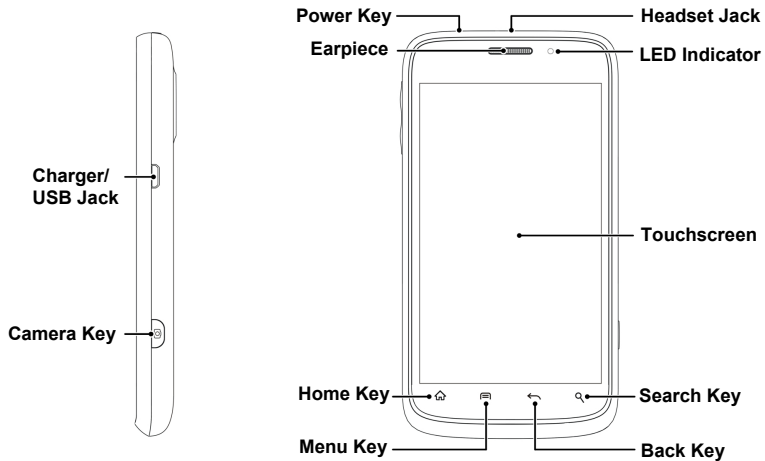

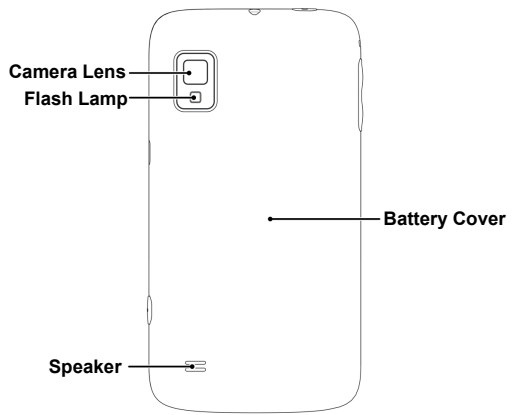
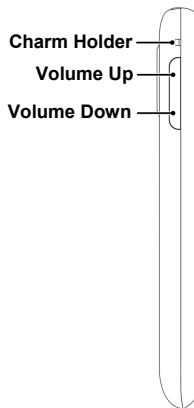

Keys Explained

Key	Function
Power Key	<ul style="list-style-type: none">• Hold to turn on or off Silent or Airplane mode, or to power off.• Press to switch your phone to Sleep Mode.• Press to wake up your phone.
Home Key	<ul style="list-style-type: none">• Press to return to the Home Screen from any application or screen.• Hold to see recently used applications.
Menu Key	Press to get the options on the current screen.
Back Key	Press to go to the previous screen.
Search Key	Press to open the Google Search box. You can use it to search both on the phone and online.
Camera Key	Hold to activate the camera and press to take pictures and videos.
Volume Keys	Press or hold to turn the volume up or down.

Starting Up

Installing the microSD Card and Battery

Switch off your phone before installing or replacing the battery or microSD card.

1. Remove the back cover.

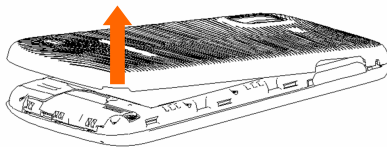

2. Insert the microSD card into the card slot carefully with the metal contacts facing downwards.

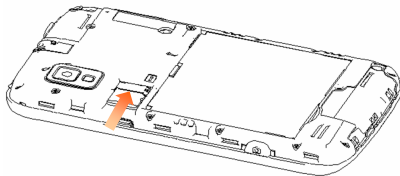

NOTE: microSD logo  is a trade mark of the SD Card Association.

3. Insert the battery by aligning the gold contacts on the battery with the gold contacts in the battery compartment. Gently push down on the battery until it clicks into place.

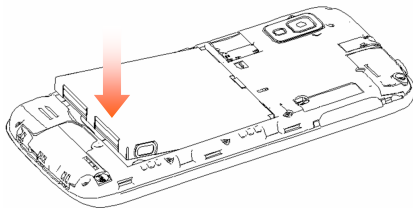

WARNING: Do not handle a damaged or leaking Li-Ion battery as you can be burned.

4. Press the cover gently back into place until you hear a click.

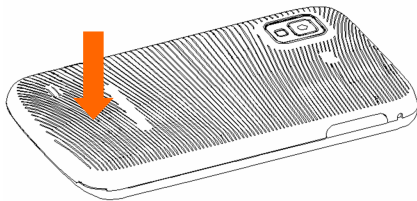

Removing the Battery and microSD Card

1. Make sure that your mobile phone is turned off.
2. Remove the back cover.
3. Lift the battery up and out.

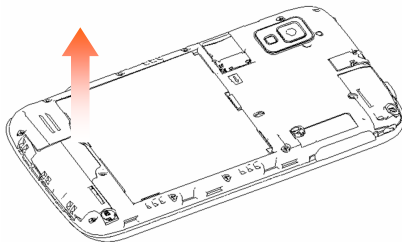

4. Slide the microSD card out gently and remove it.

Charging the Battery

When you first get your new phone you'll need to charge the battery like this:

NOTE: Although the battery comes partially charged, it is recommended you fully charge the battery before using your device for the first time.

1. Connect the adapter to the charger jack. Ensure that the adapter is inserted with the correct orientation. Do not force the connector into the charger jack.

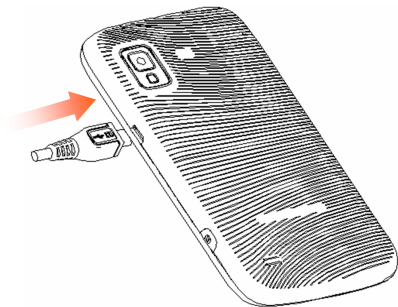



2. Connect the charger to a standard AC wall outlet.
3. Disconnect the charger when the battery is fully charged.

WARNING: Use only ZTE-approved batteries and chargers with your device. The failure to use a ZTE-approved battery and charger may increase the risk that your device will overheat, catch fire or explode, resulting in serious bodily injury, death or property damage.

How much charge have you got?

If the battery is low, there will be a pop-up message on the screen and the LED indicator will be red. As you charge your phone, the screen will tell you the exact battery level each time you wake up your phone.

If the phone is on, you'll see this charging icon  /  appear on the status bar. As soon as charging is completed, this icon  appears on the status bar.

Extending the Battery Life

Active applications, screen brightness levels, Bluetooth and Wi-Fi usage and GPS functionality can drain your battery. You can follow the helpful tips below to conserve your battery power:

- Reduce the screen backlight time.
- Lower the screen brightness.
- Turn Bluetooth off when not in use.
- Turn Wi-Fi off when not in use.
- Disable the GPS function when not in use. Most applications using this function will periodically query the GPS satellites for your current location; each query drains your battery.
- When taking pictures, do not use a flash unless you have to.

Switching Your Phone On/Off

1. Make sure the battery is charged.
2. Hold the **Power Key** to switch on your phone. If your phone is activated, it will search for Boost service and enter the standby mode.
3. To switch it off, hold the **Power Key** to get the phone options. Select **Power off**, and then tap **OK**.

Activating Your Phone

To activate your new phone, please refer to the “Activation Kit” documentation included in your original device packaging.

For additional support information visit us at:

www.boostmobile.com

– or –

Call Boost Customer Care at 1-888-BOOST-4U (1-888-266-7848).

Menu Outline

Menu Key > Add

1. Shortcuts
2. Widgets
3. Folders
4. Wallpapers

Menu Key > Wallpaper

1. Gallery
2. ID wallpapers
3. Live wallpapers
4. Wallpapers

Menu Key > Switch ID

Menu Key > Search

Menu Key > More > Manage apps

Menu Key > More > Notifications

Menu Key > Settings > Wireless & networks

1. Airplane mode (On/Off)
2. Wi-Fi (On/Off)
3. Wi-Fi settings
4. Bluetooth (On/Off)
5. Bluetooth settings
6. VPN settings
7. Mobile networks

Menu Key > Settings > Call settings

1. Voicemail service

2. Voicemail settings
3. TTY mode
4. Hearing aids (On/Off)
5. DTMF Tones
6. Speed dial
7. Plus Code Dialing Setting
8. Call forwarding
9. Voice Privacy (On/Off)
10. Accounts
11. Use Internet calling

Menu Key > Settings > Sound

1. Silent mode (On/Off)
2. Vibrate
3. Volume
4. Phone ringtone
5. Notification ringtone
6. Audible touch tones (On/Off)
7. Audible selection (On/Off)
8. Screen lock sounds (On/Off)
9. Haptic feedback (On/Off)

Menu Key > Settings > Display

1. Brightness
2. Auto-rotate screen (On/Off)
3. Animation
4. Screen timeout
5. Notification blink
6. Calibration

Menu Key > Settings > Location & security

1. Use wireless networks (On/Off)
2. Use GPS satellites (On/Off)
3. Set up screen lock
4. Visible passwords (On/Off)
5. Select device administrators
6. Use secure credentials (On/Off)
7. Install from SD card
8. Set password
9. Clear storage

Menu Key > Settings > Applications

1. Unknown sources (On/Off)
2. Manage applications
3. Running services
4. Storage use

5. Battery use

6. Development

Menu Key > Settings > Accounts & sync

1. Background data (On/Off)

2. Auto-sync (On/Off)

Menu Key > Settings > Privacy

1. Back up my data (On/Off)

2. Automatic restore (On/Off)

3. Factory data reset

Menu Key > Settings > Storage

1. Total space

2. Available space

3. Mount/Unmount SD card

4. Erase SD card

5. Available space (Internal storage)

Menu Key > Settings > Language & keyboard

1. Select language

2. XT9 Text Input

3. Android keyboard

Menu Key > Settings > Voice input & output

1. Voice recognizer settings

2. Text-to-speech settings

Menu Key > Settings > Accessibility

1. Accessibility (On/Off)

2. Power button ends call (On/Off)

Menu Key > Settings > Date & time

1. Automatic

2. Set date

3. Select time zone

4. Set time

5. Use 24-hour format (On/Off)

6. Select date format

Menu Key > Settings > Activation

Menu Key > Settings > About phone

1. System updates

2. Status

3. Battery use

4. Legal information

5. Model number

6. Android version

7. Baseband version

8. Kernel version

9. Build number

10. Hardware Verison

WARNING: Please note that a touchscreen responds best to a light touch from the pad of your finger. Using excessive force or a metallic object when pressing on the touchscreen may damage the tempered glass surface and void the warranty. See “Consumer Limited Warranty” on page 117.

Switching to Sleep Mode

To save battery power, Sleep Mode suspends your device to a low-power-consumption state while the display is off. Your device also goes into Sleep Mode by itself when the display is automatically turned off after a certain period of time, which you can set in **Settings > Display > Screen timeout**.

Press the **Power Key** to switch to Sleep Mode.

Waking Up Your Phone

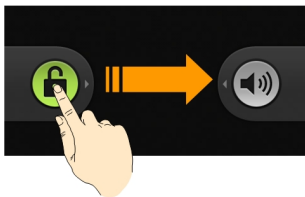

1. Press the **Power Key** to activate your screen display.
2. Drag the  icon to the right to unlock the screen.



NOTE: If you have set up screen lock (see page 90), you need to draw an unlock pattern, or enter a PIN or password to unlock your screen.

Setting Up Your Voicemail

Your device automatically transfers all unanswered calls to your voicemail, even if your device is in use or turned off. You should set up your voicemail and personal greeting as soon as your device is activated. Always use a password to protect against unauthorized access.

1. Tap **Home Key** >  to open the dialer.
2. Hold  to dial the voicemail number.
3. Follow the system prompts to create your password, record your name announcement and greeting.

You can also tap **Home Key** >  > **Voicemail** to dial the voicemail number.

NOTE: It is strongly recommended that you create a password when setting up your voicemail to protect against unauthorized access. Without a password, anyone who has access to your phone is able to access your voicemail messages.

Getting Around Your Phone

Touch Control

You can use finger gestures to control your phone. The controls on your touchscreen change dynamically depending on the tasks you're performing.

- Tap the buttons, icons, or applications to select items or to open applications.
- Hold your finger on an item to see the available options.
- Flick the screen to scroll up, down, left or right.
- Point, drag and drop to move particular items across the screen.
- Pinch with two fingers to zoom in/out an image or a webpage.

NOTE: You can view the phone screen in portrait or landscape simply by holding it upright or turning it on its side. Not all screens are viewable in landscape.

Home Screen

You can choose what is shown on your Home Screen. Just add or remove shortcuts, widgets or folders to make it your own.



Choosing Your Wallpaper

1. Tap **Home Key** to return to the Home Screen.
2. Tap **Menu Key** and select **Wallpaper**.
3. Select the wallpaper you want to use from **Gallery, ID wallpapers, Live wallpapers, or Wallpapers**.
4. Tap **Save** or **Set wallpaper**.

Adding Items to Your Home Screen

1. Tap **Home Key** to return to the Home Screen.
2. Slide left or right to find an extended Home Screen where there is space to add an item.
3. Tap **Menu Key** and select **Add**.

You can also tap and hold the blank area of the Home Screen to get the **Add to Home screen** menu.

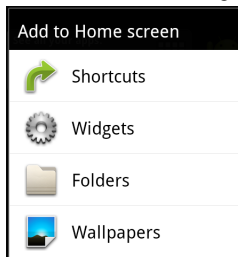



4. Select an item type and the item you want to add to the Home Screen.

Adding a Shortcut from the Applications List

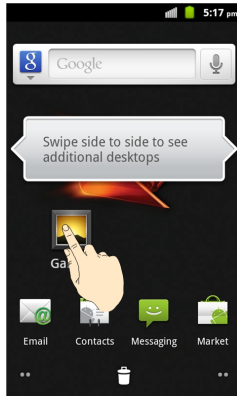
1. Tap  on the Home Screen to open the applications list.
2. Scroll through the list and select your desired application.
3. Tap and hold the application icon. This creates a shortcut of the selected icon and closes the applications list.
4. Hold the shortcut icon and choose a position on the Home Screen. Once complete, release it on the screen.

































Removing Items from Your Home Screen









1. Tap **Home Key** to return to the Home Screen.
2. Tap and hold the item you want to delete until the  icon appears on the screen.
3. Drag the item to .



NOTE: This action does not delete the application or widget, just removes it from the current screen.

Status and Notification Icons

	1x Data connected		No signal
	1x Data service in use		Signal strength
	3G connected		Airplane mode
	3G in use		Ringer off
	Battery very low		Vibrate mode
	Battery low		Phone microphone off
	Battery partially drained		Speaker on
	Battery full		USB connected
	Battery charging		GPS on
	New SMS/MMS		Connected to a Wi-Fi network
	New Email		Bluetooth on
	New Gmail message		Alarm set
	New Google Talk instant message		Wired headset inserted
	Problem with SMS/MMS delivery		Song is playing
	Recording phone call		Downloading data

	Missed call		Sending data
	Call in progress		microSD card unmounted
	More (not displayed) notifications		microSD card removed
	Syncing		TTY mode on

Using the Notification Panel

Flick the status bar downwards to open the Notification Panel, where you can see your calendar events, new messages, and call status, etc. From here you can also open messages, reminders, etc.

TIPS: You can also open the Notification Panel from the Home Screen by tapping **Menu Key > More > Notifications**.

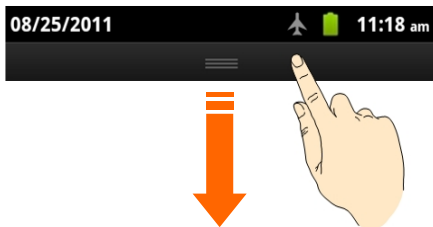

Changing the Screen Orientation

Your phone is capable of automatically changing the orientation of some onscreen content. The onscreen content (images, video, web pages) can be properly displayed basing on the current orientation (this feature may not be available for all applications).



To enable/disable the auto-rotate feature:

1. Tap **Home Key > Menu Key > Settings > Display**.
2. Tick the **Auto-rotate screen** box to enable the auto-rotate feature, or clear it to disable automatic orientation adjustment.

Settings Preview

To change or view your phone's settings, tap **Home Key** >  > **Settings**.

Or from the Home Screen tap **Menu Key** > **Settings**.

Wireless & networks	Configure and manage wireless connections, such as Wi-Fi, Bluetooth [®] , mobile networks and Virtual Private Networks. You can also select Airplane mode from here.
Call settings	Set up voicemail, TTY mode, hearing aids, DTMF tones, speed dial, plus code dialing, call forwarding, voice privacy, and Internet calling.
Sound	Set sound settings.
Display	Set display settings.
Location & security	Create your screen unlock pattern, PIN or password, manage the phone's credential storage or select device administrators. You can also select the sources to use when determining locations from My Location .
Applications	Manage your applications and installation of new ones.
Accounts & sync	Manage your accounts and configure synchronization settings.
Privacy	Configure privacy settings, such as back-up settings and personal data.
Storage	Check the storage information of the microSD card and phone.



Language & keyboard	Set the system language and region, plus text input options.
Voice input & output	Set up voice recognition and text-to-speech options.
Accessibility	Set accessibility options after you have installed accessibility related applications.
Date & time	View date and time, and set the date/time format.
Activation	Activate your phone.
About phone	View phone status, battery use, legal information, etc. You can also check for system updates.

Phone Calls

Making Calls

There are many ways to make a call with your phone. And they're all easy to do.

Calling from the Dialer

1. Tap **Home Key** >  > **Dialer** or tap  on the Home Screen.
2. Enter the phone number you want to call.

If you make a mistake, tap  to erase a wrong entry, or hold this key to clear all digits.

3. Tap .

Calling from Your Contacts

1. Tap **Home Key** >  > **Contacts**.
2. Slide your finger to scroll the contacts list and tap the contact you want to call.



TIPS: You can search for a contact by tapping **Menu Key** > **Search**.

3. Tap .

Calling from Your Call Log

1. Open the call log in one of the following ways.



- Tap **Home Key** >  > **Call log**.

- Tap **Home Key** >  > **Dialer** > **Call log**.
- Tap **Home Key** >  > **Contacts** > **Call log**.

2. Tap  next to the number you want to call.

Calling from a Text Message

If a text message contains a phone number that you want to call, you can make the call while viewing the text message.

1. Tap **Home Key** >  > **Messaging** and tap the message that contains the phone number you want to call.
2. Tap the number.
3. Select a number and tap .

Using Speed Dial

Press and hold 1 ~ 9 key from the dialer to call the corresponding speed dial number.

The number key 1 is reserved to speed dial your voicemail.

Assigning a speed dial key:

1. Tap **Menu Key** > **Settings** > **Call settings** > **Speed dial** from the Home Screen.
2. Tap a speed dial key.
3. Enter a phone number or tap  to select one from the contact list.
4. Tap **OK**.

Making Emergency Calls

1. Enter 911 from the dialer.
2. Tap .

NOTE: When you make an emergency call, your phone automatically enters Emergency mode.

To exit Emergency mode:

1. Tap **End** to end a 911 call.

NOTE: When you end the 911 call, you are returned to the Emergency Callback mode.

2. Flick down the notification panel and tap **Emergency Callback mode**, and then tap **Yes**.

Emergency Callback mode:

Emergency Callback mode enables the operator to call you back or determine your approximate location. In Emergency Callback mode, you cannot send and receive messages or browse web pages.

Emergency Callback mode is active for five minutes or is cancelled when you make a non-emergency call.

Enhanced 911 (E911) Information

Your phone features an embedded Global Positioning System (GPS) chip necessary for utilizing E911 emergency location services where available. When you make an emergency 911 call, the GPS feature of your phone seeks information to calculate your approximate location.

NOTE: Depending on several variables, including availability and access to satellite signals, it may take up to 30 seconds or more to determine and report your approximate location.

IMPORTANT: Always report your location to the 911 operator when placing an emergency call. Some designated emergency call takers, known as Public Safety Answering Points (PSAPs) may not be equipped to receive GPS location information from your phone.

Making International Calls (Plus Code Dialing)

When making international calls, Plus Code Dialing automatically enters the international access code for your location (for example, 011 for international calls made from the U.S.). (See “Plus Code Dialing Setting” on page 83.)



1. Hold  from the dialer to enter ‘+’.
2. Enter the full phone number.

For example: +49-123-12345678 in the following format: + country code / area code / phone number.

3. Tap . The device automatically prepends the access code for international dialing, followed by the country code and phone number.

Making a 3-Way Call

Your phone has a 3-way calling feature, which enables you to have conference calls with two parties. When using this feature, the normal airtime rates will be charged for each of the two calls.

1. Tap **Home Key** >  > **Dialer** to open the dialer.
2. Make the call to the first recipient.
3. Once you have established the connection, tap **Add call**.
4. Enter the second phone number you wish to call and tap .
5. When you're connected to the second party, tap **Merge calls** on the screen to begin your 3-way call.

If one of the people you called hangs up during your call, you and the remaining caller stay connected. If you initiated the call and are the first to hang up, all three callers are disconnected.

Dialing Options

Open the dialer to enter a phone number and press **Menu Key** to see the additional options.

- **Add to contacts:** Add the current number to a new or existing contact.
- **Send Message:** Compose and send a message to the current number.
- **Call settings:** Open the call settings menu.

Receiving Calls

Answering a Call

Drag  to the right to answer the call.

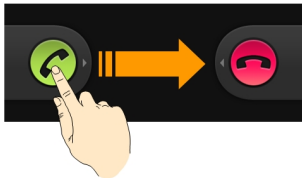

Rejecting a Call

Drag  to the left to reject the call.

TIP: To silence the ringer of the incoming call, press **Volume Keys** either up or down.

In-Call Options

Muting a Call

During a call, you can mute your microphone so that the person you are speaking to cannot hear you, but you can still hear them:

Tap **Mute** to turn your microphone off. The mute icon  will appear on the screen. To turn your microphone back on, tap **Mute** again.

Turning the Speaker On/Off

Tap **Speaker** during a call to turn the speaker on. This icon  will appear in the status bar. Tap **Speaker** again to turn it off.

Putting a Call on Hold

During a call, you can put it on hold by tapping **Menu Key > Flash calls** on the screen. Tap **Menu Key > Flash calls** again to unhold the call.

Adding a Call

During a call, tap **Add call** to make another call.

Using the Dialpad

During a call, tap **Dialpad** to open the onscreen dialpad and enter additional numbers, for example, an extension or access code. Tap **Hide** to close the dialpad.

Using Bluetooth Headset

During a call, tap **Bluetooth** to route the phone's audio through a connected Bluetooth headset.

Ending a Call





Just tap **End** to finish a call.

Contacts

You can add new contacts on your phone and synchronize them with the contacts in your Google account or other accounts that support contact syncing.

To access your contacts, tap **Home Key** >  > **Contacts**. In the Contacts Screen, you can tap the tabs on the top to quickly switch to the dialer, call log, favorite contacts, or contact groups.

Creating a Contact

1. Tap **Menu Key** > **New contact** from the Contacts Screen.
Shortcut: Enter a phone number in the dialer and tap **Menu Key** > **Add to contacts** > **Create new contact**.
2. Tap the **First name** and **Last name** field to enter the contact name.
3. Tap **Groups** to create a new group or select an existing group for the new contact.
4. Tap the **Phone** number field to enter a phone number. You can tap  to enter additional phone numbers, or tap  to remove a phone number.
5. Tap the label on the left of the Phone field to select a category.
6. Enter additional information of the new contact: **Email**, **Postal address**, **Organization**, or **More** (IM, Notes, Nickname, Website, Internet call, Birthday, or Birthday reminder). Tap  to enter additional information, or tap  to remove an entry.
7. Tap **Done** to save the contact.

Contacts Menu Options

1. Tap **Home Key** >  > **Contacts**.
2. Tap and hold a contact and select from its available contact options:
 - **View contact:** View detailed information of the contact.
 - **Call contact:** Call the contact's available number.
 - **Text contact:** Send a text message to the contact.
 - **Add to favorites:** Add the contact to the Favorites tab.
 - **Remove from favorites:** Delete the contact from the Favorites tab.
 - **Add to group:** Add the contact into a contact group.
 - **Edit contact:** Edit the contact information.
 - **Delete contact:** Erase the current contact.

Contacts Entry Options

1. Tap **Home Key** >  > **Contacts**.
2. Tap a contact and then tap **Menu Key** to display the available options for the current contact:
 - **Edit contact:** Edit the contact information.
 - **Share:** Send the contact via Bluetooth, Email or Gmail.
 - **Options:** Tap **Ringtone** to assign a custom ringtone for this contact. Tick the **Incoming calls** box to make the calls from this contact automatically sent to voicemail.
 - **Delete contact:** Erase the current contact.

Adding a Number to a Contact

1. Tap a contact in the Contact screen, then tap **Menu Key > Edit contact**.
2. From the phone numbers area, tap  to create a new phone number field.
3. Tap the phone number field and enter the new number.
4. Tap the label on the left of the Phone field to select a category.
5. Tap **Done** to save the new number into the contact.

Importing and Exporting Contacts

You can import/export contacts from/to your microSD card. This is especially useful when you need to transfer contacts between different devices.

1. Tap **Menu Key > More > Import/Export** from the Contacts Screen.
2. Choose **Import from SD card** or **Export to SD card** to import or export contacts.
 - For import, you should have vCard files saved in the microSD card. If there's more than one vCard file, you need to select the vCard file and tap **OK**.
 - For export, the phone will prompt you with the name of the vCard file. Tap **OK** to create the file in the microSD card.

Entering Text

When you enter a field that needs text or numbers, a keypad automatically appears on the screen. Hold the input box and select **Input method** from the pop-up menu to change input method.

TIPS: You can hide the keypad by holding **Menu Key** or pressing **Back Key**.









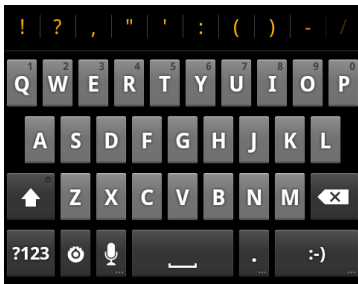

Android Keypad

The Android Keypad provides a layout similar to a desktop computer keyboard. Turn the phone sideways and the keypad will change from portrait to landscape.

To use the landscape keypad, just tick the **Auto-rotate screen** check box in **Settings > Display**. (The landscape QWERTY keypad is not supported in all applications.)

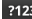
TIPS: Hold the input box and select **Input method** from the pop-up menu to change input method.

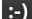

- Tap the alphabetic keys to enter letters. Tap and hold some specific keys to enter associated accented letters or numbers. For example, to enter È, tap and hold  and the available accented letters and number 3 appear. Then slide to choose È.
- Tap  to use uppercase or lowercase. This key also indicates the current case:  for lowercase,  for uppercase, and  when locked in uppercase.
- Tap  to delete the text before the cursor.
- Tap  to select numbers and symbols. You can then tap  to find more. Also, the often used symbols are displayed on top of the keypad. Flick left or right to find the one you need and tap to enter.
- Tap  to enter a smiley face; hold the key to choose more emoticons.
- Tap  and choose to select the input method or set up the Android keypad.
- Tap  to use Google's networked voice input.

To use the Google voice input:

1. Tap  to activate the Google voice input.
2. Speak clearly into the microphone. When complete, your spoken words are recognized, converted to text and inserted into the current cursor position.

XT9 Text Input

XT9 Text Input can speed up text input by replacing the letter tapping/typing motion of input with a tracing gesture where you move your finger from letter to letter without lifting the finger until you reach the end of the word.

You can select to use one of the three layouts (Keyboard, Reduced keyboard, Phone keypad) of XT9 Text Input Keyboard.

- Keyboard

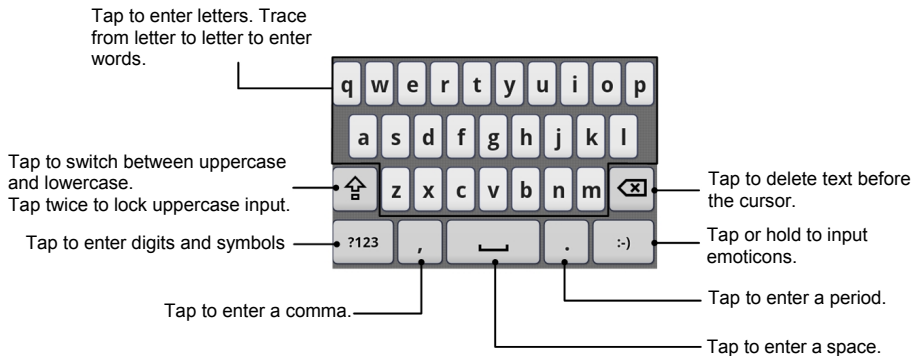



Move your finger from letter to letter to trace a word without lifting the finger until you reach the end of the word. The trace feature is also available in the Reduced keyboard layout and Phone keypad layout.

- Phone keypad

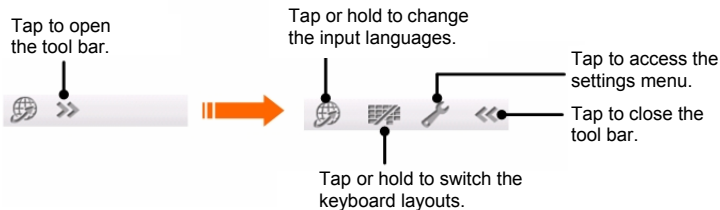

- Using the tool bar



NOTE: The  icon is available when more than one language is activated. You can select more input languages by tapping **Menu Key > Settings > Language & keyboard > XT9 Text Input > Languages and settings** from the Home Screen.

- Tips for using XT9 Text Input
 - Ignore double letters – XT9 Text Input will figure those out for you automatically.
 - Tap when you want to. If you want to enter a single letter, go ahead and tap.
 - Lift your finger at the end of the word. A space is added automatically when you begin to trace the next word.

Messaging

The text messaging (SMS) and multimedia messaging (MMS) are available in **Messaging**.

From **Messaging**, you can send or receive an SMS or MMS. When you receive a new message, you can open it from the Notification Panel, or from the Messaging Screen. Simply tap on the new message to read it.

When a message is received, this icon  appears in the status bar.

Sending a Text Message

1. Tap **Home Key** >  > **Messaging**.
2. Tap **New message**.
3. Tap the **To** field and enter the recipient's name or number. As you type, matching contacts will appear. Tap a suggested contact to add as a recipient.
4. Tap **Type to compose** and type your message. You can also tap **Menu Key** to insert signature, quick text, smiley or contact in text format.
5. Tap **Send** to send your text.

Sending an MMS Message

You can send multimedia messages (MMS), which can contain text, images, videos, audio, or picture slideshow.

1. Tap **Home Key** >  > **Messaging**.
2. Tap **New message**.
3. Tap the **To** field and enter the recipient's name or number. As you type, matching contacts will appear. Tap a suggested contact to add as a recipient.

4. Tap **Menu Key > Add subject** to enter the subject of your MMS.
5. Tap **Type to compose** and type your message.
6. Tap **Menu Key > Attach** if you want to add an attachment to your MMS.
 - **Pictures:** Select a picture from the Gallery to add to your MMS.
 - **Capture picture:** Open the camera and take a photo to attach to your MMS.
 - **Videos:** Select a video clip from the Gallery to attach to your MMS.
 - **Capture video:** Open the Camcorder and shoot a video clip to attach to your MMS.
 - **Audio:** Select an audio file to attach to your MMS.
 - **Record audio:** Open the Sound Recorder and record an audio file to attach to your MMS.
 - **Slideshow:** Open the **Edit slideshow** menu.
 - Tap **Add slide** to create a new slide.
 - Tap the slide you created to open the slide composing screen. You can enter text in the text field, or tap **Menu Key** to add a picture, an audio file, or a video to the slide. You can also take a picture, or record an audio or a video clip, or add a new slide.
 - In the composing screen, tap **Menu Key > More > Duration** to adjust display time for the slide; tap **Menu Key > More > Layout** to select text position in the slide.
 - When you finish with the slide, tap **Back Key** to return to the **Edit slideshow** menu. Or tap **Done** to attach the slideshow to the message.
7. When you've finished, tap **Send**.

NOTE: Add an attachment to text message and it will be converted into an MMS automatically. Likewise if you remove all attachments from an MMS, it'll automatically become a text message.

Managing Messages and Their ‘Threads’

Text and MMS messages sent to and received from the same contact (or number) are grouped into a message thread in your Messaging Screen. You can tap a message thread and see the ‘conversation’ you’ve had with someone – like a chat program. These message threads are arranged according to when you received them, with the latest one on top.

Replying to a Message

1. Tap the message thread you want to reply to from the Messaging Screen.
2. Tap **Type to compose** and type your message.
3. Tap **Send**.

Deleting a Message Thread

1. Tap and hold a message thread from the Messaging Screen.
2. Tap **Delete thread** from the pop-up menu.
3. Tap **Delete** to confirm.

You can also delete a thread by opening it from the Messaging Screen and tapping **Menu Key > Delete thread**.

Message Settings

To configure your message settings, tap **Menu Key > Settings** from the Messaging Screen.

Storage settings:

- **Delete old messages:** Select to delete old messages when your storage limits are reached.
- **Text message limit:** Set the maximum number of text messages allowed in a single thread.

- **Multimedia message limit:** Set the maximum number of multimedia messages allowed in a single thread.

Text message (SMS) settings:

- **SMS priority:** Set the priority of outgoing text messages.

Multimedia message (MMS) settings:

- **Auto-retrieve:** Automatically retrieve MMS messages.

Notification settings:

- **Notifications:** Show message notifications in the status bar.
- **Select ringtone:** Choose a ringtone for your incoming messages.
- **Vibrate:** Make your phone vibrate when a new message arrives.

Signature settings:

- **Edit signature:** Edit your signature, which can be added automatically to outgoing messages.
- **Add signature:** Add the signature to all outgoing messages.

NOTE: Tap **Menu Key > Restore default settings** to reset all the message settings to default.

Email

Tap **Home Key** >  > **Email**. You can enter the Email Screen to setup your email account and exchange emails.

Creating an Email Account

1. When you open **Email** for the first time, enter your email address and password. Then tap **Next**.
2. Select the type of your account (POP3 or IMAP), edit the incoming server settings, and then tap **Next** or **Next [Check]**.

After you tap **Next [Check]**, your phone will check the incoming server settings. If you are notified that the setup could not be finished, you'll need to correct some settings to finish it. If there is any problem, please contact your mobile service provider and email service provider.

3. Edit the outgoing server settings and tap **Next** or **Next [Check]**.

After you tap **Next [Check]**, your phone will check the outgoing server settings.

NOTE: Your device 'knows' the client settings for lots of email service providers. If the email service you use is from those providers, the phone will automatically configure the incoming and outgoing settings after you enter your email account and password.

4. Set the email checking frequency, download options, account name and the name displayed on outgoing messages. Tap **Done** when you finish.

Setting Up a Microsoft Exchange Email

You can use the Email application to access to your Outlook Exchange server via your phone.

1. When you open **Email** for the first time, enter your email address (your Outlook work email address) and password. Then tap **Next**.
2. Select **Exchange** as the type of your account and then tap **Next**.
3. Enter a Domain\Username, password and Exchange Server information, set SSL options, then tap **Next**.
4. Once the account is activated, configure the account settings (Email check frequency, Amount to synchronize) and other account options, then tap **Next**.
5. Give a name for this new account (optional) and tap **Done**.

NOTE: You can set up multiple Microsoft Exchange email accounts on your phone.

Opening Email

1. Tap **Home Key** >  > **Email**.
2. Tap **Menu Key** > **More** > **Accounts** and select the email account you want.
3. Tap an email message from the Inbox screen.

NOTE: Tap **Menu Key** > **Refresh** to refresh the inbox. You can tap **Load more messages** at the bottom of the email list to download earlier messages.

Composing Email

After creating your email account, you're ready to compose and send emails.

1. Tap **Home Key** >  > **Email**.
2. Tap **Menu Key** > **More** > **Accounts** and select the email account you want.
3. Tap **Menu Key** > **Compose**.

4. Tap the **To** field and enter the recipient's email address. Separate each recipient with a comma.
When you enter the email address, the matching addresses saved in your Contacts will be displayed. You can tap the recipient from the list.
NOTE: Tap **Menu Key > Add Cc/Bcc** to send a carbon copy or blind carbon copy to other recipients.
5. Tap the **Subject** field to enter the subject. If necessary, tap **Priority** to change the email priority.
6. Tap the **Compose Mail** field to compose the email content.
7. Tap **Menu Key > Add attachment** to add files to the email.
8. Once complete, tap **Send**.
 - Tap **Save as draft** to save the email as a draft. To view the drafts, tap **Menu Key > Folders > Drafts** from the inbox.
 - Tap **Delete** to erase the current message.

Getting Connected to the Internet

The impressive networking capabilities of your phone allow you to access the Internet or a corporate network (intranet) with ease.

You can use default connection settings to connect to the web via your mobile network (CDMA/EvDo), or Wi-Fi.

Enabling Data Access Over CDMA/EvDo

The CDMA/EvDo data connection can be enabled manually. Just tap **Home Key** >  > **Settings** > **Wireless & networks** > **Mobile networks** and tick the **Data enabled** check box.

Turning on Wi-Fi

Wi-Fi provides wireless Internet access over distances of up to 300 feet (about 100 meters).

1. Tap **Home Key** >  > **Settings** > **Wireless & networks**.
2. Tick the **Wi-Fi** box to turn it on.

To turn Wi-Fi off, just clear the **Wi-Fi** box.

NOTE: Use of wireless data connections such as Wi-Fi and Bluetooth can cause an added drain to your battery and reduce your use times.

Connecting to a Wi-Fi Network

1. Tap **Home Key** >  > **Settings** > **Wireless & networks** > **Wi-Fi settings**.

The Wi-Fi network names and security settings (open or secured) that your phone has detected are shown in **Wi-Fi networks** section.

2. Tap a network to connect to it. If the network is secured, you need to enter a password.

TIPS: Tap **Menu Key > Scan** in **Wi-Fi settings** to scan for a Wi-Fi network manually.

Adding a Wi-Fi Network

You can also add a new Wi-Fi connection manually.

1. Tap **Home Key >  > Settings > Wireless & networks > Wi-Fi settings > Add Wi-Fi network.**
2. Enter the **Network SSID**, which is the name of your Wi-Fi network, and tap the **Security** field to select a security option.

NOTE: The security option must match the current security setting of your target network. If the network is secured, you need to enter the password.

3. Tap **Save** to store and connect to the network.

NOTE: The next time your phone connects to a previously accessed or secured wireless network, you are not prompted to enter the wireless password again, unless you reset your phone back to its factory default settings.

Checking the Wi-Fi Network Status

You can view the Wi-Fi network status by checking the  icon in the status bar. Or tap the Wi-Fi network that the phone is currently connected to in **Wi-Fi settings**. You can then check the network status from the pop-up window.

Using Airplane Mode

Airplane mode allows you to use many of your phone's features when you are in an airplane or another area where making or receiving calls or using a data feature is prohibited. When your phone is in Airplane Mode, it cannot send or receive any calls or access online information or applications.



1. Tap **Home Key** >  > **Settings** > **Wireless & networks**.
2. Tick the **Airplane mode** box to enable Airplane Mode.

NOTE: You can also press and hold **Power Key** to open the phone options menu, then tap **Airplane mode**.

Browsing the Internet

You can use your phone to browse the Internet via a CDMA/EvDo, or Wi-Fi connection. Tap **Home Key** >  > **Browser**.

There are different ways to open web pages.

- Tap the address bar to enter the website you want to browse. Then tap **Go**.
- Tap  beside the address bar or tap **Menu Key** > **Bookmarks**. Select a bookmark to open.
- Tap  beside the address bar or tap **Menu Key** > **Bookmarks**. Choose an item from the **Most visited** tab or **History** tab.

Downloading Links from the Web

If a web page has a link you'd like to download, just hold on the link and select **Save link**. Your phone will start to download the link and save it to your microSD card.

You can check the downloading progress by tapping **Menu Key** > **More** > **Downloads**.

Using Bookmarks

Adding a Bookmark

1. Open a desired web page and tap  or **Menu Key** > **Bookmarks**.
2. Tap **Add** or **Add bookmark**.
3. Give the bookmark a name and tap **OK**.

TIPS: To change how you view bookmarks on your phone screen, tap **Menu Key > List view/Thumbnail view**.

Editing a Bookmark

1. Open a browser window and tap  or **Menu Key > Bookmarks**.
2. Select the bookmark you want to edit by holding on it until the shortcut menu pops up and select **Edit bookmark**.
3. Edit the name or location, and then tap **OK** to save.

Deleting a Bookmark

1. Open a browser window and tap  or **Menu Key > Bookmarks**.
2. Select the bookmark you want to get rid of by holding on it until the shortcut menu pops up.
3. Select **Delete bookmark** and tap **OK** to confirm.

Adding Bookmarks to Your Home Screen

1. Open a browser window and tap  or **Menu Key > Bookmarks**.
2. Select a bookmark by holding on it until the shortcut menu pops up.
3. Tap **Add shortcut to Home** to add the selected bookmark on your Home Screen.

Creating a New Home Page

1. Open a browser window and tap  or **Menu Key > Bookmarks**.
2. Tap **Bookmarks, Most visited** or **History** tab.
3. Tap and hold an entry until the shortcut menu pops up.
4. Tap **Set as homepage** to assign the selected entry as your new home page.

Bluetooth®

Bluetooth® is a short-range wireless communication technology. Phones or other devices with Bluetooth capabilities can exchange information wirelessly within a distance of about 10 meters. The Bluetooth devices must be paired before the communication is performed.

Turning Bluetooth On/Off

Tap **Home Key** >  > **Settings** > **Wireless & networks** and tick the **Bluetooth** check box. When Bluetooth is on, the  icon will appear in the status bar.

If you want to turn Bluetooth off, just clear the **Bluetooth** check box.

NOTE: If you switch off your phone while Bluetooth is turned on, when you switch on the phone again, Bluetooth will turn on automatically.

Making Your Phone Visible

In order to work with other phones or devices that have Bluetooth, you need to make your phone 'visible' to them.

1. Tap **Home Key** >  > **Settings** > **Wireless & networks** > **Bluetooth settings**.
2. Tick the **Bluetooth** check box if it isn't already ticked.
3. Tick the **Discoverable** check box to make your device visible for 120 seconds.

To make your phone 'invisible', simply clear the **Discoverable** check box.

Pairing With Another Bluetooth Device

To pair with another Bluetooth device, you need to turn the Bluetooth function of both devices on and make the other Bluetooth device visible.

1. Tap **Home Key** >  > **Settings** > **Wireless & networks** > **Bluetooth settings**.
2. Tap **Scan for devices**. Your phone will show all visible Bluetooth devices (in range) in its **Bluetooth devices** list.
3. Select the device you want to pair with.
4. If required, enter your PIN and tap **OK**.



If a PIN is required, the same PIN should be entered on the other device.

Deleting a Paired Device (Unpair)

1. Tap **Home Key** >  > **Settings** > **Wireless & networks** > **Bluetooth settings**.
2. Tap and hold a paired device in the **Bluetooth devices** list, then tap **Unpair** from the pop-up window.

Making the Most of Multimedia

Taking Pictures With Your Camera

1. Open the camera by holding **Camera Key** or tapping **Home Key** >  > **Camera**.
2. Aim the camera at the subject and then press  or **Camera Key** to take a shot.
3. To view it, just tap the picture in the corner of the screen. Or tap **Menu Key** > **Gallery** to view all your pictures.







NOTE: A microSD card is required in order to use the camera function on your phone. Your phone automatically saves the pictures to the **DCIM** folder on the microSD card.



Adjusting Camera Settings

From the Camera Screen, you can do the following settings:

- Tap  to set up focus mode, exposure, picture size/quality, color effect, ISO, anti-banding, saturation, contrast, sharpness, shutter tones, timing phone or restore the camera settings to default.

NOTE: To use the timing phone feature, the focus mode should be turned off first.

- Tap  or  to choose whether to save photo's geographic location.
- Tap  to change white balance.
- Tap  or  to turn off or on the flash mode. Tap  to enable auto flash mode.
- Press the **Volume Keys** up or down to zoom in or out.

TIPS: To change quickly from camera to camcorder or vice versa, use the switch icon . Use the  bar to adjust the brightness.

 **WARNING:** Keep a safe distance when using the flash. Do not point the flash toward people or animals' eyes.



Shooting Video With Your Camcorder

1. Open the camcorder by tapping **Home Key** >  > **Camcorder**.
2. Press  or **Camera Key** to start shooting, and press  or **Camera Key** to stop.
3. Tap the picture in the corner of the screen to view the video you've just shot. Or tap **Menu Key** > **Gallery** to see all your video clips.

NOTE: A microSD card is required in order to use the video function on your phone. Your phone automatically saves the videos to the **DCIM** folder on the microSD card.

Adjusting Video Settings

From the Camcorder Screen, you can do the following settings:

- Tap  to adjust color effect, video quality, video/audio encoder, video duration, and restore the camcorder settings to default.
- Tap  to change white balance.
- Tap  to change video quality based on the purpose of the video.

NOTE: You can adjust video quality, video/audio encoder and video duration only in custom mode.

Playing Your Music

You can play digital audio files from your phone's memory card in **Music**.

1. Tap **Home Key** >  > **Music** to open the Music Screen.
2. Select **Artists/Albums/Songs/Playlists** to see the songs you want to play.
3. Tap a song from the list to start playing.
4. Adjust the volume with the **Volume Keys**.

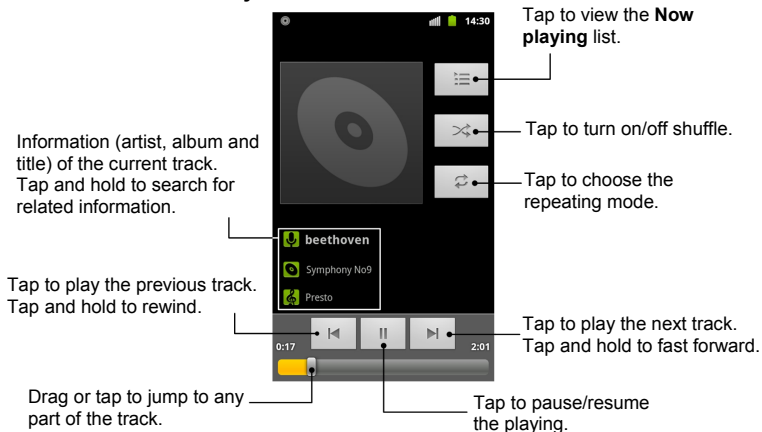

Creating Playlists

Playlists help you organize your music files:

1. Select a music file you want to add to a new playlist.
2. Tap and hold on the file until a shortcut menu pops up.
3. Tap **Add to playlist**.
4. Tap **New**.
5. Enter the playlist name and tap **Save**.

Setting a Song as Ringtone

1. Select **Artists/Albums/Songs/Playlists** to see the songs.
2. Hold on the song until a shortcut menu pops up.
3. Select **Use as phone ringtone**.

TIPS: You can also set a song as ringtone when you are playing it by tapping **Menu Key > Use as ringtone**.

Playing Your Videos

To play a video file, tap **Home Key >  > Videos**. This will open the Videos Screen and show the video files saved in your memory card.

Tap a video file to start playing. Tap on the screen and the control bar will appear as shown below.

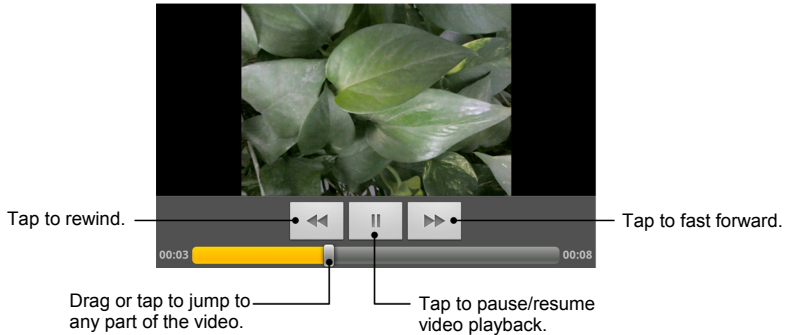

Viewing Your Gallery

Gallery helps you view pictures and play videos. You can also do some basic editing of your pictures – such as setting them as wallpaper or contact icons, or sharing them with friends.

TIPS: When viewing a picture, you can double-tap or pinch on the screen to zoom in/out.

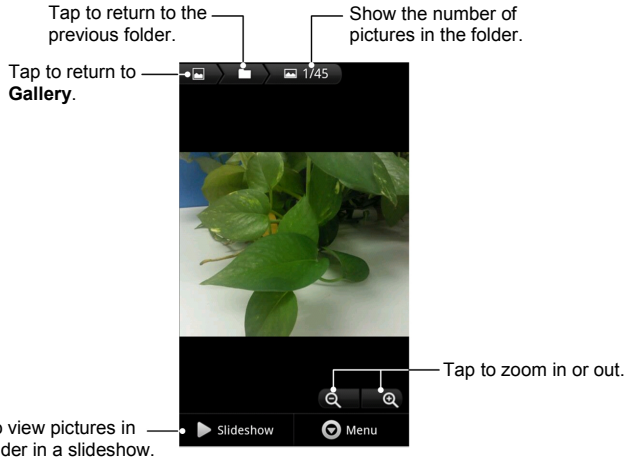

Using Your Google™ Applications

Creating a Google Account

You will need a Google account to access several device features such as Gmail, Google Maps, Google Talk, and the Android Market applications. Before you are able to access Google applications, you must enter your account information. These applications sync between your device and your online Google account.

If you don't have a Google account, you can easily create one from either your phone or a computer.

To create a Google account from your phone:

1. Tap a Google application that needs a Google account, such as **Market**.
2. Read the instructions and tap **Next**.
3. Tap **Create**.
4. Enter your account information and tap **Next**. Then follow the onscreen prompts to finish the setup.

To create a Google account from a computer:

1. From a computer, launch a web browser and open www.google.com.
2. On the main page, click **Sign-In > Sign up for a new Google Account**.
3. Follow the onscreen prompts to create your free account.
4. Find an email from Google, and respond to the new email to activate your new account.

Signing In to Your Google Account

1. Launch an application that requires a Google account (such as Android Market or Gmail).
2. Tap **Next > Sign in**.

3. Tap the **Username** and **Password** fields to enter your account information.
4. Tap **Sign in**. Your phone then communicates with the Google servers to confirm your information.

Android Market

You can download and install a large selection of applications on your phone from the Android Market.

Accessing the Market

1. Tap **Home Key** >  > **Market**.
2. Sign in your Google account if you haven't logged in.
3. Tap **Accept** to agree to the Android Market terms of service.

Installing a Google Application

1. Tap **Home Key** >  > **Market**.
2. Browse through the categories, find an application you're interested in, and tap it.
3. Read the application descriptions and tap **Install** or **Buy**.
4. If prompted, follow the onscreen instructions to pay for the application.
5. Check the download progress by opening the Notifications panel.
6. Wait for the application to be downloaded and installed automatically. You can check the progress in the Notification Panel.

NOTE: After the application is downloaded and installed on your phone, the  icon appears on the status bar.

Launching an Installed Google Application

1. Tap **Home Key** > .
2. Find the newly installed application and tap it.

NOTE: Some applications may request access to your personal data, functions, or significant amounts of data usage times. Use caution when using such applications.

Google Search

Google Search can be used to search for a key term both on the phone and online.

Launching the Google Search Box

You can open the Google Search box as follows:

- Tap **Search Key**.
- Tap **Home Key** >  > **Google Search**.

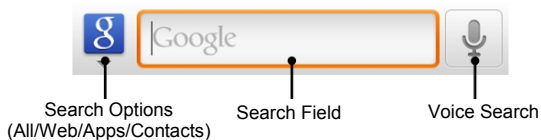

NOTE: In some instances, the **Search Key** opens a search box specific only to the current application.

Using Google Search

1. Tap **Search Key** to launch the Google Search box.
2. Tap  to select a search item and enter your search term.
 - **All:** Search your phone, the Web, and the Android Market for your search term.
 - **Web:** Search for your term only on the Web.
 - **Apps:** Search for your term only within the Android Market.
 - **Contacts:** Search for your term only within your contacts.

NOTE: You can tap  to change the searchable items.
3. Tap a match from the list of suggestions, phone search results, or previously chosen search matches.

To search the phone and Web by entering text:

1. Tap **Search Key** to launch the Google Search box.
2. Use the onscreen keypad to enter your search term.
3. As you type, matching items on your phone or from the Web are listed. Tap a match from the list to open it.

To search the phone and Web via Voice Search:

1. Tap **Search Key** to launch the Google Search box.
2. Tap the  icon on the side of the Google Search box. You will be prompted to set up the voice search the first time you use it.

NOTE: You can also press **Home Key** >  > **Voice Search**.

3. From the open dialog, say what you want to search for.
4. Once complete, the phone will analyze your spoken words and display a list of matching keyword terms.

NOTE: It is recommended that you use this feature in a quiet room.

Gmail

Gmail is Google's web-based email service that's configured automatically when you sign in to your Google account. Depending on your synchronization settings, the Gmail on your phone can be automatically synchronized with your Gmail account on the web.

Opening Gmail

1. Tap **Home Key** >  > **Gmail**.
2. Sign in your Gmail account.
3. Tap a message to view it. You can tap **Menu Key** > **Refresh** to refresh your Gmail messages.

Composing Gmail

This is how you create and send a Gmail:

1. Tap **Home Key** >  > **Gmail**.
2. Tap **Menu Key** > **Compose**.
3. Enter the message recipient's email address in the **To** field. If you're sending the email to several people, separate the email addresses with a comma. You can add as many recipients as you want.

NOTE: Tap **Menu Key** > **Add Cc/Bcc** to send a carbon copy or blind carbon copy to other recipients.

4. Tap the **Subject** field to enter the email subject.
5. Tap the **Compose Mail** field to compose your email.
6. Tap **Menu Key > Attach** to choose a picture from your Gallery and add it to the email. Tap  to remove a selected attachment from the email.
7. To send the email, tap **Menu Key > Send**.
To save the email, tap **Menu Key > Save draft**. You can view the draft later from the Inbox, by tapping **Menu Key > Go to labels > Drafts**.
To delete the email, tap **Menu Key > Discard**.

Google Calendar

Tap **Home Key** >  > **Calendar** to use Google Calendar, Google's time management application. You can use the calendar to schedule appointments, including meetings and other events. Your appointments will be displayed on the screen as scheduled. You can also synchronize appointments to your Google account, which enables you to manage your schedule online on your PC.

Google Maps

Use Google Maps to find your way and get location information right from your phone.

Enabling Location Mode



Before using location-based services, you need to turn on your phone's location mode. See "Location Settings" on page 89.

1. Tap **Home Key** >  > **Settings > Location & security**.

2. Tick **Use GPS satellites** to enable GPS, or tick **Use wireless networks** to use open Wi-Fi and mobile networks to determine location.

NOTE: Enabling GPS will drain your battery faster.

Launching Google Maps

Tap **Home Key** >  > **Maps**. If GPS is enabled as the location mode, the GPS icon  will appear on the Status bar.

Finding Your Location

1. Launch the Google Maps application.
2. Tap  on top of the map area to start locating yourself.



Navigation

Google Maps navigation application uses your current location to provide turn-by-turn guidance to your destination. Before using the application, you need to enable GPS (See “Enabling Location Mode” on page 78).

1. Tap **Home Key** >  > **Navigation**.
2. Read the onscreen disclaimer and tap **Accept** to continue.
3. Choose from the options below:
 - **Speak Destination:** Use voice recognition feature to search for matching places.
 - **Type Destination:** Manually enter the destination address.
 - **Contacts:** Get directions to the address stored in your Contacts.
 - **Starred Places:** Get directions to the places you have starred in Google Maps.

Places

Google Places helps you find all kinds of businesses near you.

1. Tap **Home Key** >  > **Settings** > **Location & security** and tick the **Use GPS satellites** or **Use wireless networks** check box.
2. Tap **Home Key** >  > **Places**. Wait while you are being located. Your location, when found, is shown at the bottom of the screen.
3. Select a business category and the information of that type of business near you will be displayed. You can also use the **Find places** search box on the top to find the business you need.

NOTE: Tap **Add** to add new business categories.

4. Tap a result you are interested in and check out the details and reviews about that place. You can also see the place on Google Maps, find out how to get there, or give that business a call.

Latitude

Google's Latitude service is a social tool for sharing your location information with selected friends.

Tap **Home Key** >  > **Latitude** to enable Latitude service.

Each time you launch the **Maps** application, your location will be determined by GPS or the phone network and your Latitude status will be updated. You can tap **Menu Key** > **Latitude** in **Maps** or tap **Home Key** >  > **Latitude** to see your status as well as that of your selected friends.

In Latitude, tap **Menu Key** to refresh friends' status, see them on Maps, add new friends, show stale friends or change the settings.

To turn off Latitude service, tap **Menu Key** > **Settings** > **Sign out of Latitude** in Latitude Screen.

Google Talk

Tap **Home Key** >  > **Talk** to use Google Talk. Google Talk is Google's Instant Messages program, which enables you to communicate with other people who also use Google Talk.

To add a new friend:

You can only add people who have a Google Account.

1. In the Friends list, tap **Menu Key** > **Add friend**.
2. Enter the Google email address of the friend you want to add.

To start a chat:

1. Tap a friend in the Friends list.
2. Chat with your friend by entering text using the on-screen keypad.
3. Tap **Send**.

TIPS: Tap the talk status bar above the friends list, tap  to change status and then enter your status message in the text box.

Phone Settings

Setting Time and Date Format

1. Tap **Home Key > Menu Key > Settings > Date & time**.
2. Tap the check box **Use 24-hour format** if you want to change the time format.
3. Tap **Select date format** to select the one you prefer.

Call Settings

By tapping **Home Key > Menu Key > Settings > Call settings**, you can configure voicemail, TTY mode, hearing aids, DTMF tones, speed dial, plus code dialing, Internet calling and other call settings.

TTY Mode

Your phone is a TTY compatible device. A TTY device can allow people who have hearing or speech disabilities to communicate by telephone. Simply connect the TTY device to the phone's headset jack.

1. Tap **Home Key > Menu Key > Settings > Call settings > TTY mode**.
2. Select one of the following options.
 - **TTY Off:** Users who can hear and talk can disable TTY support.
 - **TTY Full:** Users who cannot talk or hear may use this mode to send and receive text messages through TTY device.
 - **TTY HCO:** Users who can hear, but cannot talk, may use this mode to listen to conversation of the other party, and respond via text messages.

- **TTY VCO:** Users who can talk, but cannot hear, may use this mode to talk through the phone and receive responses via text messages.

Hearing Aids

Your phone supports HAC (Hearing Aid Compatibility) function. When you turn on the hearing aid compatibility and use a hearing aid with a Telecoil to answer the phone, it will help you hear more clearly during the phone call.

For more information on HAC, see “For Your Safety - Turning on the HAC Setting” on page 108.

1. Tap **Home Key > Menu Key > Settings > Call settings**.
2. Tick the **Hearing aids** box to turn on hearing aid compatibility.

DTMF Tones

This option allows you to set the length of Dual-tone multifrequency (DTMF) signal tones.

1. Tap **Home Key > Menu Key > Settings > DTMF Tones**.
2. Tap **Normal** or **Long**.

Speed Dial

This option allows you to set speed dialing keys. For detailed information, see “Using Speed Dial” on page 38.

Plus Code Dialing Setting

Plus Code Dialing allows you to have the phone automatically dial the international access code for your location when you tap and hold  in the dialer.

To activate Plus Code Dialing:

1. Tap **Home Key > Menu Key > Settings > Call settings > Plus Code Dialing Setting**.
2. Tick the **North American dialing** box to activate this feature.

To change the international dialing code:

1. Tap **Home Key > Menu Key > Settings > Call settings > Plus Code Dialing Setting**.
2. Tap **International dialing**.
3. Edit a new code and tap **OK**.

Call Forwarding

This option allows you to forward your incoming calls to another phone number.

1. Tap **Home Key > Menu Key > Settings > Call settings > Call forwarding**.
2. Tap **Always forward** to enable or disable it, or edit the phone number to be forwarded to.

NOTE: See your service plan for applicable charges.

Internet Call Settings

To add an Internet calling account:

1. Tap **Home Key > Menu Key > Settings > Call settings > Accounts**.
2. Tap **Add account**.
3. Follow the instructions from your Internet calling service provider to configure the settings for your account.
4. Tap **Menu Key > Save**.

To configure which calls use Internet calling:

You can configure your phone to place all calls using Internet calling (when you're connected to a Wi-Fi network), just calls to Internet calling addresses, or to ask each time you place a call.

1. Tap **Home Key > Menu Key > Settings > Call settings**.
2. Tap **Use Internet calling**.
3. Tap the Internet calling option you want.

To configure your phone to receive Internet calls:

By default, your phone is configured to make Internet calls, but not to ensure that you will receive them. But you can configure your phone to listen for Internet calls made to an Internet calling account you added to your phone.

1. Tap **Home Key > Menu Key > Settings > Call settings > Accounts**.
2. Tick the **Receive incoming calls** check box. Checking this setting will reduce your battery life between charges.

Sound Settings

By tapping **Home Key > Menu Key > Settings > Sound**, you can adjust the sound settings, such as ringtones and alerts.

Setting the Phone Ringtone

1. Tap **Phone ringtone** in the sound settings.
2. Scroll through the ringtone list and select the ringtone you want to use.
3. Tap **OK** to save.



Setting the Notification Ringtone

1. Tap **Notification ringtone** in the sound settings.
2. Scroll through the ringtone list and select one as the default notification ringtone.
3. Tap **OK** to save.

Switching to Silent Mode

1. In the sound settings, tick the **Silent mode** check box.
2. You can also switch to **Silent mode** by holding the **Volume Key (down)** or – if the screen is locked – by dragging the  icon to the left, as shown below.



By default, vibration is enabled in silent mode, and the icon  appears in the status bar. If vibration is disabled, the silent icon  will appear in the status bar.

Switching to Vibrate

1. Tap **Vibrate** in the sound settings.
2. Set a vibration mode.
 - **Always**: Your phone vibrates for all notifications and alerts.

- **Never:** Your phone only sounds for all notifications and alerts.
- **Only in Silent mode:** Your phone vibrates for notifications and alerts when Silent mode is active.
- **Only when not in Silent mode:** Your phone only vibrates for notifications and alerts when Silent mode is not active.

NOTE: If Silent mode is active, the icon  will appear in the status bar when vibration is enabled.

Display Settings

By tapping **Home Key > Menu Key > Settings > Display**, you can adjust the display settings as you like.

Adjusting Screen Brightness

1. Tap **Brightness** in the display settings.
2. Tick the **Automatic brightness** box and your phone can adjust the screen brightness automatically. Clear the tick box to adjust the screen brightness manually.
3. Tap **OK** to confirm.

Adjusting Screen-timeout

When not in use, your phone will turn the screen off after a set length of time. If that time is too long or short, you can adjust it.

1. Tap **Screen timeout** in the display settings.
2. Select your preferred time from the list.

NOTE: Long screen backlight setting will reduce the battery using time.

Changing Screen Orientation

You can change your screen orientation to landscape or portrait automatically when rotating your phone. Simply tick the **Auto-rotate screen** check box in the display settings to enable this feature.

NOTE: Not all applications will be viewable in landscape mode.

Language Settings

You can change the language of your phone's operating system in two simple steps.

1. Tap **Home Key** >  > **Settings** > **Language & keyboard** > **Select language**.
2. Select a language from the list given.

Mobile Network Services

Both CDMA and EvDo are supported by your phone. You can configure the network settings according to the phone service you use.

Enabling Data Services

1. Tap **Home Key** >  > **Settings** > **Wireless & networks** > **Mobile networks**.
2. Tick the **Data enabled** box to enable data services over the mobile network. To disable data services, just clear the tick box.

IMPORTANT: Certain data service requests may require additional time to process. While your device is loading the requested service, the touchscreen may appear unresponsive when in fact it is functioning properly. Allow your phone some time to process your data usage request.

Switching Network Modes

1. Tap **Home Key** >  > **Settings** > **Wireless & networks** > **Mobile networks** > **Network Mode**.
2. Select one of the following: **CDMA/EvDo**, **CDMA only**, or **EvDo only**.

Location Settings

Your phone has the location feature for use in connection with location-based services. This feature allows the wireless networks or GPS satellites to detect your position.

To enable location using wireless networks:

1. Tap **Home Key** >  > **Settings** > **Location & security**.
2. Tick the **Use wireless networks** box. This service uses available wireless networks (Wi-Fi and/or mobile networks) to determine your location in certain applications such as Google Maps.
3. Tap **Agree** to enable this feature.

To enable location using GPS satellites:

1. Tap **Home Key** >  > **Settings** > **Location & security**.
2. Tick the **Use GPS satellites** box to activate GPS location.

Security Settings

Here's how to protect your phone from unauthorized use.

Protecting Your Phone With a Screen Unlock Pattern

Creating a Screen Unlock Pattern

1. Tap **Home Key** >  > **Settings** > **Location & security** > **Set up screen lock** > **Pattern**.
2. Read the instructions and tap **Next**.
3. Watch the example pattern and tap **Next**.
4. Draw your own pattern and tap **Continue**.
5. Draw the pattern again and tap **Confirm**.
6. Press the **Power Key** to lock the screen.

TIPS: You can also clear the **Use visible pattern** box in the Location & security screen if you want to hide your screen unlock pattern as you draw it on the screen.

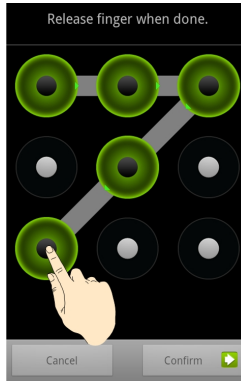

Unlocking the Screen With the Pattern

1. Press the **Power Key**.
2. Draw the pattern you set to unlock the screen.

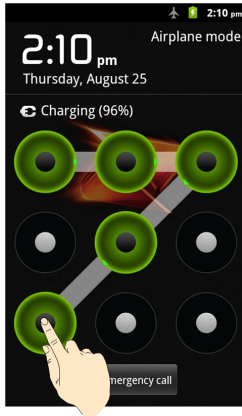

Cannot recall your screen unlock pattern?

You have up to five attempts to unlock your phone. If you still cannot recall the screen unlock pattern, you can tap **Forgot pattern?** and enter your Google account user name and password to reset the screen unlock pattern.

IMPORTANT: You must sign in or create a Google account on your phone before using the above method to reset the pattern.

Disabling Screen Lock Settings

If you have created an unlock pattern, PIN or password, you can disable it.

1. Tap **Home Key** >  > **Settings** > **Location & security** > **Change screen lock**.
2. Draw the screen unlock pattern or enter your PIN/password you have created.
3. Tap **None**.

Calling in Lock Mode

When your phone is locked, you can still make an emergency call.

1. Press **Power Key** to wake up the screen.
2. Tap **Emergency call** to open the emergency dialer and place your emergency call.

Application Settings

Installing an Application

You can install an application from the Android Market (**Home Key** >  > **Market**) by selecting the item you want to download and tapping **Install** or **Buy**.

You can also install a non-Market application if you have allowed the installation of it. Make sure that you select an application developed for your device and processor type before installing it.

1. Tap **Home Key** >  > **My Files**, and open the folder where the application you want to install is.
2. Tap the application to start installation.
3. Follow the instructions that come with the application to complete the installation.

Viewing Installed Applications

Tap **Home Key** >  > **Settings** > **Applications** > **Manage applications**.

You can view the third-party applications installed on your phone and memory card below the **Downloaded** tab.

TIPS: Tap **Menu Key** > **Sort by size** or **Sort by name** to display the applications by amount of memory or name.

Removing an Application

1. Tap **Home Key** >  > **Settings** > **Applications** > **Manage applications**.
2. Tap the application you want to delete.
3. Tap **Uninstall** and **OK** to confirm.

Clearing an Application's Cache

1. Tap **Home Key** >  > **Settings** > **Applications** > **Manage applications**.
2. Tap the application whose cache you want to delete.
3. Tap **Clear cache** and/or **Clear defaults**.

Moving an Application Between the Phone and Memory Card

You can move the applications downloaded or installed on your phone to the memory card when the phone memory is full. You can also move applications to your phone if the memory card is getting full.

NOTE: Not all applications can be moved to your phone or memory card.

1. Tap **Home Key** >  > **Settings** > **Applications** > **Manage applications**.
2. Tap the application you want to move on the **Downloaded** tab.
3. Tap **Move to phone** or **Move to SD card**.

Managing Running Services

You can view and control currently running services on your phone.

1. Tap **Home Key** >  > **Settings** > **Applications** > **Running services**.
TIPS: Tap **Menu Key** > **Show cached processes** or **Show running services** to view cached or running processes.
2. Tap a process entry.
3. Tap **Stop** and then tap **OK** to stop the process.

Storage Use

To view phone storage used by applications, tap **Home Key** >  > **Settings** > **Applications** > **Storage use**.

Battery Use

To check what has been using the battery, tap **Home Key** >  > **Settings** > **Applications** > **Battery use**. Tap an entry to view the details.

TIPS: Tap **Menu Key** > **Refresh** to update the battery use information.

Managing Memory Card

Turning On/Off USB Mass Storage

You can use the USB mass storage feature to transfer data between the memory card and PC.

To turn on USB mass storage:

1. Insert the memory card into your phone and connect the phone to the PC with a USB cable.
2. Flick down the notification panel and tap **USB connected** > **Turn on USB storage**.

To turn off USB mass storage:

Just flick down the notification panel and tap **Turn off USB storage > Turn off USB storage**.

Checking Memory Card Space

Tap **Home Key** >  > **Settings** > **Storage**. You can view **Total space/Available space** in the **SD card** section.

Unmounting the Memory Card

Unmounting makes your memory card unavailable to the phone's operating system, and ready for removal.

1. Tap **Home Key** >  > **Settings** > **Storage**.
2. Tap **Unmount SD card**.

The  icon will appear in the status bar. You can tap **Mount SD card** to mount the memory card again.

Erasing the Memory Card

1. Tap **Erase SD card**.
2. Tap **Erase SD card** again.
3. Tap **Erase everything**.

WARNING: All files stored in the memory card will be erased after the formatting.

Checking Phone Memory

Tap **Home Key** >  > **Settings** > **Storage**.

You can view the **Available space** in the **Internal storage** section.

Accessibility Settings

The accessibility service collects all the text you type, including personal data credit card numbers except passwords. It may also log your user interface interactions. You must first install a screen reader from the Android Market.

1. Install a screen reader (such as Kickback, Soundback, or Talkback) from the Android Market.
2. Tap **Home Key** >  > **Settings** > **Accessibility**.
3. Tap **Accessibility** then select a service for which you want to log data.

To use Power Key to end a call:

During a call, you can press **Power Key** to end the call and the screen will not be turned off. Just tap **Home Key** >  > **Settings** > **Accessibility** and tick the **Power button ends call** box.

Resetting Your Phone

1. Tap **Home Key** >  > **Settings** > **Privacy**.
2. Tap **Factory data reset**.
3. Tap **Reset phone**. Tick **Erase SD card** if you want to erase the memory card.
4. Tap **Erase everything**.

WARNING: All your personal information and downloaded applications on your phone will be erased after the reset.

System Updates and Phone Information

Updating the System

1. Tap **Home Key** >  > **Settings** > **About Phone** > **System updates**.
2. Tap **Storage card updates** to use the update package in the microSD card for system updates, or choose **Update Profile**, **Update PRL** or **Update Firmware** to update.

Viewing Phone Information

1. Tap **Home Key** >  > **Settings** > **About Phone**.
2. The following information is available:
 - **System updates:** Check for selectable system updates which include Storage card updates, Update Profile, Update PRL and Update Firmware.
 - **Status:** View status information about the phone and battery.
 - **Battery use:** View a list of processes that use the battery.
 - **Legal information:** View information about open source licenses, privacy alert and Google legal information.
 - **Model number:** View the model number of your phone.
 - **Android version:** View the Android operating system version running on your phone.
 - **Baseband version:** View the baseband version of your phone.

- **Kernel version:** View the kernel version of your phone.
- **Build number:** View the build number of phone software.
- **Hardware Version:** View the hardware version of your phone.

Other Applications

Alarms

1. Tap **Home Key** >  > **Alarm**.
2. Tap the default alarm set to configure it. Or, to create a new alarm, tap **Menu Key** > **Add alarm**.
3. Tick the **Turn on alarm** box and set up the alarm options.

TIPS: You can use the phone as a bedside clock. In Alarm Screen, tap **Menu Key** > **Clock – Full Screen**.

Calculator

Tap **Home Key** >  > **Calculator** to use the calculator.

TIPS: Tap **Menu Key** > **Advanced panel** to use scientific calculation.

Docs To Go

Tap **Home Key** >  > **Docs To Go**. It is a handy application suite that can open Word, Excel, PowerPoint, or PDF files.

Read the on-screen instructions for detailed information.

My Files

Tap **Home Key** >  > **My Files** to open the file viewer and browser the folders and files.

Global Time

Tap **Home Key** >  > **Global Time**. Then tap **Menu Key** > **Show time zone** to see what time it is in the world's major cities.

Note Pad

Tap **Home Key** >  > **Note pad**.

Note pad is for your memos. Tap **Menu Key** to add/delete them, or export them to your microSD card. Hold an existing note to edit, delete, share or export it.

Stopwatch

1. Tap **Home Key** >  > **Stopwatch**.
2. Tap **Start** to start timing. You can **Pause** or **Resume**.
3. Tap **Reset** to take the stopwatch back to 00:00.0.

Task Manager

You can use **Task Manager** to view or stop applications.

1. Tap **Home Key** >  > **Task Manager**.
2. The task manager contains the following tabs:
 - **Task:** View the currently active applications on your phone. Tap a task and choose to switch to its screen, abort it, or see its detail.

TIPS: Tap  beside each task to kill it. Tap **Menu Key > End All** to abort all active tasks.

- **Application:** View all applications installed on your phone and memory card.
- **Resource:** View the real-time system resources information.

Voice Dialer

Voice Dialer is speech recognition software. You can use it to dial a phone number in your Contacts, open menus or launch phone functions.

Calling a Contact With Voice Dialer

1. Tap **Home Key >**  **> Voice Dialer.**
2. When you see “Listening”, say “Call” followed by the name and label of contact you want to call. For example, say “Call John Doe Mobile”.

Specifications

Dimensions		Approx. 126.5 mm × 68 mm × 11 mm
Weight		Approx. 150 g (with battery)
Bearer		CDMA/EvDo support
Main display dimension, resolution		4.3 inches 480*800
Back Camera	Sensor type	CMOS
	Still image capture resolution	5M Pixels with LED flash
Internal memory		ROM: 4 GB, RAM: 512 MB
Removable memory card		Support microSD card, maximum capacity: 32 GB
Battery	Capacity	1600 mAh
	Standby time	Approx. 270 hours (subject to network status)
	Voice talk time	Approx. 450 minutes (subject to network status)

For Your Safety

General Safety

- Don't make or receive handheld calls while driving. And never text while driving.
- Don't use at gas stations.
- Keep your phone at least 1.5 cm away from your body while making calls.
- Your phone may produce a bright or flashing light.
- Small parts may cause choking.
- Don't dispose of your phone in fire.
- Your phone can produce a loud sound.
- Avoid contact with anything magnetic.
- Keep away from pacemakers and other electronic medical devices.
- Avoid extreme temperatures.
- Switch off when asked to in hospitals and medical facilities.
- Avoid contact with liquids. Keep your phone dry.
- Switch off when told to in aircrafts and airports.
- Don't take your phone apart.
- Switch off when near explosive materials or liquids.
- Only use approved accessories.
- Don't rely on your phone for emergency communications.

Radio Frequency (RF) Energy

This model phone meets the government's requirements for exposure to radio waves.

This phone is designed and manufactured not to exceed the emission limits for exposure to radio frequency (RF) energy set by the Federal Communications Commission of the U.S. Government:

The exposure standard for wireless mobile phones employs a unit of measurement known as the Specific Absorption Rate, or SAR.

The SAR limit set by the FCC is 1.6 W/kg.

Tests for SAR are conducted using standard operating positions accepted by the FCC with the phone transmitting at its highest certified power level in all tested frequency bands. Although the SAR is determined at the highest certified power level, the actual SAR level of the phone while operating can be well below the maximum value.

This is because the phone is designed to operate at multiple power levels so as to use only the power required to reach the network. In general, the closer you are to a wireless base station antenna, the lower the power output.

The highest SAR values for this model phone as reported to the FCC when tested for use at the ear and on the body are:

Head: 0.593 W/kg, Body: 1.25 W/kg

(Body-worn measurements differ among phone models, depending upon available enhancements and FCC requirements.)

While there may be differences between the SAR levels of individual Warp phones and at various positions, they all meet the government requirement.

The FCC has granted an Equipment Authorization for this model phone with all reported SAR levels evaluated as in compliance with the FCC RF exposure guidelines. SAR information on this model phone is on file with the FCC and can be found under the Display Grant section of <http://www.fcc.gov/oet/ea/fccid> after searching on

FCC ID: Q78-ZTEN860

For body worn operation, this phone has been tested and meets the FCC RF exposure guidelines for use with an accessory that contains no metal and that positions the handset a minimum of 1.5 cm from the body. Use of other enhancements may not ensure compliance with FCC RF exposure guidelines. If you do not use a body-worn accessory and are not holding the phone at the ear, position the handset a minimum of 1.5 cm from your body when the phone is switched on.

FCC Compliance

This device complies with part 15 of the FCC Rules. Operation is subject to the following two conditions: (1) This device may not cause harmful interference, and (2) this device must accept any interference received, including interference that may cause undesired operation.

Caution: Changes or modifications not expressly approved by the manufacturer could void the user's authority to operate the equipment.

NOTE: This equipment has been tested and found to comply with the limits for a Class B digital device, pursuant to part 15 of the FCC Rules.

These limits are designed to provide reasonable protection against harmful interference in a residential installation. This equipment generates, uses and can radiate radio frequency energy and, if not installed and used in accordance with the instructions, may cause harmful interference to radio communications. However, there is no guarantee that interference will not occur in a particular installation. If this equipment does cause harmful interference to radio or television reception, which can be determined by turning the equipment off and on, the user is encouraged to try to correct the interference by one or more of the following measures:

- Reorient or relocate the receiving antenna.
- Increase the separation between the equipment and receiver.

- Connect the equipment into an outlet on a circuit different from that to which the receiver is connected.
- Consult the dealer or an experienced radio/TV technician for help.

Using Your Phone With a Hearing Aid Device

Your Warp is compliant with the FCC Hearing Aid Compatibility (HAC) requirements. For additional HAC information, including the HAC rating of this product, please refer to www.zteusa-support.com.

When some wireless phones are used near some hearing devices (hearing aids and cochlear implants), users may detect a buzzing, humming, or whining noise. Some hearing devices are more immune than others to this interference noise, and phones also vary in the amount of interference they generate. The wireless telephone industry has developed ratings for some of their mobile phones to assist hearing device users in finding phones that may be compatible with their hearing devices. Not all phones have been rated. Phones that have been rated have a label on the box.

Your Warp has been tested for hearing aid device compatibility and has an M4/T3.

These ratings are not guaranteed. Results will vary, depending on the level of immunity of your hearing device and the degree of your hearing loss. If your hearing device happens to be vulnerable to interference, you may not be able to use a rated phone successfully. Trying out the phone with your hearing device is the best way to evaluate it for your personal needs.

M-Ratings: Phones rated M3 or M4 meet FCC requirements and are likely to generate less interference with hearing devices than phones that are not labeled. M4 is the better/higher of the two ratings.

T-Ratings: Phones rated T3 or T4 meet FCC requirements and are likely to be more usable with a hearing device's telecoil ("T Switch" or "Telephone Switch") than unrated phones. T4 is the better/higher of the two ratings. (Note that not all hearing devices contain telecoils.) The more immune your hearing aid device is, the less likely you are to experience interference noise from your wireless phone.

Hearing devices may also be measured for immunity to this type of interference. Your hearing device manufacturer or hearing health professional may help you find results for your hearing device.

For additional information about the FCC's actions with regard to hearing aid compatible wireless devices and other steps the FCC has taken to ensure that individuals with disabilities have access to telecommunications services, please go to www.fcc.gov/cgb/dro.

Turning on the HAC Setting

To turn on the HAC function, tap **Home Key > Menu Key > Settings > Call settings** and tick the **Hearing aids** check box. For detailed information, refer to “Using Your Phone With a Hearing Aid Device” on page 107.

This section applies to T-Rating only and hearing aids that contain telecoils. When the HAC setting is on, your Warp sends the audio from your phone calls to the telecoil rather than to the microphone of your hearing aid. You are likely to hear calls much better because volume is increased and background noise and feedback are diminished. The HAC setting improves only the calls you listen to through the earpiece. It does not affect calls heard on the speaker or with a headset. HAC requires extra battery power, so watch your battery consumption when it's turned on.

CAUTION: Do not turn on the HAC setting unless you use a hearing aid with a telecoil. Using this setting without a hearing aid or with a hearing aid without a telecoil may be harmful to your hearing.

Distraction

Driving

Full attention must be given to driving at all times in order to reduce the risk of an accident. Using a phone while driving (even with a hands free kit) can cause distraction and lead to an accident. You must comply with local laws and regulations restricting the use of wireless devices while driving.

Operating Machinery

Full attention must be given to operating the machinery in order to reduce the risk of an accident.

Product Handling

General Statement on Handling and Use

You alone are responsible for how you use your phone and any consequences of its use.

You must always switch off your phone wherever the use of a phone is prohibited. Use of your phone is subject to safety measures designed to protect users and their environment.

- Always treat your phone and its accessories with care and keep it in a clean and dust-free place.
- Do not expose your phone or its accessories to open flames or lit tobacco products.
- Do not expose your phone or its accessories to liquid, moisture or high humidity.
- Do not drop, throw or try to bend your phone or its accessories.
- Do not use harsh chemicals, cleaning solvents, or aerosols to clean the device or its accessories.
- Do not paint your phone or its accessories.
- Do not attempt to disassemble your phone or its accessories, only authorized personnel must do so.
- Do not expose your phone or its accessories to extreme temperatures, minimum - [5] and maximum + [50] degrees Celsius.
- Please check local regulations for disposal of electronic products.
- Do not carry your phone in your back pocket as it could break when you sit down.

Battery

- Do not disassemble or crush, bend or deform, puncture, or shred.
- Do not modify or remanufacture, attempt to insert foreign objects into the battery, immerse or expose to water or other liquids, expose to fire, explosion or other hazard.
- Only use the battery for the system for which it is specified.
- Only use the battery with a charging system that has been qualified by ZTE. Use of an unqualified battery or charger may present a risk of fire, explosion, leakage, or other hazard.
- Do not short-circuit a battery or allow metallic conductive objects to contact battery terminals.
- Replace the battery only with another battery that has been qualified with the system per this standard, IEEE-Std-1725. Use of an unqualified battery may present a risk of fire, explosion, leakage or other hazard.
- Promptly dispose of used batteries in accordance with local regulations.
- Battery usage by children should be supervised.
- Avoid dropping the phone or battery.
- Improper battery use may result in a fire, explosion, or other hazard.
- The phone shall only be connected to products that bear the USB-IF logo or have completed the USB-IF compliance program.

Small Children

Do not leave your phone and its accessories within the reach of small children or allow them to play with it. They could hurt themselves or others, or could accidentally damage the phone.

Your phone contains small parts with sharp edges that may cause an injury or may become detached and create a choking hazard.

Demagnetization

To avoid the risk of demagnetization, do not allow electronic devices or magnetic media close to your phone for a long time.

Antennas

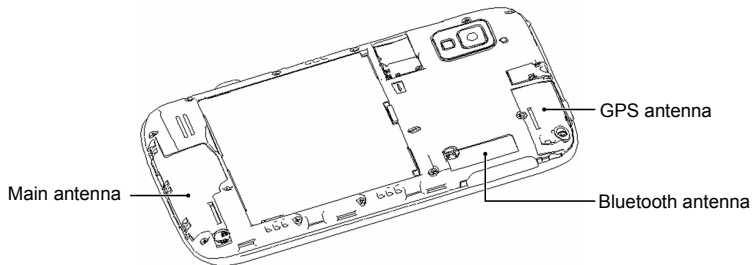

Do not touch the antenna unnecessarily.

Normal Use Position

When placing or receiving a phone call, hold your phone to your ear, with the bottom toward your mouth. Keep your phone at least 1.5 cm away from your body.

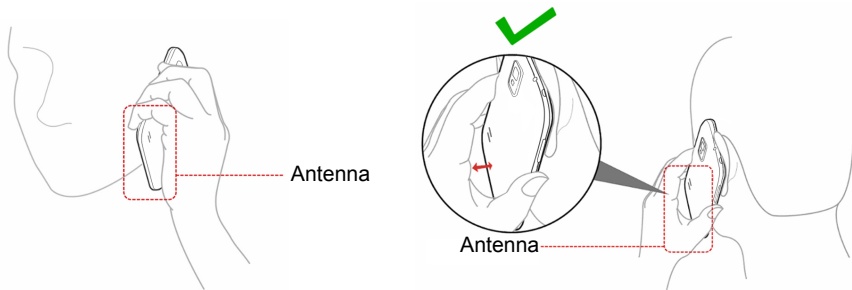

Air Bags

Do not place a phone in the area over an air bag or in the air bag deployment area as an airbag inflates with great force and serious injury could result.

Store the phone safely before driving your vehicle.

Seizures/Blackouts

The phone can produce a bright or flashing light. A small percentage of people may be susceptible to blackouts or seizures (even if they have never had one before) when exposed to flashing lights or light patterns such as when playing games or watching video. If you have experienced seizures or blackouts or have a family history of such occurrences, please consult a physician. To reduce the risk of blackouts or seizures, you can use your phone in a well lit room and take frequent breaks.

Repetitive Strain Injuries

To minimize the risk of Repetitive Strain Injury (RSI) when texting or playing games with your phone:

- Do not grip the phone too tightly.
- Press the buttons lightly.
- Use the special features which are designed to minimize the times of pressing buttons, such as Message Templates and Predictive Text.
- Take frequent breaks to stretch and relax.

Emergency Calls

This phone, like any wireless phone, operates using radio signals, which cannot guarantee connection in all conditions. Therefore, you should not rely solely on any wireless phone for emergency communications.

Loud Noise

This phone is capable of producing loud noises, which may damage your hearing. Turn down the volume before using headphones, Bluetooth headsets or other audio devices.

Phone Heating

Your phone may become warm during charging and during normal use.

Electrical Safety

Accessories

Use only approved accessories.

Do not connect with incompatible products or accessories.

Take care not to touch or allow metal objects, such as coins or key rings, to contact or short-circuit in the battery terminals.

Connection to a Car

Seek professional advice when connecting a phone interface to the vehicle electrical system.

Faulty and Damaged Products

Do not attempt to disassemble the phone or its accessory.

Only qualified personnel must service or repair the phone or its accessory.

If your phone or its accessory has been submerged in water, punctured, or subjected to a severe fall, do not use it until you have taken it to be checked at the store where you purchased it or call ZTE hotline 877 817 1759 to ask for help.

Radio Frequency Interference

General Statement on Interference

Care must be taken when using the phone in close proximity to personal medical devices, such as pacemakers and hearing aids.

Please consult your doctor and the device manufacturer to determine if operation of your phone may interfere with the operation of your medical device.

Pacemakers

Pacemaker manufacturers recommend that a minimum separation of 15 cm be maintained between a mobile phone and a pacemaker to avoid potential interference with the pacemaker. To achieve this, use the phone on the opposite ear to your pacemaker and do not carry it in a breast pocket.

Hearing Aids

People with hearing aids or other cochlear implants may experience interfering noises when using wireless devices or when one is nearby.

The level of interference will depend on the type of hearing device and the distance from the interference source, increasing the separation between them may reduce the interference. You may also consult your hearing aid manufacturer to discuss alternatives. For more information, please refer to “Using Your Phone With a Hearing Aid Device” on page 107.

Medical Equipment

Switch off your wireless device when requested to do so in hospitals, clinics or health care facilities. These requests are designed to prevent possible interference with sensitive medical equipment.

Aircraft

Switch off your wireless device whenever you are instructed to do so by airport or airline staff.

Consult the airline staff about the use of wireless devices on board the aircraft and enable the airplane mode of your phone when boarding an aircraft.

Interference in Vehicles

Please note that because of possible interference to electronic equipment, some vehicle manufacturers forbid the use of mobile phones in their vehicles unless a hands-free kit with an external antenna is included in the installation.

Explosive Environments

Gas Stations and Explosive Atmospheres

In locations with potentially explosive atmospheres, obey all posted signs to turn off wireless devices such as your phone or other radio equipment.

Areas with potentially explosive atmospheres include fueling areas, below decks on boats, fuel or chemical transfer or storage facilities, areas where the air contains chemicals or particles, such as grain, dust, or metal powders.

Blasting Caps and Areas

Power off your mobile phone or wireless device when in a blasting area or in areas posted power off “two-way radios” or “electronic devices” to avoid interfering with blasting operations.

Consumer Limited Warranty

ZTE ("Seller") offers you a limited warranty that the enclosed product or products (the "Product") will be free from defects in material and workmanship for a period that expires one year from the date of sale of the Product to you, provided that you are the original end-user purchaser of the Product and provided that your purchase was made from a supplier authorized by the Seller. Transfer or resale of a Product will automatically terminate warranty coverage with respect to that Product. This limited warranty is not transferable to any third party, including but not limited to any subsequent purchaser or owner of the Product. This limited warranty is applicable to end users in the United States and Puerto Rico.

Seller will, at its sole and absolute discretion, either repair or replace a Product (which unit may use refurbished parts of similar quality and functionality) if found by Seller to be defective in material or workmanship, or if Seller determines that it is unable to repair or replace such Product, Seller will refund the purchase price for such Product, provided that the subject Product (i) is returned to a Seller authorized service center within the one year warranty period, and (ii) is accompanied by a proof of purchase in the form of a bill of sale or receipted invoice which evidences that the subject Product is within the one year warranty period. After the one year warranty period, you must pay all shipping, parts and labor charges. In the event that the product is deemed un-repairable or has been removed from the list of products supported by the Seller, you will only be liable for shipping and labor charges.

This limited warranty does not cover and is void with respect to the following: (i) any Product which has been improperly installed, repaired, maintained or modified; (ii) any Product which has been subjected to misuse (including any Product used in conjunction with hardware electrically or mechanically incompatible or used with

accessories not approved by Seller), abuse, accident, physical damage, abnormal operation, improper handling, neglect, exposure to fire or liquid; (iii) any Product operated outside published maximum ratings; (iv) cosmetic damage; (v) any Product on which warranty stickers or Product serial numbers have been removed, altered, or rendered illegible; (vi) cost of installation, removal or reinstallation; (vii) signal reception problems (unless caused by defects in material and workmanship); (viii) damage the result of fire, flood, acts of God or other acts which are not the fault of Seller and which the Product is not specified to tolerate, including damage caused by mishandling, shipping and blown fuses; (ix) consumables (such as fuses); or (x) any Product which has been opened, repaired, modified or altered by anyone other than Seller or a Seller authorized service center.

USE ONLY SELLER APPROVED ACCESSORIES WITH SELLER PHONES. USE OF ANY UNAUTHORIZED ACCESSORIES MAY BE DANGEROUS AND WILL INVALIDATE THE PHONE WARRANTY IF SAID ACCESSORIES CAUSE DAMAGE OR A DEFECT TO THE PHONE.

SELLER SPECIFICALLY DISCLAIMS LIABILITY FOR ANY AND ALL DIRECT, INDIRECT, SPECIAL, GENERAL, PUNITIVE, EXEMPLARY, AGGRAVATED, INCIDENTAL OR CONSEQUENTIAL DAMAGES, EVEN IF ADVISED OF THE POSSIBILITY OF SUCH DAMAGES, WHETHER FORESEEABLE OR UNFORESEEABLE OF ANY KIND WHATSOEVER, INCLUDING BUT NOT LIMITED TO LOSS OF PROFITS, UNANTICIPATED BENEFITS OR REVENUE, ANTICIPATED PROFITS ARISING OUT OF USE OF OR INABILITY TO USE ANY PRODUCT (FOR EXAMPLE, WASTED AIRTIME CHARGES DUE TO THE MALFUNCTION OF A PRODUCT) OR CONTRIBUTION OR INDEMNITY IN RESPECT OF ANY CLAIM RELATED TO A PRODUCT.

REPAIR OR REPLACEMENT OF A DEFECTIVE PRODUCT OR REFUND OF THE PURCHASE PRICE RELATING TO A DEFECTIVE PRODUCT, AS PROVIDED UNDER THIS WARRANTY, ARE YOUR SOLE AND EXCLUSIVE REMEDIES FOR BREACH OF THE LIMITED WARRANTY, AND SUBJECT TO THIS WARRANTY,

THE PRODUCTS ARE APPROVED AND ACCEPTED BY YOU "AS IS". SELLER MAKES NO OTHER WARRANTIES, REPRESENTATIONS OR CONDITIONS OF ANY KIND, ORAL OR WRITTEN, EXPRESS OR IMPLIED, STATUTORY OR OTHERWISE, WITH RESPECT TO THE PRODUCTS, INCLUDING BUT NOT LIMITED TO ANY IMPLIED WARRANTY OR CONDITION OF MERCHANTABILITY OR FITNESS FOR A PARTICULAR PURPOSE OR AGAINST INFRINGEMENT OR ANY IMPLIED WARRANTY OR CONDITION ARISING OUT OF TRADE USAGE OR OUT OF A COURSE OF DEALING OR COURSE OF PERFORMANCE. NO DEALER, DISTRIBUTOR, AGENT OR EMPLOYEE IS AUTHORIZED TO MAKE ANY MODIFICATION OR ADDITION TO THIS WARRANTY.

Some jurisdictions do not allow the exclusion or limitation of incidental or consequential damages, or allow limitations on how long an implied warranty lasts, so the above limitations or exclusions may not apply to you. This limited warranty gives you specific legal rights, and you may also have other rights which vary from jurisdiction to jurisdiction.

For warranty service information, please call the following telephone number: 1-877-817-1759, 1-212-444-0502 or return to the point of sale for the products. The retailer can return the units to ZTE authorized service center in US for repair service.

IMPORTANT: Please provide warranty information (proof of purchase) to ZTE in order to receive warranty service at no charge. If the warranty has expired on the device, charges may apply.

LEGAL INFORMATION

Copyright © 2011 ZTE CORPORATION.

All rights reserved.

No part of this publication may be quoted, reproduced, translated or used in any form or by any means, electronic or mechanical, including photocopying and microfilm, without the prior written permission of ZTE Corporation.

ZTE Corporation reserves the right to make modifications on print errors or update specifications in this guide without prior notice.

The *Bluetooth*[®] trademark and logos are owned by the Bluetooth SIG, Inc. and any use of such trademarks by ZTE Corporation is under license. Other trademarks and trade names are the property of their respective owners.

Version No.: R1.0

Edition Time: 2011.9.15

Manual No. : 079584503559

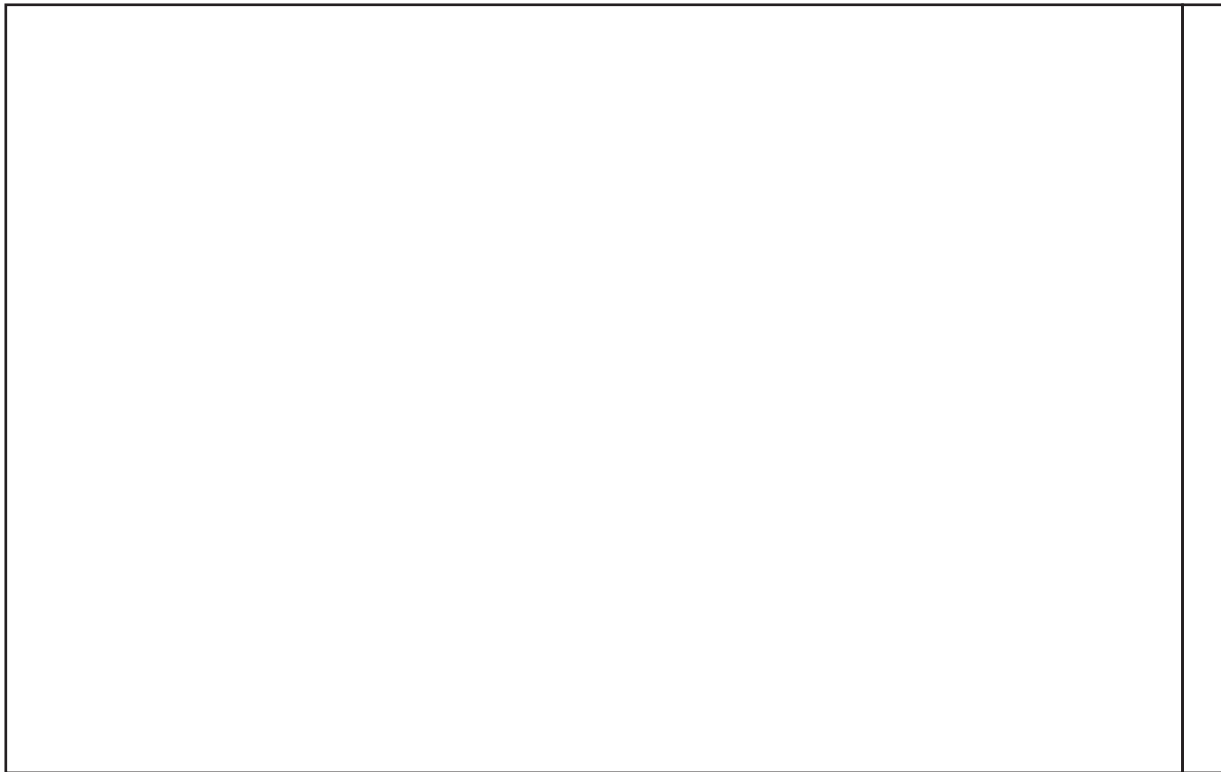

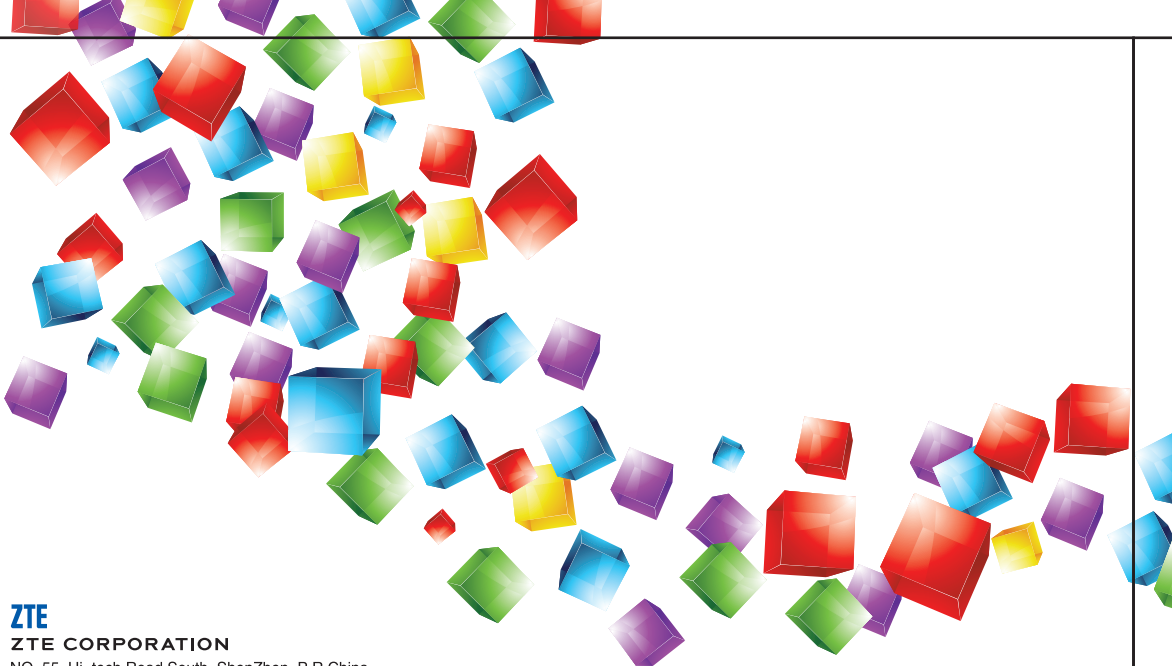

ZTE

ZTE CORPORATION

NO. 55, Hi-tech Road South, ShenZhen, P.R.China

Postcode: 518057

<http://www.zte.com.cn> mobile@zte.com.cn

Service Hotline: (+01) 877-817-1759

The information on the package is only for your reference. Images are for your reference only. Please check the product model before purchasing. ZTE reserves the rights to change specifications and parameters of the products without further notice.