



LG

Life's Good

ENGLISH

User Guide

LG-P999

P/N : MFL67228102 (1.0)

www.lg.com

Congratulations on your purchase of the advanced and compact LG-P999 phone by LG, designed to operate with the latest digital mobile communication technology.

Some of the contents in this manual may differ from your phone depending on the software of the phone or your service provider.

- This handset is not recommended for the visually impaired because of its touch-screen keypad.
- Copyright ©2011 LG Electronics, Inc. All rights reserved. LG and the LG logo are registered trademarks of LG Group and its related entities. All other trademarks are the property of their respective owners.
- Google™, Google Maps™, Gmail™, YouTube™, Google Talk™ and Android Market™ are trademarks of Google, Inc.



About this user manual

Please read this user manual carefully before you use your phone and keep it handy for future reference.

Should phone fail to operate correctly, refer to FAQ.

- Some features and service may vary by area, phone, carrier, plan and version of phone software.
- Screen displays and illustrations on this user manual may differ from those you see on actual phone.
- Designs and specifications of the phone and other accessories are subject to change without any notice.

Contents

About this user manual	4	Google Account Set-up	38
Important notice	8	Creating your Google account	38
Getting to know your phone	17	Signing in to your Google account	39
Installing the SIM card and battery	19	Calls/Contacts	41
Charging your phone	21	Making a voice call.....	41
Installing the memory card	22	Calling your contacts.....	41
Formatting the memory card	24	Answering and rejecting a call	42
Your Home screen	26	Adjusting call volume.....	42
Touch-screen tips	26	Making a second call	42
Lock your phone.....	26	Viewing your call logs.....	43
Unlock the screen.....	27	Call settings.....	43
Home screen panels	27	Contacts	45
Adding applications to your Home screen.....	28	Searching for a contact... ..	45
Getting back to a recently used application	29	Adding a new contact.....	45
Status Bar.....	30	Favorite contacts	46
Viewing the Status Bar	30	Messaging/E-mail	47
On-screen Keyboard.....	33	Messaging.....	47
Text Input Methods.....	34	Sending a message.....	47
Using the Swipe		Changing your message settings	48
Keyboard	34	Opening your email and email accounts screen.....	48
Swipe Text Entry Tips	35	Composing and sending email.....	50
Swipe Settings	35	Working with account folders	51

Contents

Adding and editing email accounts	51	Using Smart Share	66
Camera	53	Music	67
Getting to know the viewfinder	53	Playing a song.....	67
Using the focus mode	54	Transferring files using USB mass storage devices.....	68
Taking a quick photo	54	How to save music/video files to your phone	69
Once you've taken the photo	55	How to send data from your phone via Bluetooth	70
Using the advanced settings	56	Google applications	72
Viewing your saved photos	59	Google Maps™	72
Video camera.....	60	Market™	72
Getting to know the viewfinder	60	Gmail™	73
Recording a quick video... ..	61	Google Talk™	73
After recording a video.....	61	Google Search™	73
Using the advanced settings	62	YouTube™	75
Watching your saved videos	64	Utilities	76
Adjusting the volume when viewing a video.....	64	Setting your alarm	76
Video camera.....	65	Using your calculator.....	76
Gallery	65	Adding an event to your calendar	77
To change how the contents of an album are displayed	65	The Web	78
		Browser	78
		Using options	78
		Settings.....	80
		Wireless & networks	80
		Call settings.....	81
		Sound.....	83
		Display	84

Location & security	84	Phone Software update....	102
Applications.....	86	Copyrights and	
Accounts & sync	87	trademarks.....	103
Privacy.....	88	Accessories	105
SD card & phone		Technical data.....	106
storage.....	89	FAQ	107
Language & keyboard	89	For Your Safety	116
Voice input & output.....	90		
Accessibility.....	92		
HDMI	92		
Date & time	93		
About phone	93		
Wi-Fi.....	94		
Turn on Wi-Fi.....	94		
To connect to Wi-Fi	94		
Sharing your phone's mobile			
data connection.....	95		
USB tethering & portable			
Wi-Fi hotspot settings	96		
To share your phone's data			
connection via USB.....	97		
USB tethering and data			
sharing	97		
To share your phone's data			
connection as a portable			
Wi-Fi hotspot (Wi-Fi			
tethering).....	99		
To rename or secure your			
portable hotspot.....	100		

Important notice

Please check to see if any problems you have encountered with your phone are described in this section, before taking the phone in for service or calling a service representative.

1. Phone memory

When available space on your phone memory is less than 2%, your phone cannot receive new messages. You will need to check your phone memory and delete some data, such as applications or messages to make more memory available.

To manage applications:

1. On the Home screen, touch the **Applications tab** > **Settings** > **Applications** > **Manage applications**.
2. When all applications appear, select the application you want to uninstall.
3. Touch **Uninstall** > **OK** to uninstall the application.

2. Optimizing battery life

You can extend your battery's life between charges by turning off features that you don't need constantly running in the background. You can also monitor how applications and system resources consume battery power.

To extend the life of your battery:

- Turn off radio communications that you aren't using. If you aren't using Wi-Fi, Bluetooth, or GPS, turn them off.
- Turn down screen brightness and set a shorter screen timeout.
- Turn off automatic syncing for Gmail, Calendar, Contacts, and other applications.
- Some applications you have downloaded may cause your battery's life to be reduced.

To check the battery charge level:

1. On the Home screen, touch the **Applications tab** > **Settings** > **About phone** > **Status**.
2. The battery status (charging or discharging) and level (as a percentage of fully charged) are displayed at the top of the screen.

To monitor and control what uses the battery:

1. On the Home screen, touch the **Applications tab** > **Settings** > **About phone** > **Battery use**.
2. The top of the screen displays battery usage time. This is either how long since your phone was last connected to a power source or if connected to a power source, how long since your phone was last run on battery

power. The body of the screen lists applications or services using battery power from greatest amount to least.

3. Installing an open source OS

Installing an open source OS on your phone and not using the OS provided by the manufacturer may cause your phone to malfunction.

⚠ WARNING: If you install and use an OS other than the one provided by the manufacturer, your phone is no longer covered by the warranty.

4. Using an unlock pattern

Set an unlock pattern to secure your phone.

1. On the Home screen, touch the **Applications tab** > **Settings** > **Location & security** > **Set up screen lock**.
2. A set of screens guide you through drawing a screen unlock pattern.
3. Draw your own unlock pattern by connecting four or more dots.
To unlock the phone, draw the pattern you have set on the screen.

Caution: You need to create your Google account first before you set an unlock pattern.

! WARNING:

Precautions to take when using the unlock pattern

It is very important that you remember the unlock pattern you set. You will not be able to access your phone if you use an incorrect pattern five times. You have five chances to enter your unlock Pattern, PIN or Password. If you have used all five chances, you can try again after 30 seconds.

If you can't recall your unlock Pattern, PIN or Password:

If you have tried to log on to your Google account on the phone and failed to use correct pattern five times, touch **Forgot pattern?** You will then be required to sign in with your Google account to unlock your phone.

If you haven't created a Google account on the phone or you forgot it, you need to perform a factory reset.

5. Using hard reset

If your phone does not restore to the original condition, use a Hard Reset (Factory Reset) to initialize it.

When the phone is turned off, press and hold the Power/Lock + Volume Down Keys at the same time (for over ten seconds). The phone will turn on and perform a factory reset immediately.

! WARNING:

- If you perform a Hard Reset, all user applications, user data and DRM licenses will be deleted.
- Please remember to back up any important data before performing a Hard Reset.

6. Connecting to Wi-Fi networks

To use Wi-Fi on your phone, you need to access a wireless access point or "hotspot." Some access points are open and you can simply connect to them. Others are hidden or implement other security features, so you must configure your phone to connect to them.

Turn off Wi-Fi when you're not using it to extend the life of your battery.

To turn Wi-Fi on and connect to a Wi-Fi network:

1. On the Home screen, touch the **Applications tab** > **Settings** > **Wireless & networks** > **Wi-Fi settings**.
2. Touch **Wi-Fi** to turn it on and begin scanning for available Wi-Fi networks.

- A list of available Wi-Fi networks is displayed. Secured networks are indicated by a lock icon.
3. Touch a network to connect to it.
 - If the network is open, you are prompted to confirm that you want to connect to that network by touching **Connect**.
 - If the network is secured, you are prompted to enter a password or other credentials. Ask your network administrator for details.
 4. The Status Bar displays icons that indicate Wi-Fi status.

7. Opening and switching applications

Multi-tasking is easy with Android because open applications keep running even when you open another application. There's no need to quit an application before opening another. Use and switch among several open applications. Android manages each application, stopping and starting them as needed, to ensure that idle applications don't consume resources unnecessarily.

To stop the application you are using:

1. On the Home screen, touch the **Applications tab** > **Settings**> **Applications**> **Manage applications**.
2. Touch the desired application and touch **Force stop** to stop using it.

TIP!

Getting back to a recent application

Touch and hold the **Home Key**. A screen will appear listing the applications you have recently used.

8. Connecting your phone to a computer via USB

Transfer file on your microSD card using USB devices:

1. Install your microSD card on your phone if it is not already installed.
2. Before connecting the USB cable, make sure that **Mass storage only** mode is enabled on your phone. On the Home screen, touch the **Applications tab > Settings > SD card & phone storage**, then select the **Mass storage only** check box.
3. Use the USB cable with your phone to connect the phone to a USB port on your computer. You will receive a notification that the USB is connected.
4. Touch **Turn on USB storage**. Then touch **OK** to confirm.

When the phone is connected as USB storage, you will receive a notification. Your phone's microSD card is mounted as a drive on your computer. You can now copy files to and from the microSD card.

NOTE: USB and Bluetooth drivers are not automatically removed. Therefore, they must be uninstalled manually.

TIP! To use the microSD card on your phone again, you need to open the **Notifications Panel** and touch **Turn off USB storage**.

When the USB is connected, you can't access the microSD card from your phone, so you can't use applications that rely on the microSD card, such as Camera, Gallery and Music.

To disconnect your phone from the computer, carefully follow your computer's instructions for correctly disconnecting USB devices to avoid losing information on the card.

1. Safely disconnect the USB device on your computer.
2. Open the **Notifications Panel** and touch **Turn off USB storage**.
3. Touch **Turn off USB storage** in the dialog that opens.

9. Unlock screen when using data connection

Your display will go dark if untouched for a period of time when using data connection. To turn on your LCD screen, just touch it.

10. Do not connect your phone when you power on/off your PC

Make sure you disconnect your phone from the PC as it might cause errors on your PC.

11. Hold your phone upright

Please hold your phone straight and upright, as with a normal phone. The LG-P999 has an internal antenna. Be careful not to scratch or damage the back of the phone, as this will cause a loss of performance. While making/receiving calls or sending/receiving data, try to avoid holding the lower part of the phone where the antenna is located. This may affect call quality.

12. If the screen freezes

If the phone does not respond to user input or the screen freezes:

Remove the battery, insert it again and turn on the phone. If it still does not work, please contact customer service.

Getting to know your phone

To turn on the phone, press and hold the Power/Lock Key for three seconds.

To turn off the phone, press the Power/Lock Key for three seconds and touch Power off. Then touch OK to confirm.

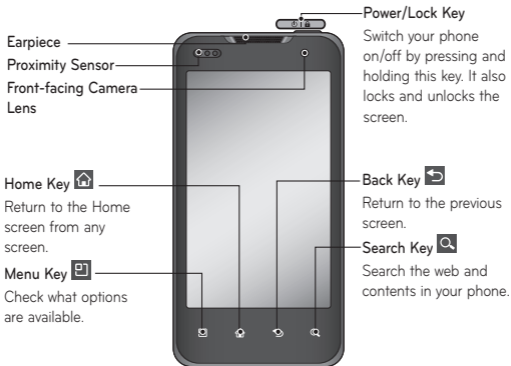

NOTE: Proximity Sensor

When receiving and making calls, the proximity sensor automatically turns the backlight off and locks the touch keypad by sensing when the phone is near your ear. This extends battery life and prevents the touch keypad from activating unintentionally during calls.

! WARNING:

Placing a heavy object on the phone or sitting on it can damage its LCD and touch screen functions. Do not cover the LCD's proximity sensor with protective film. This may cause the sensor to malfunction.

Earphone Jack



HDMI Cable Port

Power/Lock Key



Charger/USB Port

Volume Keys



- On the Home screen: Controls the ringer volume.
- During a call: Controls your earpiece volume.
- When playing a song: Controls volume continuously.

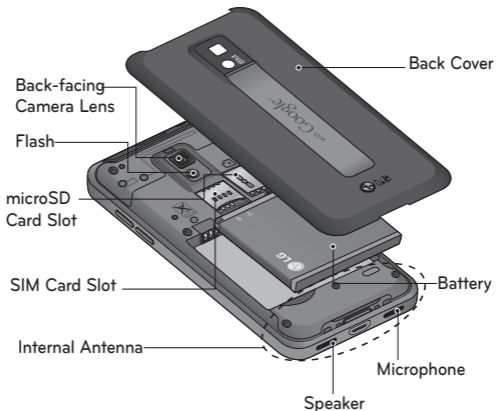

Installing the SIM card and battery

Before you can start exploring your new phone, you'll need to set it up. To insert the SIM card and battery:

1. To remove the back cover, hold the phone firmly in your hand. With your other hand, firmly press your thumb on the back cover. Use the fingertip cutout to pull off the back cover with your forefinger.

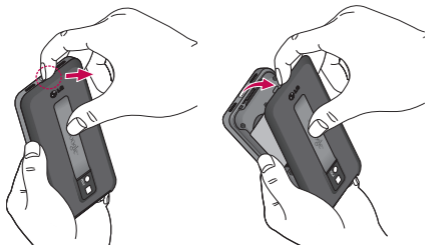

2. Slide the SIM card into the SIM card slot. Make sure the gold contact area on the card is facing downwards.

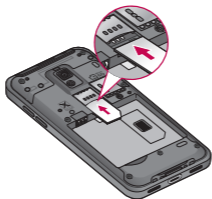

3. Insert the battery into place by aligning the gold contacts on the phone and the battery (1) and pressing it down until it clicks into place (2).



4. Align the back cover over the battery compartment (1) and press it down until it clicks into place (2).



Removing the Battery

Grip the battery at the bottom end (3) and lift it up and out of the battery compartment (4).



TIP!

To remove the battery, first remove the back cover and hold the phone firmly in your hand. With your other hand, firmly press down using your thumb and lift off the battery.

Charging your phone

Insert one end of the charger into the phone's charger/USB port and plug the other end into an electrical socket. The battery must be fully charged initially to extend battery lifetime.



NOTE: Make sure the 'B' side is facing upwards when connecting the USB cable into the phone's charger/USB port.

! Notice

Use only an LG-approved battery, charger and USB cable specific to your phone model since they are designed to maximize battery life. Using other chargers and USB cables will not guarantee full battery charge and normal charging time.

Installing the memory card

NOTE: The LG-P999 supports up to a 32 GB memory card.

To insert a memory card:

Slide the memory card into the microSD card slot until it clicks into place. Make sure the gold contact area on the card is facing downwards.

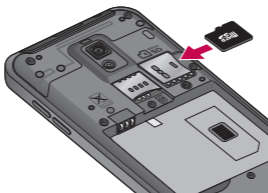

Removing a memory card

Carefully remove the memory card by gently pushing it into the phone to release it. Then gently pull it out of the microSD card slot.

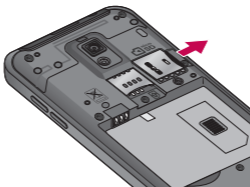

! WARNING

Do not insert or remove the memory card when the phone is on. Otherwise, you may damage the memory card as well as your phone and the data stored on the memory card may be corrupted.

Formatting the memory card

Your memory card may already be formatted. If it isn't, you must format it before you can use it.

NOTE: All files on your memory card are deleted when you format it.

1. On the Home screen, touch the **Applications tab** to open the applications menu.
2. Touch **Settings > SD card & phone storage**.
3. Touch **Unmount SD card**.
4. Touch **Format SD card**, then confirm your choice.
5. If you set the pattern lock, input the pattern lock and select **Erase everything**. The card will then be formatted and ready to use.

NOTE: If there is content on your memory card, the folder structure may be different after formatting, as all the files will have been deleted.

When the phone is connected as USB storage, some menu items cannot be used at the same time, or may be grayed out.

TIP!

If your memory card is already unmounted, you can use the following steps to format it.

Touch the **Applications tab > Settings > SD card & phone storage > Format SD card.**

! WARNING: Do not insert or remove the memory card when the phone is on. Otherwise, you may damage the memory card as well as your phone and the data stored on the memory card may be corrupted. To remove the memory card safely, please touch the **Applications tab > Settings > SD card & phone storage > Unmount SD card.**

Your Home screen

Touch-screen tips

Here are some tips on how to navigate around your phone.

Touch - To choose a menu/option or open an application, touch it.

Touch and hold - To open an options menu or grab an object you want to move, touch and hold it.

Drag - To scroll through a list or move slowly, drag across the touch screen.

Flick - To scroll through a list or move quickly, flick across the touch screen (drag quickly and release).

NOTE:

- To select an item, touch the center of the icon.
- Do not to press too hard; the touch screen is sensitive enough to pick up a light, firm touch.
- Use the tip of your finger to touch the option you want. Be careful not to touch any other keys.

Lock your phone

When you are not using your phone, press the **Power/Lock Key** to lock your phone. This helps to prevent accidental touching of the keys and saves battery power.

If you do not use the phone for a while, the screen you are viewing is replaced by the lock screen to conserve the battery.

NOTE: If there are any programs running when you set the pattern, they may be still running in lock mode. It is recommended that you exit all programs before entering lock mode to avoid unnecessary charges (e.g. phone call, web access and data communications).



Unlock the screen

To wake up your phone, press the **Power/Lock Key**. The lock screen will appear. Touch and slide the Unlock Key  to the right to unlock the screen. The last screen you were working on will open.

Home screen panels

Simply swipe your finger to the left or right to view the Home screen panels. You can also customize each panel with widgets, shortcuts to your favorite applications, folders and wallpapers.

In your Home screen, you can view the Quick Keys at the bottom of the screen. The Quick Keys provide easy, one-touch access to the functions you use the most.

-  Touch the **Phone** icon to display the touch dial pad to make a call.
-  Touch the **Browser** icon to open the Browser and navigate the Web.
-  Touch the **Applications tab** to view all your installed applications.

To open the desired application, simply touch the icon in the applications list.

NOTE: Preloaded applications may be different depending on your phone's software or your service provider.

Adding applications to your Home screen

You can customize your Home screen by adding shortcuts, widgets, or folders to it. For more convenience when using your phone, add your favorite widgets to the Home screen.



To add a desired application to your Home screen:

1. On the Home screen, touch the **Menu Key** and select **Add**. You can also touch and hold an empty part of the Home screen.
2. On the **Add to Home screen** menu, touch the type of item you want to add.
3. For example, touch **Folders** from the list and then **Contacts with phone numbers**.

4. You will see a new folder's icon on the Home screen. Drag it to the desired location on the desired panel and release your finger from the screen.

TIP! To add an application icon to the Home screen from the Applications menu, touch and hold the application icon you want to add.

To remove an application icon from the Home screen:

1. Touch and hold the icon you want to remove. The Applications tab will change to the Trash Can icon .
2. Drag and drop the application icon to a Trash Can icon .

NOTE: You cannot delete the preloaded applications (Only their icons can be deleted from the screen).

Getting back to a recently used application

1. Touch and hold the **Home Key**. The screen will display a pop up with icons of applications that you have used recently.
2. Touch an icon to open its application. Or touch the **Back Key** to return to the current application.

Status Bar

The Status Bar runs across the top of your screen.

Touch and slide the Status Bar down with your finger to view the Notifications Panel.

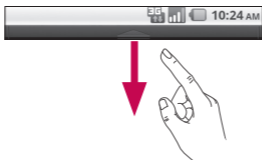

Or on the Home screen, touch the **Menu Key** and select **Notifications**. All ongoing and activity based notifications will be displayed on the Notifications Panel.













Viewing the Status Bar

















The Status Bar uses different icons to display phone information, such as signal strength, new messages, battery life, and active Bluetooth and data connections.

Below is a table explaining the meaning of icons you are likely to see in the Status Bar.



[Status Bar]

Icon	Description
	No SIM card installed
	No signal
	Indicates that your phone is connected to a 3G network
	Indicates that your phone is connected to a EDGE network
	Indicates that your phone is connected to a GPRS network
	Indicates your signal strength (the more bars, the stronger the signal strength)
	Airplane mode is on
	Connected to a Wi-Fi network
	A wired headset is connected
	Call in progress
	Call hold
	Speakerphone is on

Icon	Description
	Phone microphone is muted
	Missed call
	Bluetooth is on
	Connected to a Bluetooth device
	System warning
	An alarm is set
	New voicemail available
	Ringer is silenced
	Vibrate mode is on
	Battery fully charged
	Battery is charging
	Phone is connected to PC via USB cable
	Downloading data
	Uploading data
	GPS is on
	Receiving location data from GPS

Icon	Description
	3 more notifications not displayed
	Data is syncing
	Download finished
	New Gmail message
	New Google Talk message
	New text or multimedia message
	Song is playing
	Upcoming event
	USB tethering is active
	Portable Wi-Fi hotspot is active
	Both USB tethering and portable hotspot are active

On-screen Keyboard

You can enter text using the on-screen keyboard. The on-screen keyboard displays automatically on the screen when you need to enter text. To manually display the keyboard, simply touch a text field where you want to enter text.

Text Input Methods

- **Swype:** Swype™ is a text input method that allows you to enter a word by sliding your finger from letter to letter, lifting your finger between words. To switch to the **Swype** keyboard, touch and hold a text field, then touch **Input method > Swype**.
- **Android keyboard (default):** The Android keyboard can also be used to enter text. To switch to the Android keyboard, touch and hold a text field, then touch **Input method > Android keyboard**.

Using the Swype Keyboard

The Swype™ keyboard uses error correcting algorithms and also includes a predictive text system.



Toggles from
123/ABC Mode
to SYM Mode

Allows you to view
Swype Tips and Help.

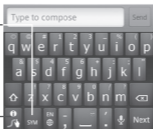

Swype Text Entry Tips

You can access Swype Tips and watch a tutorial on using Swype. You can also use the following Swype text entry tips.

- Create a squiggle (like an S shape) to create a double letter (such as pp in apple).
- Touch and hold a key to enter the alternate letter or symbol located at the top right corner of the key.
- Move your finger over the apostrophe to enter contractions.
- Double-touch on the word you want to change or correct a misspelled word.
- Touch the Delete Key to erase one character. Touch and hold the Delete Key to erase an entire word.

Swype Settings

To configure Swype settings:

1. From the Home screen, press the **Menu Key > Settings > Language & keyboard > Swype**.
2. The following Swype settings are available:

Preferences settings

Preferences settings provide access to Swype operation preferences.

- **Language:** Allows you to select what languages can be used in Swype.
- **Word prediction:** Uses a built-in word database to predict words while entering text in Swype.
- **Audio feedback:** Turns sounds generated by the Swype application on and off.
- **Vibrate on keypress:** Activates a vibration sensation as you enter text using the keypad.
- **Enable tip indicator:** Turns on an on-screen flashing indicator that provides helpful user information.

Swype Advanced Settings

Swype Advanced settings provides access to Swype advanced operation settings.

- **Auto-spacing:** Automatically inserts a space between words. When you finish a word, just lift your finger and start the next word.
- **Auto-capitalization:** Automatically capitalizes the first letter of a sentence.
- **Show complete trace:** Sets the length of time the word trace line remains on-screen as you swipe across the screen.
- **Word choice window:** Sets the amount of times the word choice selection window displays on the screen. Move the slider between **Never** or **Always** and touch **OK**.

- **Speed vs. accuracy:** Sets how quickly Swype responds to on-screen input. Move the slider between **Fast Response** (speed) or **Error Tolerance** (accuracy) and touch **OK**.

Help

This menu provides help and a tutorial to guide you through the process.

- **Swype help:** Displays the Swype User Manual.
- **Tutorial:** Provides an on-screen tutorial.

About

The About section provides the current software version for the Swype application.

Google Account Set-up

The first time you open a Google application on your phone, you will be required to sign in with your existing Google account. If you do not have a Google account, you will be prompted to create one.

Creating your Google account

1. On the Home screen, touch the **Applications tab**  to open the applications menu.
2. Touch **Gmail** and then touch **Next > Create** to start the Gmail set up wizard.
3. Touch a text field to open the keyboard and enter your name and username for your Google account. When entering text, you can move to the next text field by touching **Next** on the keyboard.
4. When you have finished inputting your name and username, touch **Next**. Your phone then communicates with Google servers and checks for username availability.
5. Enter and re-enter your password. Then follow the instructions and enter the required and optional information about the account. Wait while the server creates your account.

Signing in to your Google account

1. Enter your e-mail address and password, then touch **Sign in**.
2. After signing in, you can use Gmail and take advantages of Google services on your phone.
3. Once you have set up your Google account on your phone, it will be automatically synchronized with your Google account on the web (depending on your synchronization settings).

After signing in, you can use Gmail, Google Calendar, and Android Market; download applications from Android Market; back up your settings to Google servers; and take advantage of other Google services on your phone.

IMPORTANT!





- Some applications, such as Calendar, only work with the first Google account you add. If you plan to use more than one Google account with your phone, be sure to sign into the one you want to use with these applications first. When you sign in, your Contacts, Gmail messages, Calendar events and other information from these applications and services on the web are synchronized with your phone. If you don't sign into a Google account during setup, you will be

prompted to sign in or to create a Google account the first time you start an application that requires one, such as Gmail or Android Market.

- If you want to use the backup feature to restore your settings to this phone from another phone that was running Android OS 2.2 Froyo or later, you must sign into your Google account now, during setup. If you wait until after setup is complete, your settings will not be restored.
- If you have an enterprise account through your company or other organization, your IT department may have special instructions on how to sign into that account.

Calls/Contacts

Making a voice call

1. Touch  to open the keypad.
2. Enter the number on the keypad. To delete a digit, touch the **Clear** icon .
3. Touch the **Call** icon  to make a call.
4. To end a call, touch the **End** icon .

TIP! To enter "+" to make international calls, touch and hold down .

TIP! To bring up the keypad during a call, touch **Dialpad**.

Calling your contacts

1. From the Home screen, touch  and choose the **Contacts** tab.
2. Scroll through the contact list or enter the first letter(s) of the contact you want to call by touching the **Search Key**.
3. In the list, touch the contact you want to call.

Answering and rejecting a call





When your phone rings, drag the **Accept** icon  to the right.

Drag the **Reject** icon  to the left to reject an incoming call.

Adjusting call volume

To adjust the in-call volume, use volume up and down keys on the right side of the phone.

Making a second call

1. During your initial call, touch **Add call** .
2. Dial the number or search your contacts to select the number you want to call.
3. Touch the **Call** icon  to connect the call.
4. Both calls will be displayed on the call screen. Your initial call will be put on hold.
5. Touch **Swap**  to toggle between calls.
NOTE: You can touch **Merge calls**  to make a conference call.
6. To end active calls, touch the **End** icon .

Viewing your call logs

On the Home screen, touch  and choose the **Call log** tab. View a complete list of all dialed, received and missed calls.

TIP! Touch any single call log entry to view the date, time, and duration of the call.

TIP! Touch the **Menu Key**, then touch **Clear call log** to delete all the recorded items.

Call settings

You can configure phone call settings, such as call forwarding and other special features offered by your carrier.

1. On the Home screen, touch the **Applications tab** to open the applications menu.
2. Touch **Settings**.
3. Touch **Call settings** and choose the options that you want to adjust.

< Fixed Dialing Numbers >

Select **Fixed Dialing Numbers** to enable the function and compile a list of numbers that can be called from your phone. You'll need your PIN2 code, which is available from your service provider. Only numbers within the fixed dial list can be called from your phone.

< Voicemail >

Voicemail service – Allows you to select your voicemail service.

Voicemail settings – If you are using your carrier's voicemail service, this option allows you to enter the phone number to use for listening to and managing your voicemail.

< Other call settings >

TTY mode – Allows you to activate TTY mode to communicate with a TTY device.

Call forwarding – You can configure how your calls are forwarded when you are on the phone, when you don't answer, and so on.

Call barring – Select when you would like calls to be barred. Enter the call barring password. Please check with your network operator about this service.

Additional settings – This lets you change the following settings:

- **Caller ID:** Choose whether to display your number on an outgoing call.
- **Call Waiting:** If call waiting is activated, the handset will notify you of an incoming call while you are on the phone (depending on your network provider).

Call duration – View the duration of all calls including all calls, dialed calls, received calls, and the last call.



Contacts

You can add contacts on your phone and synchronize them with the contacts in your Google account or other accounts that support syncing contacts.

Searching for a contact

1. On the Home screen, touch the **Applications tab** > **Contacts** or touch  and choose the **Contacts** tab.
2. Touch the **Menu Key** > **Search** and enter the contact name using the keypad.

Adding a new contact

1. On the Home screen, touch  and enter the new contact's number. Then touch the **Menu Key** > **Add to contacts** > **Create new contact**.
2. If you want to add a picture to the new contact, touch . Choose from **Take photo** or **Select photo from Gallery**.
3. Touch a name fields to open the touch keyboard and enter the contact's name.
4. Touch a category of contact information and enter the details about your contact.
5. Touch **Done** to save the contact.

Favorite contacts

You can classify frequently called contacts as favorites.

To add a contact to your favorites:

1. On the Home screen, touch  and choose the **Contacts** tab.
2. Touch a contact to view their details.
3. Touch the star to the right of the contact's name. The star turns gold.

To remove a contact from your favorites list:

1. On the Home screen, touch .
2. Touch the **Favorites** tab and choose a contact entry to view its details.
3. Touch the gold star to the right of the contact's name. The star turns grey and the contact is removed from your favorites.

Messaging/E-mail

Messaging

Your LG-P999 combines SMS and MMS into one intuitive, easy-to-use menu.

Sending a message

1. On the Home screen, touch the **Applications tab** > **Messaging** > **New message** to open a blank message.
2. Enter a contact name or number in the **To** field. As you enter the contact name or number, matching contacts appear. You can also touch a suggested recipient. You can add multiple contacts.

NOTE: You will be charged for a text or multimedia message for every person you send the message to.

3. Touch the message field to start entering your message.
4. Touch **Send** to send your message.

The message screen opens, with your message after your name. Responses appear on the screen. As you view and send additional messages, a message thread is created.

! WARNING: The 160-character limit may vary from country to country depending on how the SMS is coded and the language.

! WARNING: If an image, video or audio file is added to an SMS message, it will be automatically converted into an MMS message and you will be charged accordingly.

NOTE: If you get an SMS message during a call there will be ring notification.

Changing your message settings

Your LG-P999 message settings are predefined, so you can send messages immediately. You can change the settings based on your preferences.

From the Home screen, touch the **Applications tab** > **Messaging** > **Menu Key** > **Settings**.

Opening your email and email accounts screen

You can use the **Email** application to read email from services other than Gmail. The **Email** application supports the following account types: POP3, IMAP and Exchange.

1. On the Home screen, touch the **Applications tab** > **Email**.
2. The first time you open the **Email** application, a setup wizard opens to help you add an email account.
3. After initial setup, **Email** displays the contents of your **Inbox** (if you have only one account) or the **Accounts** screen (if you have multiple accounts).

TIP!

- If you press and hold an account from the list of email accounts, you can select the desired option in the pop-up window. For example, select **Account settings** to open that account's settings menu.

The Accounts screen

The **Accounts screen** lists your **Combined Inbox** and each of your email accounts.

1. Open the **Email** application. If you're not on the email account screen, touch the **Menu Key** and touch **Accounts**.
2. The **Combined Inbox** is displayed. The account from which you send email by default is indicated with a checkmark.

To open your Combined Inbox:

If you have configured email to send and receive email from more than one account, you can view all messages sent to all accounts in your **Combined Inbox** and all of your accounts will be displayed.

1. Open the **Email** application.
2. Touch **Combined Inbox** (in the **Accounts** screen).
Messages in the **Combined Inbox** are color coded along their left sides, by account, using the same colors that are used for your accounts in the **Accounts** screen.

Only your account's most recent emails are downloaded to your phone. To download more (earlier) email messages, touch **Load more messages** at the bottom of the emails list.

Composing and sending email

To compose and send a message:

1. While in the **Email** application, touch the **Menu Key** and touch **Compose**.
2. Enter an address for the message's intended recipient. As you enter text, matching addresses are offered from your contacts. Separate multiple addresses with commas.
3. Touch the **Menu Key** and touch **Add Cc/Bcc** to be able to Cc or Bcc other contacts/email addresses.
4. Enter the text of the message.
5. Touch the **Menu Key** and then **Add attachment** to attach the file you want to share with your message.
6. Touch **Send**.

If you're not ready to send the message, touch **Save as draft** to save it in a Drafts folder. Touch a draft message in a Drafts folder to resume working on it. Your message will also be saved as a draft if you touch the **Back Key**  before sending it. Touch **Discard** to abandon and delete a message, including any saved drafts. If you aren't

connected to a network, for example, if you're working in Airplane Mode, the messages that you send are stored in your **Outbox** folder until you're connected to a network again. If it contains any pending messages, the Outbox is displayed on the Accounts screen.

Please note that messages sent using an Exchange account will not be located on the phone; they will, however, be located on the Exchange server itself.

If you want to see your sent messages in the **Sent** folder you will often need to open the Sent folder and select **Refresh** from the options menu.

Working with account folders

Each account has **Inbox**, **Outbox**, **Sent**, **Drafts**, **Trash** and **Junk** folders. Depending on the features supported by your account's service provider, you may have additional folders.

Adding and editing email accounts

To add an email account:

1. From the Accounts screen, touch the **Menu Key** and touch **Add account**.
2. Select **MS Exchange** or **Others**.
3. Enter your email address, password, and any other relevant information and touch **Next**.

4. Enter a name for the account, confirm how you want your name to appear in outgoing mail, then touch **Done**.

To change account settings:

1. Open the **Accounts** screen.
2. Touch and hold the account which you want to change the settings of. In the menu that opens, touch **Account settings**.

To delete an email account:

1. Open the **Accounts** screen.
2. Touch and hold the account you want to delete.
3. Touch **Remove account** in the menu that opens.
4. Touch **OK** in the dialog box to confirm that you want to delete the account.

Camera

Getting to know the viewfinder

Zoom - Zoom in or zoom out. Alternatively, you can use the volume keys.

Swap Camera - You can swap between the front-facing camera and the back-facing camera.

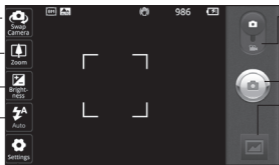

Video mode - Slide this icon down to switch to video mode.

Capture - Takes a photo.

Gallery - Touch to view the last photo you captured. This enables you to access your Gallery and view saved photos from within camera mode.

Settings - Touch this icon to open the settings menu. See Using the advanced settings.

Flash - Allows you to turn on the flash when taking a photo in a dark place.

Brightness - This defines and controls the amount of sunlight entering the image. Slide the brightness indicator along the bar towards "-" to lower the brightness of the image or towards "+" to increase it.

TIP! You can close all the shortcut options to give a clearer viewfinder screen. Just touch the center of the viewfinder once. To recall the options, touch the screen again.

NOTE: You cannot enable the zoom or flash functions when using the front-facing camera.

Using the focus mode

You can select the focus mode from the following options:



Auto – Set the camera to focus automatically.

Macro – Macro mode allows you to take extreme close-ups. If you are trying to take a close-up shot but the focus box remains red, try turning Macro mode on.

Face tracking – If you set Face tracking and take a photo, your camera detects and focuses on human faces automatically.

Manual – Set the camera to focus manually.

Taking a quick photo

1. Open the **Camera** application.
2. Holding the phone horizontally, point the lens towards the subject you want to photograph.
3. Touch and hold the **Capture** icon .
4. The camera brings the image into focus. When the image is in focus, the focus indicators in each corner turn green. Lift your finger from the Capture icon  to take the picture.

Notice: A shading issue where the center and sides of the image have a color difference may occur when you try to take a picture indoors due to the characteristics of the camera.

Once you've taken the photo

Your captured photo will appear on the screen.

Share Touch to share your photo as **Bluetooth, Email, Facebook, Gmail, Messages, Picasa, Twitter.**

NOTE: Additional charges may apply when MMS messages are uploaded and/or downloaded while roaming.

TIP! If you have a social networking site account and set it up on your phone, you can share your photos to your community.

Set as Touch to set the image as a **Contact icon** or **Wallpaper.**

Rename Touch to edit the name of the selected picture.

 Touch to delete the image.

 Touch to take another photo immediately. Your current photo will be saved.

 Touch to view last photo you captured.

Using the advanced settings

In the viewfinder, touch  to open all advanced options.

Image size – Touch to set the size (in pixels) of the picture you are taking. Select a pixel value from the following options: 8M (3264X2448), 5M (2560X1920), 3M (2048x1536), 2M (1600x1200), 1M (1280x960), VGA (640x480), QVGA (320x240).

NOTE: Options for **Image size** vary depending on the camera mode.

Focus – Touch this icon to set the Focus mode. See Using the focus mode.

Scene mode – Choose from **Auto**, **Portrait**, **Landscape**, **Sports**, **Sunset** and **Night**.

ISO – The ISO rating determines the sensitivity of the camera's light sensor. The higher the ISO, the more sensitive the camera will be. This is useful under darker conditions when you cannot use the flash. Select from ISO values of **Auto**, **100**, **200**, **400** and **800**.

White balance – Choose from **Auto**, **Incandescent**, **Sunny**, **Fluorescent**, and **Cloudy**.

Color effect – Choose a color tone for your new photo.

NOTE:

- Options for Color effect vary depending on the camera mode.

- Solarize and Beaty blur for Color effect are only supported in the front-facing camera mode.
- Blue, Emboss, Posterize, and Vivid for Color effect are supported only in back-facing camera mode.

Timer – The self-timer allows you to set a delay after the shutter is pressed. Select **Off**, **3 secs**, **5 secs**, and **10 secs**. This is ideal if you want to be included in a photo.

Shot mode – Select various shooting mode from the options. Choose from **Normal**, **Continuous shot**, **Out-focusing shot**, **Smile shot**, **Beauty shot**, **Art shot**, **Panorama shot** and **Stitch shot**.

Image Quality – Choose from **Super fine**, **Fine**, and **Normal**. The finer the quality, the sharper the photo. However, the file size will increase as a result, which means you'll be able to store fewer photos in the memory.

Stabilization – Select **On** to compensate for unsteady hands.



Auto review – If you set Auto review to **On**, the picture you have just taken is automatically displayed.

Shutter sound – Select one of the four shutter sounds.

Tag location – Activate to use your phone's location-based services. Take pictures wherever you are and tag them with the location. If you upload tagged pictures to a blog that supports geo-tagging, you can see the pictures displayed on a map.

NOTE: This function is available when GPS is active.

Storage – Choose whether to save your photos to the phone memory or to the external memory.

-  Restore all camera default settings.
-  Touch whenever you want to know how a function operates. This is provide you a quick guide.

TIP! When you exit the camera, all settings will return to their defaults, except Image size and Image Quality. Any non-default settings must be reset, such as color effect and ISO. Check these before you take your next photo.

TIP! The settings menu is superimposed over the viewfinder, so when you change elements of the image color or quality, you will see a preview of the image change behind the settings menu.

Viewing your saved photos

1 You can access your saved photos from within the camera mode. Just touch  and your gallery will appear on the screen. Touch the screen to view additional options for the image.

 Touch to see a slideshow of your pictures.

 Touch **Menu** and select the options you want. You can share the contents or delete a photo. Touch **More** for the options below.

Details - Check picture information.

Set as - Set as contact icon or wallpaper.

Crop - Crop your photo. Move your finger across the screen to select the area.

Rotate - Rotate left or right.

Video camera

Getting to know the viewfinder

Zoom - Zoom in or zoom out. Alternatively, you can use the volume keys.

Note: You can use the zoom function during recording but please note that the button noise may be heard during video playback.

Swap Camera - You can swap between the front-facing camera and the back-facing camera.

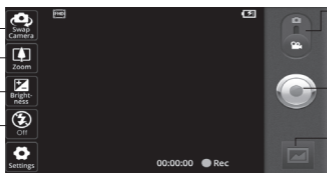

Camera mode - Slide this icon up to switch to camera mode.

Record - Starts recording.





Gallery - Touch to view the last video you recorded. This enables you to access your Gallery and view your saved videos from within video mode.

Settings - Touch this icon to open the settings menu. See Using the advanced settings.

Flash - Allows you to turn on the flash when taking a video in a dark place.

Brightness - This defines and controls the amount of sunlight entering the video. Slide the brightness indicator along the bar towards "-" to lower the brightness of the video or towards "+" to increase it.

Recording a quick video

1. Open the **Camera** application and slide the camera mode button down to the **Video** position. The **Capture** icon  will change to .
2. The video camera viewfinder will appear on the screen.
3. Holding the phone horizontally, point the lens towards the subject of the video.
4. Touch the **Record** icon .
5. REC will appear at the bottom of the viewfinder with a timer showing the length of the video.
6. Touch the **Stop** icon  to stop recording.

After recording a video



A still image representing your video will appear on the screen.

Play Touch to play the video.

Share Touch to share your video as **Bluetooth, Email, Gmail, Messaging,** and **YouTube.**

NOTE: Additional charges may apply when MMS messages are uploaded and/or downloaded while roaming.

Rename Touch to edit the name of the selected video.

-  Touch to delete the video you just made and confirm by touching **OK**. The viewfinder will reappear.
-  Touch to record another video straight away. Your current video will be saved.
-  Touch to view the last video you recorded.

Using the advanced settings

Using the viewfinder, touch  to open all the advanced options.

Video size – Touch to set the size (in pixels) of the video you record. Choose your video image size from Full HD (1920x1088), HD (1280x720), TV (720x480), VGA (640x480), QVGA (320x240) and QCIF (176x144).

White balance – The white balance ensures any white areas in your video are realistic. To enable your camera to adjust the white balance correctly, you may need to determine the light conditions. Choose from **Auto**, **Incandescent**, **Sunny**, **Fluorescent**, and **Cloudy**.

Color effect – Choose a color tone to use for your new video.

NOTE: Depending to the camera mode, the supported color effect options are different between the front-facing camera

and back-facing camera.

Video quality – Choose from **Super fine**, **Fine** and **Normal**.

- **Super Fine:** Records videos at a super fine video quality.
- **Fine:** Records videos at a fine video quality.
- **Normal:** Records videos at a normal video quality.

Duration – Set a duration limit for your video. Choose between Normal and MMS to limit the maximum size to send as an MMS message.

Voice – Choose **Mute** to record a video without sound.

Auto review – If you set to **On**, the video you have just recorded is automatically displayed.

Storage – Choose whether to save your video to the phone memory or to the external memory.

 Reset all the video camera settings.

 Touch whenever you want to know how a function operates. This is provide you a quick guide.

NOTE: DTS effect could increase background noise excessively if the video is recorded in a quiet environment. If you experience white noise while playing a video, please turn off the DTS effect.

Watching your saved videos

1. In the viewfinder, touch .
2. Your Gallery will appear on the screen.
3. Touch a video once to start to playing it automatically.

Adjusting the volume when viewing a video

To adjust the volume of a video while it is playing, use the volume keys on the right side of the phone.

Video camera

Gallery

You can store any multimedia files on your phone's memory in your **Gallery** so that you have easy access to all of your pictures, sounds, videos and games. You can also save your files to your external memory card. The advantage of using a memory card is that you can free up space on your phone memory.

Touch the **Applications** tab and select **Gallery**.

To change how the contents of an album are displayed

You can view the images and videos in your albums in a chronological grid or in stacks, sorted by the date and the location where they were taken. Use the Album View switch  at the top right of the screen to switch between grid and stack view.

 Drag the Album View switch to the left to view the album contents in a chronological grid.

 Drag the Album View switch to the right to view the contents of the album in stacks.

Using Smart Share

SmartShare provides you a better way to enjoy multimedia contents with other DLNA(Digital Living Network Alliance) enabled devices.

* Share your media contents to other DLNA devices (DMS)

1. On the Home screen, touch the **Applications tab** and select **Settings**.
2. Touch **Wireless & networks** and **SmartShare settings**
3. Touch the **SmartShare** checkbox to turn the function on.
4. You can change your device name and select the sharing content types.

* **Let your renderer device (e.g. TV) play multimedia contents from remote content library (e.g. PC)**

1. Touch the **Applications tab** and then **SmartShare**.
2. Touch the top right button to select the device from renderer lists.
3. Touch the top left button and select one of the remote content library.
4. You can browse the remote content library.
5. Touch and hold a content thumbnail and flick them to the top area by your finger or touch the play button.





Notice: Check that your device is connected with your home network using Wi-Fi connection to use this application.

Notice: Some DLNA enabled devices (e.g. TV) support only the Digital Media Player (DMP) feature of DLNA. The device (e.g. TV) will not appear in the renderer list if it only supports the DMP feature.

Music

Your LG-P999 has a music player that lets you play all your favorite tracks. To access the music player, touch the **Applications tab** and then **Music**.

Playing a song

1. On the Home screen, touch the **Applications tab** and select **Music**.
2. Touch **Songs**.
3. Select the song you want to play.
4. Touch  to pause the song.
5. Touch  to skip to the next song.
6. Touch  to go back to the first part of the song. Touch  twice to go back to the previous song.

To change the volume while listening to music, touch the up and down volume keys on the right side of the phone.

Touch and hold any song in the list, then choose from the following options: **Play**, **Add to playlist**, **Use as ringtone**, **Delete**, **Search**.

NOTE: Music file copyrights may be protected by international contracts and national copyright laws. Therefore, it may be necessary to obtain permission or a licence to reproduce or copy music. In some countries, national laws prohibit private copying of copyrighted material. Before downloading or copying the file, please check the national laws of the relevant country concerning the use of such material.

Transferring files using USB mass storage devices

To transfer files using USB devices:

1. Connect the LG-P999 to a PC using a USB cable.
2. If you have not installed the LG Android Platform Driver on your PC, you will need to change the settings manually. From the Home screen, touch the **Applications tab** > **Settings** > **SD card & phone storage** > **Mass storage only**. A checkmark indicates the function is activated.
3. Touch **Turn on USB storage** > **OK**..
4. You can view the mass storage contents on your PC and transfer files to and from the PC.

NOTE:

- If you installed the LG Android Platform Driver, you will see the '**Turn on USB storage**' screen immediately.
- If you want to synchronize your phone with your PC using the LG PC Suite after using the USB mass storage function, from the Home screen, touch the **Applications tab > Settings > SD card & phone storage**, then touch **Mass storage only** to remove the checkmark and turn the function off.

How to save music/video files to your phone

1. Connect your phone to the PC using the USB cable.
 - Touch **Turn on USB storage > OK**. On the PC, select **Open folder to view files**.
 - If you have not installed the LG Android Platform Driver on your PC, you will need to set it manually. For more information, refer to 'Transferring files using mass storage devices'.
2. Save music or video files from your PC to the phone's removable storage.
 - You may copy or move files from your PC to the phone's removable storage using a card reader.
 - If there is a video file with a subtitle file (.smi or .srt file with the same name as the video file), place them in

the same folder to display the subtitle automatically when playing the video file.

- When downloading music or video files, copyright must be secured. Please note that a corrupted file or file with a wrong extension may cause damage to your phone.

How to send data from your phone via Bluetooth

You can send data via Bluetooth by running a corresponding application, rather than from the Bluetooth menu as with normal mobile phones.

- **Sending pictures:** Open the **Gallery** application and select a picture. Then touch **Menu > Share > Bluetooth**. If Bluetooth is off, touch **Bluetooth** to turn it on. A checkmark indicates the function is active. Then touch **Scan for devices** and choose the device you want to send data from the list.
- **Exporting contacts:** Open the **Contacts** application. Touch the contact you want to share. Touch the **Menu > Import / Export > Share visible contacts > Bluetooth**. If Bluetooth is off, touch **Bluetooth** to turn it on. A checkmark indicates the function is active. Then touch **Scan for devices** and choose the device you want to send data from the list.
- **Connecting to FTP (Only the FTP server is supported**

on this handset): Touch the **Applications tab > Settings > Wireless & networks > Bluetooth settings**. Then select the **Discoverable** check box and search for other devices. Find the service you want and connect to the FTP server.

TIP! The version of Bluetooth used by this device is Bluetooth 2.1 EDR and certified by Bluetooth SIG. It is compatible with other Bluetooth SIG certified devices.

NOTE: If you want to search for this phone from other devices, touch the **Applications tab > Settings > Wireless & networks > Bluetooth settings**. Then select the **Discoverable** check box. Your device will now be detectable for 120 seconds.

NOTE: The supported Bluetooth profiles are SDAP, HFP, HSP, OPP, PBAP (server), FTP (server), A2DP, and AVRCP.

Google applications

In order to take advantage of Google applications, you must first set up a Google account. You have the option to create a new account or sign in to an existing account.

After signing in to your account, your contacts, email and calendar in your Google account will automatically synchronize with your LG-P999.

Google Maps™

Check your current location and traffic and receive directions to your destination. Your phone must be connected to Wi-Fi or 3G/GPRS.

NOTE: Google Maps does not cover all cities and countries.

When the Google Maps application is open, touch the **Menu Key** for the following options: **Search**, **Directions**, **Starred Places**, **Clear Map**, **Join Latitude**, and **More** (Labs, Cache Settings, Help, Terms, Privacy & Notices, and About).

Market™

Android Market lets you download useful applications and games. If you install applications and games from Android Market, they appear in the LG-P999 applications menu. You can check downloaded applications by touching the **Menu Key > My apps**.

Gmail™

Gmail can be configured when you first set up your phone. Depending on your synchronization settings, Gmail is automatically synchronized on your phone with your Google account on the web. The inbox conversations list is your default Gmail view.

Touch the **Menu Key** > **Refresh** to send or receive new emails and to synchronize your emails with your Google account on the web. With the **Menu Key**, you have options to compose an email, add accounts, go to labels, search, etc.

Google Talk™

Google Talk is Google's instant messaging program. It lets you communicate with other people who also use Google Talk.

Touch the **Menu Key** and choose from the following options: **All friends, Add friend, Search, Sign out, Settings**, and **More** (Close all chats, Invites, and Blocked).

Google Search™

Touch the **Menu Key** and touch **Search settings** to configure Google search, including setting which data on your phone you want to be able to search.

< Web >

Touch **Google search** to adjust the following Google search settings.

Show web suggestions – Touch to display suggestions for Google web searches below the Google search box as you type.

Use My Location – Touch to include your location when using Google search and other Google services. When you choose this option, you are asked whether you consent to allowing Google to use your location when providing these services.

Search history – Touch to use suggestions from web-based Google search history from your Google account.

Manage search history – Opens the browser with a web-based interface for viewing and managing the web search history associated with your Google account.

< Phone >

Searchable items – Opens a screen where you can types the types of data you are able to search for on your phone.

Clear shortcuts – Erases the list of previously chosen search results that appear as suggestions below the Google search box.



YouTube™

The YouTube application allows you to watch or upload videos.

NOTE: You can access YouTube with your Google account but you need a YouTube account for some services, such as video uploading.

Utilities

Setting your alarm

1. On the Home screen, touch the **Applications tab** and select **Clock**.
2. If you want to add a new alarm, touch  > **Add alarm**.
3. Set the Time, Repeat, and Ringtone for the alarm. You can also touch the **Vibrate** check box  to set the alarm to vibrate along with the ringtone and **Label** to add a name to the alarm.
4. Touch **Done** to turn on the alarm.

NOTE: To change the alarm settings on the alarm list screen, touch the **Menu Key** and select **Settings**. You can choose from the following options: **Alarm in silent mode**, **Alarm volume**, **Snooze duration**, and **Side button behavior**.

Using your calculator

1. On the Home screen, touch the **Applications tab** and select **Calculator**.
2. Touch the number keys to enter numbers.
3. For simple calculations, touch the function you want (+, -, x, or ÷), followed by =.
4. For more complex calculations, touch the **Menu Key** and select **Advanced panel**.

Adding an event to your calendar

1. On the Home screen, touch the **Applications tab** and select **Calendar**.

NOTE: You must first create a Google account to use **Calendar**.

2. To view an event, touch the date. Touch and hold a date if you want to add a new event. Then touch **New event**.
3. Touch the **What** field and, then enter the event name. Check the date and enter the time you want your event to begin and finish.
 1. Touch the **Where**, field and enter the location.
 2. If you would like to add a note to your event, touch the **Description** field and enter the details.
 3. If you want to repeat the alarm, set **Repetition**. You can also set **Reminders**, if necessary.
4. Touch **Done** to save the event in the calendar. A colored square in the calendar will mark all days that have saved events. An alarm will sound at the event start time to help you stay organized.

The Web







Browser

The Browser gives you a fast, full-color world of games, music, news, sports, entertainment and much more, right on your mobile phone; wherever you are and whatever you're into.

NOTE: Additional charges apply when connecting to these services and downloading content. Check data charges with your network provider.

Using options

Touch the **Menu Key** to view the following options:

-  **New window:** Opens a new window.
-  **Bookmarks:** Displays your bookmarks, most visited site, and history.
-  **Windows:** Displays all your open windows.
-  **Refresh:** Touch to refresh the web page.
-  **Forward:** Go forward to the page you connected to after the current page. The **Back Key** takes you to the previous page.
-  **More**
 - **Add bookmark:** Add the current web page as a bookmark.
 - **Find on page:** Allows you to find letters or words on the current web page.

- **Select text:** Allows you to copy any text from the web page.
- **Page info:** Displays the web page information.
- **Share page:** Allows you to share the web page with others.
- **Downloads:** Displays your download history.
- **Settings:** Allows you to change the web browser settings.

NOTE: To return the previous page, touch the **Back Key**.

Settings

On the Home screen, touch the **Applications tab** and touch **Settings**.

Wireless & networks

This menu allows you to manage Wi-Fi and Bluetooth. You can also set Mobile networks and Airplane mode.

Airplane mode – All wireless connections will be disabled if Airplane mode is enabled.

Wi-Fi – Touch to turn on Wi-Fi to connect to any available Wi-Fi networks.

Wi-Fi settings – Allows you to set up and manage wireless access points. Set Network notification or add a Wi-Fi network. The advanced Wi-Fi settings screen is accessed from the Wi-Fi settings screen. Touch the **Menu Key** and touch **Advanced**.

TIP! How to obtain the MAC address

To set up a connection in some wireless networks with MAC filters, you may need to enter the MAC address of your LG-P999 into the router.

You can find the MAC address by touching the **Applications tab > Settings > Wireless & networks > Wi-Fi settings**. Then touch the **Menu Key > Advanced > MAC address**.

SmartShare – Touch to turn on **SmartShare** to share your multimedia contents with your DLNA (Digital Living Network Alliance) enabled devices.

SmartShare settings – Allows you to change the device name and select the content type to be shared.

Bluetooth – Touch to turn on Bluetooth to connect to Bluetooth devices.

Bluetooth settings – Set the device name, Discoverable mode, and scan for other devices. You can also check a list of Bluetooth devices that you've previously configured and those detected when the phone last scanned for Bluetooth devices.

Tethering & portable hotspot – You can configure the settings for USB tethering and Portable Wi-Fi hotspot.

VPN settings – Displays the list of Virtual Private Networks (VPNs) that you've previously configured. Allows you to add different types of VPNs.

Mobile networks – Set options for Data roaming, Network mode and operators, and Access Point Names (APNs).

Call settings

Use this menu to configure phone call settings.

< Voicemail >

Voicemail service - Allows you to select your carrier's voicemail service or another service, such as Google Voice™.

Voicemail settings - If you are using your carrier's voicemail service, this option allows you to enter the phone number to use for listening to and managing your voicemail. You can enter a comma (,) to insert a pause into the number. For example, to add a password after the phone number. If you are using Google Voice, this opens a screen where you can view the Google Voice number or sign out of Google Voice.

< Other call settings >

TTY mode - Allows you to set TTY mode to communicate with other TTY devices.

Call forwarding - Allows you to enable and disable call forwarding and enter the phone number you wish to forward calls to.

Additional settings - Allows you to configure Caller ID and Call Waiting.

Call duration - Allows you to view the duration for your last call, all calls, dialed calls, and received calls.

Sound

< General >

Silent mode – Allows you to silence all sounds (including call and notification ringtones) except the audio from music, videos, and any alarms you have set (You must silence media and alarms in their own applications).

Vibrate – Allows you to set your phone to vibrate when you receive an incoming call.

Volume – Allows you to set the volume for ringtones, media and alarms. If you uncheck the option to use the same volume for both calls and notifications, you can set both volumes separately.

< Incoming calls >

Phone ringtone – Allows you to set your default incoming call ringtone.

< Notifications >

Notification ringtone – Allows you to set your default notification ringtone.

< Feedback >

Audible touch tones – Allows you to set the phone to play tones when using the keypad to dial numbers.

Audible selection – Allows you to set your phone to play a sound when you touch buttons, icons, and other on-screen items that react to your touch.

Screen lock sounds – Allows you to set your phone to play a sound when locking and unlocking the screen.

Haptic feedback – Allows you to set your phone to vibrate briefly when you touch the **Menu Key**, **Back Key**, and perform other actions.

Display

Brightness – Allows you to adjust the brightness of the screen.

Auto-rotate screen – Allows you to set the orientation to automatically switch to landscape mode or portrait mode when you turn the phone sideways or upright.

Animation – Allows you to set animated transitions when navigating from screen to screen.

Screen timeout – Allows you to adjust the delay time before the screen automatically turns off. For the best battery performance, use the shortest convenient timeout.

Location & security

< My Location >

Use wireless networks – If you select **Use wireless networks**, your phone will determine your approximate location by using Wi-Fi and mobile networks.

Use GPS satellites – If you select **Use GPS satellites**, your phone will determine your location to street-level accuracy.

< Screen unlock >

Set up screen lock – Allows you to set an unlock pattern to secure your phone. Choosing **Pattern** opens a set of screens that guide you through drawing a screen unlock pattern. You can also set a **PIN** or **Password** instead of Pattern or leave it as **None**.

TIP! To lock your screen by using the Pattern Lock

1. The first time you do this, a short tutorial about creating an unlock pattern appears.
2. You are prompted to draw and redraw your own pattern. The next time you turn on your phone or wake up the screen, you will be prompted to draw your unlock pattern to unlock the screen.

< SIM card lock >

Set up SIM card lock – Set up SIM card lock or change the SIM PIN.

< Passwords >

Visible passwords – Select to show passwords as you type them or deselect to hide passwords as you type them.

< Device administration >

Select device administrators – Add or remove device administrators.

< Credential storage >

Use secure credentials – Select to allow applications to access your phone's encrypted store of secure certificates, related passwords and other credentials. You use credential storage to establish some kinds of VPN and Wi-Fi connections. If you have not set a password for credential storage, this setting is dimmed.

Install from SD card – Allows you to install encrypted certificates from a microSD card.

Set password – Allows you to set or change the password for your secure credential storage. Your password must have at least eight characters.

Clear storage – Deletes all secure certificates and related credentials and erases the secure storage password.

Applications

Unknown sources – Permits installation of applications that you obtain from websites, email or other locations other than Android Market.

! WARNING: To protect your phone and personal data, only download applications from trusted sources, such as Android Market.

Manage applications – Manage and remove installed applications.

Running services – Allows you to view and control currently running services and applications. This option displays what processes each running service needs and how much memory it is using.

Development – Allows you to set options for application development, such as **USB debugging**, **Stay awake**, and **Allow mock locations**.

Accounts & sync

<General sync settings >

Background data – Permits applications to synchronize data in the background, whether or not you are actively working in them. Unchecking this setting can save battery power and lowers (but does not eliminate) data use.

Auto-sync – Permits applications to synchronize, send, and receive data on their own schedule.

< Manage accounts >

Displays a list of all Google accounts and other accounts you've added to your phone.

If you touch an account in this screen, the account screen opens.

Privacy

< Backup and restore >

Back up my data – Activate to back up your application data and settings.

Automatic restore – Activating **Automatic restore** will restore backed up settings when you reinstall.

< Personal data >

Factory data reset – If you select **Factory data reset**, it will erase all of your personal data from internal phone storage, including information about your Google account, any other accounts, your system/application data and settings as well as any downloaded applications and DRM license.

Resetting the phone does not erase any system software updates you have downloaded or any files on your microSD card, such as music or photos. If you reset the phone in this way, you are prompted to reenter the same information as when you first started Android.

SD card & phone storage

< USB connection mode >

Mass storage only – Your phone can be used as a mass storage device if you have a memory card inserted. You can set the **Mass storage only** as a default setting for USB connection mode.

<SD card >

Allows you to check the total space and available space on your microSD card. Touch **Unmount SD card** to safely remove the microSD card.

< Phone memory >

Allows you to check the total space and available space on your internal memory. Touch **Unmount Phone memory** to safely remove the internal phone memory.

< Internal phone storage >

Displays the available space for internal phone storage.

Language & keyboard

Use the **Language & keyboard** settings to select the language and region for the text on your phone and for configuring the on-screen keyboard, including words that you have added to the dictionary.

Voice input & output

< Voice input >

Voice recogniser settings –

Use the **Voice recogniser settings** to configure the Android voice input feature.

- **Language** – Opens a screen where you can set the language you use when entering text by speaking.
- **SafeSearch** – Opens a dialog where you can set whether you want Google SafeSearch filter to block some results.
- **Block offensive words** – When unchecked, Google voice recognition will recognize and transcribe words many people consider offensive, when you enter text by speaking. When checked, Google voice recognition replaces those words in transcriptions with a place holder comprised of hash symbols (#).
- **Show hints** – Show hints on search box when you're searching for the contents.

< Voice output >

Text-to-speech settings –

Use the **Text-to-speech settings** to configure the Android text-to-speech synthesizer for applications that can take advantage of it.

NOTE: If you don't have speech synthesizer data installed, only the **Install voice data** setting is available.

- **Listen to an example** – Plays a brief sample of the speech synthesizer, using your current settings.
- **Always use my settings** – Check to use the settings on this screen in place of speech synthesizer settings available in other applications.
- **Default Engine** – Opens a dialog where you can set the text-to-speech application you want to use, if you have more than one installed.
- **Install voice data** – If your phone does not have speech synthesizer data installed, this connects to Android Market and guides you through the process of downloading and installing the data. This setting is not available if the data is already installed.
- **Speech rate** – Opens a dialog where you can select how quickly you want the synthesizer to speak.
- **Language** – Opens a dialog where you can select the language of the text you want the synthesizer to read. This is particularly useful in combination with **Always use my settings** to ensure that text is spoken correctly in a variety of applications.

Accessibility

Use the **Accessibility** settings to configure any accessibility plug-ins you have installed on your phone.

NOTE: Requires additional plug-ins to become selectable.

HDMI

Allows you to adjust the HDMI connection setting. If your phone is connected with TV/PC via HDMI cable, you can see the image and video file through the TV/PC when the video player/image viewer is visible on your phone screen.

NOTE: It may take time to play media files depending on the device connected to your phone. Files may not be played properly when using a cable or device that is not HDMI-certified. The image orientation set in your phone also applies to the image displayed on the device. If your phone data is not displayed properly on the device due to a sync issue, you need to change the resolution of your phone (You need to reboot your phone to reflect the new HDMI resolution).

Date & time

Use **Date & time** settings to set your references for how dates are displayed. You can also use these settings to set your own time and time zone rather than obtaining the current time from the mobile network.

About phone

View legal information and check phone status and software version.

Wi-Fi

With Wi-Fi, you can use high-speed internet access within the coverage of the wireless access point (AP). You can enjoy wireless internet with Wi-Fi, without extra charges.

Turn on Wi-Fi

From the Home screen, touch the **Applications tab** > **Settings** > **Wireless & networks**. Then touch **Wi-Fi** to turn it on. A checkmark indicates that Wi-Fi is on.

To connect to Wi-Fi

Choose the Wi-Fi network you want to connect to. If you see , you need to enter password to connect.

NOTE:

- If you are out of the Wi-Fi area and use your 3G connection, additional charges may be applied.
- If your phone changes to sleep mode, even when connected to Wi-Fi, the Wi-Fi connection will be disabled automatically (in which case, if your phone has access to 3G data, it may be connected to the 3G network automatically and additional charges may be applied).



- The LG-P999 supports WEP, WPA/WPA2-PSK and 802.1x EAP security. If your Wi-Fi service provider or network administrator sets encryption for network security, fill in the key in the pop-up window. If encryption is not set, this pop-up window will not be shown. You can obtain the key from your Wi-Fi service provider or network administrator.

Sharing your phone's mobile data connection

You can share your phone's mobile data connection with a single computer via a USB cable: USB tethering.

You can also share your phone's data connection with up to eight devices at once, by turning your phone into a portable Wi-Fi hotspot: Wi-Fi tethering.

When your phone is sharing its data connection, an icon appears in the Status Bar and as an ongoing notification in the Notifications Panel.

Icon	Description
	USB tethering is active
	Portable Wi-Fi hotspot is active
	Both USB tethering and portable hotspot are active

For the latest information about tethering and portable hotspots, including supported operating systems and other details, visit <http://www.android.com/tether>.

NOTE: An additional costs may be incurred when connecting and using online services. Check data charges with your network provider.

USB tethering & portable Wi-Fi hotspot settings

1. On the Home screen, touch the **Applications tab** and select **Settings**.
2. Touch **Wireless & networks** and select **Tethering & portable hotspot**.
3. Choose the options that you want to use.

USB tethering – Allows you to share your phone's mobile network data connection with your computer via a USB connection

Portable Wi-Fi hotspot – Check to share your phone's mobile network data connection as a portable Wi-Fi hotspot.

Help – Opens a dialog with information about USB tethering and Portable Wi-Fi hotspot as well as information about where to learn more.

Tip: To use USB tethering, you need to install the “LG USB Driver” on to your PC first. The LG USB Driver is downloadable from the following site: http://www.lg.com/ca_en → Click **Support** → **Mobile Phone support** → Select the Model **LGP999** → Click **Install LG Mobile Support Tool** > “install USB Driver”. to download.

To share your phone's data connection via USB

If your computer is running Windows 7 or a recent distribution of some versions of Linux (such as Ubuntu), you typically don't need to prepare your computer for tethering. But if you're running an earlier version of Windows or another operating system, you may need to prepare your computer to establish a network connection via USB. For the most current information about which operating systems support USB tethering and how to configure them, visit <http://www.android.com/tether>.

USB tethering and data sharing

You can't share your phone's data connection and microSD card via USB at the same time. If you are using your USB connection to make your microSD card available to your computer, you must disconnect it first.

Before you start! To use USB tethering, you need to install the “LG USB Driver” on to your PC first.

The LG USB Driver is downloadable from the following site: http://www.lg.com/ca_en → Click **Support** → **Mobile Phone support** → Select the Model **LGP999** → Click **Install LG Mobile Support Tool > “install USB Driver”**. to download.

1. Use the USB cable that came with your phone to connect your phone to your computer.
2. On the Home screen, touch the **Applications** tab and select **Settings**.
3. Touch **Wireless & networks** and select **Tethering & portable hotspot**.

4. Touch **USB tethering** to turn on the function.

A checkmark indicates that the function is active.

- The phone starts sharing its mobile network data connection with your computer, via USB connection. An ongoing notification  is added to the Status Bar and Notifications Panel.

5. Uncheck **USB tethering** to stop sharing your data connection. Or just disconnect the USB cable.

NOTE: When using USB tethering, your phone can be connected to 3G network only. You will not be able to connect to a Wi-Fi network.

To share your phone's data connection as a portable Wi-Fi hotspot (Wi-Fi tethering)

1. On the Home screen, touch the **Applications tab** and select **Settings**.
2. Touch **Wireless & networks** and select **Tethering & portable hotspot**.
3. Touch **Portable Wi-Fi hotspot** to turn on the function. A checkmark indicates that the function is active.
 - After a moment, the phone starts broadcasting its Wi-Fi network name (SSID) so you can connect to it with up to eight computers or other devices. An ongoing notification  is added to the Status Bar and Notifications Panel.
 - When **Portable Wi-Fi hotspot** is checked, you can change its network name or secure it.
4. Uncheck **Portable Wi-Fi hotspot** to stop sharing your data connection via Wi-Fi.

To rename or secure your portable hotspot

You can change the name of your phone's Wi-Fi network name (SSID) and secure its Wi-Fi network.

1. On the Home screen, touch the **Applications** tab and select **Settings**.
2. Touch **Wireless & networks** and select **Tethering & portable hotspot**.
3. Ensure **Portable Wi-Fi hotspot** is checked.
4. Touch **Portable Wi-Fi hotspot settings**.
5. Touch **Configure Wi-Fi hotspot**.
 - You can change the network SSID (name) that other computers see when scanning for Wi-Fi networks.
 - You can also touch the **Security** field to configure the network with Wi-Fi Protected Access 2 (WPA2) security, with a preshared key (PSK).
 - If you touch the **WPA2 PSK** security option, a password field is added. If you enter a password, you will need to enter that password when you connect to the phone's hotspot with a computer or other device. You can also touch **Open** in the **Security** menu to remove security from your Wi-Fi network.

ATTENTION! If you set the security option as **Open**, you cannot prevent unauthorized usage of online services by other people and additional charges can be incurred. To avoid unauthorized use, you are advised to keep the security option.

6. Touch Save.

Phone Software update

LG Mobile Phone Software update from internet

For more information on installing and using this program, please visit LG Home (<http://www.lg.com>) and go to Support > Mobile Phone Support with your PC.

This feature allows you to update the firmware of your phone to the newer version conveniently from the internet without the need to visit a service center. This feature is only available if and when LG makes the newer version of the firmware available for your device.

As the mobile phone firmware update requires the user's full attention for the duration of the update process, please make sure to check all instructions and notes that appear at each step before proceeding. Please note that removing the USB cable or battery during the upgrade may seriously damage your mobile phone.

NOTE: LG reserves the right to make firmware updates available only for selective models at its own discretion and does not guarantee the availability of the newer version of the firmware for all handset models.

Copyrights and trademarks

Rights to all technologies and products that comprise this device are the property of their respective owners:

- Bluetooth® is a registered trademark of Bluetooth SIG, Inc.
- microSD™ and the microSD logo are trademarks of the SD Card Association.
- Google™, Google Maps™, Gmail™, YouTube™, Google Talk™ and Android Market™ are trademarks of Google, Inc.



Manufactured under license. DTS, the Symbol, & DTS and the Symbol together are registered trademarks & DTS Ultra Mobile is a trademark of DTS, Inc. Product includes software. © DTS, Inc. All Rights Reserved.

- Wi-Fi is a registered trademark of the Wireless Fidelity Alliance, Inc.
-  **DOLBY**
DIGITAL PLUS
Manufactured under license from Dolby Laboratories. "Dolby" and the double-D symbol are trademarks of Dolby Laboratories.



Use of Adobe® Flash® Player or Adobe AIR® technology under license from Adobe Systems Incorporated.

Copyright © 1995-2011.

- DivX Mobile**



ABOUT DIVX VIDEO: DivX® is a digital video format created by DivX Inc. This is an official DivX Certified® device that plays DivX video. Visit www.divx.com for more information and software tools to convert your files into DivX video.

ABOUT DIVX VIDEO-ON-DEMAND: This DivX Certified® device must be registered in order to play purchased DivX Video-on-Demand (VOD) movies. To obtain your registration code, locate the DivX VOD section in your device setup menu. Go to vod.divx.com for more information on how to complete your registration.

DivX Certified® to play DivX® video up to HD 720p, including premium content.

May play DivX® video up to [1920x1080]*.

DivX®, DivX Certified® and associated logos are trademarks of DivX Inc. and are used under license.

Accessories

These accessories are available for use with the LG-P999.
(Items described below may be optional.)

Charger



USB cable

Connect your LG-P999 and PC.



Battery



User Guide

Learn more about your LG-P999.



Stereo headset



NOTE:

- Always use genuine LG accessories. Failure to do this may void your warranty.
- Accessories may vary in different regions.

Technical data

Ambient Temperatures

Max: +55°C (discharging), +45°C (charging)

Min: -10°C

Battery Standby and Talk Time

Talk time: Approx. 7 Hours

Standby: Approx. 15 days



Standby and talk times will vary depending on phone usage patterns and conditions. Battery power consumption depends on factors such as network configuration, signal strength, operating temperature, features selected, frequency of calls, and voice, data, and other application usage patterns.

FAQ



Please check to see if any problems you have encountered with your phone are described in this section before taking the phone in for service or calling a service representative.



Category Sub-Category	Question	Answer
BT Bluetooth Devices	What are the functions available via Bluetooth?	You can connect Bluetooth audio device such as Stereo/Mono headset, Car Kit and share pictures, videos, contacts, etc via Gallery/Contacts menu. Also when FTP server is connected to a compatible device, you can share contents stored in the SD card.
BT Bluetooth Headset	If my Bluetooth headset is connected, can I listen to my music through my 3.5mm wired headphones?	When a Bluetooth headset is connected, all system sounds are played over the headset. As a result, you will not be able to listen to music through your wired headphones.
Data Contacts Backup	How can I back up Contacts?	The Contacts data can be synchronized between your phone and Gmail™.
Data Synchronization	Is it possible to set up one-way sync with Gmail?	Only two-way synchronization is available.
Data Synchronization	Is it possible to synchronize all the Email folders?	The Inbox is automatically synchronized. You can view other folders by pressing the Menu Key  and touch Folders to choose a folder.

Category Sub-Category	Question	Answer
Google™ Service Gmail Log-In	Should I have to log into Gmail whenever I want to access Gmail?	Once you log into Gmail, you don't need to log in Gmail again.
Google Service Google Account	Is it possible to filter emails?	No, email filtering is not supported via the phone.
Phone Function YouTube™	Is it possible to play YouTube videos?	Yes, YouTube videos are supported but may have to be viewed through the YouTube application (and not the browser).
Phone Function Email	What happens when I execute another application while writing an email?	Your email will automatically be saved as a draft.
Phone Function Ringtone	Is there a file size limitation for when I want to use a .MP3 file as a ringtone?	There is no file size limitation.
Phone Function Message Time	My phone does not display the time of receipt for messages older than 24 hrs. How can I change this?	You will only be able to see the times for messages received the same day.

Category Sub-Category	Question	Answer
Phone Function microSD Card	What is the maximum supported size for a memory card?	32 GB memory cards are compatible.
Phone Function Navigation	Is it possible to install another navigation application on my phone?	Any application that is available on Android Market™ and is compatible with the hardware can be installed and used.
Phone Function Synchronization	Is it possible to synchronize my contacts from all my email accounts?	Only Gmail and MS Exchange server(Company Email Server) contacts can be synchronized.
Phone Function Wait and Pause	Is it possible to save a contact with Wait and Pause in the numbers?	<p>If you transferred a contact with the W & P functions saved into the number, you will not be able to use those features. You will need to re-save each number.</p> <p>How to save with Wait and Pause:</p> <ol style="list-style-type: none"> 1. From the Home screen, press the Phone icon . 2. Dial the number, then press the Menu Key . 3. Touch Add 2-sec pause or Add wait.

Category Sub-Category	Question	Answer
Phone Function Security	What are the phone's security functions?	You are able to set the phone to require the entry of an Unlock Pattern before the phone can be accessed or used.
Phone Function Unlock Pattern	What should I do if I forget my the Unlock Pattern?	After attempting the Unlock Pattern 5 times, you can touch the Forget Pattern? option and use your Google account information to unlock your phone.
Phone Function Unlock Pattern	What should I do if I forgot the Unlock Pattern and I didn't create the Google account on the phone?	<p>Without entering the Unlock Pattern, you will not be able to access your phone.</p> <p>Caution: If you perform a factory reset, all user applications and user data will be deleted. Please remember to back up any important data before performing a factory reset.</p> <p>How to perform a factory reset:</p> <ol style="list-style-type: none"> 1. Turn the power off. 2. Press and hold the following keys at the same time for 15 seconds: Power/Lock Key + Down Volume Key. 3. When the LG logo is displayed, release the keys.

Category Sub-Category	Question	Answer
Phone Function Unlock Pattern	How do I create the Unlock Pattern?	<ol style="list-style-type: none"> 1. From the Home screen, press the Menu Key . 2. Touch Settings > Location & security. 3. Touch Set up screen lock (under the Screen unlock pattern section of the settings) > Pattern. The first time you do this, a short tutorial about creating an Unlock Pattern appears. 4. Set up by drawing your pattern once, then again for confirmation.
Phone Function Memory	Is it possible to save a picture to the internal memory after taking a picture?	<p>Yes. To change the location where your pictures are stored, follow the steps below.</p> <ol style="list-style-type: none"> 1. Open the Camera application. 2. Touch Settings > Storage > Phone memory. 3. Your photos will be stored to the internal phone memory.
Phone Function Memory	Will I know when my memory is full?	Yes, you will receive a notification.
Phone Function Language Support	Is it possible to change the language?	<p>The phone has bilingual capabilities. To change the language:</p> <ol style="list-style-type: none"> 1. From the Home screen, press the Menu Key  and touch Settings. 2. Touch Language & keyboard > Select language. 3. Touch the desired language.

Category Sub-Category	Question	Answer
Phone Function VPN	How do I set up a VPN?	VPN access configuration is different according to each company. To configure VPN access from your phone, you must obtain the details from your company's network administrator.
Phone Function Screen time out	My screen turns off after only 15 seconds. How can I change the amount of time for the backlight to turn off?	<ol style="list-style-type: none"> 1. From the Home screen, press the Menu Key . 2. Touch Settings > Display. 3. Under Display settings, touch Screen timeout. 4. Touch the preferred screen backlight timeout time.
Phone Function Tactile feedback	I've turned off haptic feedback on my phone. However, when I dial a number, the phone still vibrates. How do I turn this off?	<ol style="list-style-type: none"> 1. From the Home screen, press the Menu Key . 2. Touch Settings > Sound. 3. Touch Haptic feedback to remove the checkmark and disable the function.
Phone Function Wi-Fi & 3G	When Wi-Fi and 3G are both available, which service will my phone use?	<p>When using data, your phone may default to the Wi-Fi connection (if Wi-Fi connectivity on your phone is set to On). However, there will be no notification when your phone switches from one to the other.</p> <p>To know which data connection is being used, note the 3G or Wi-Fi icon at the top of your screen.</p>

Category Sub-Category	Question	Answer
Phone Function Home screen	Is it possible to remove an application from the Home screen?	Yes. Just touch and hold the icon until the trash can icon appears at the bottom-center of the screen. Then, without lifting your finger, drag the icon to the trash can.
Phone Function Application	I downloaded an application and it causes a lot of errors. How do I remove it?	<ol style="list-style-type: none"> 1. From the Home screen, press the Menu Key . 2. Touch Settings > Applications > Manage applications. 3. Touch the application, then touch Uninstall.
Phone Function Charger	Is it possible to charge my phone by USB data cable without installing the necessary USB driver?	No, the USB Driver will need to be installed.
Phone Function Alarm	Can I use music files for my Alarm?	<p>Yes. After saving a music file as a ringtone, you can use it for your alarm.</p> <ol style="list-style-type: none"> 1. Touch and hold a song in a library list. In the menu that opens, touch Use as phone ringtone. 2. In an alarm clock setting screen, select the song as a ringtone.

Category Sub-Category	Question	Answer
Phone Function Alarm	Will my alarm be audible or will it go off if the phone is turned off?	No, this is not supported.
Phone Function Alarm	If my Ringer Volume is set to Off or Vibrate, will I hear my Alarm?	Your Alarm is programmed to be audible even in these scenarios.
Phone Spec Battery Time	What is the maximum amount of time my phone's battery will last before I need to recharge it?	Talk time: Approx. 7 Hours Standby: Approx. 15 days
Phone Spec Band	Which wireless bands are supported by the phone?	The device is able to support AWS bands (1700 MHz and 2100 MHz) Also, the device is able to support GSM/DPRS/EDGE Frequency Bands (850 MHz, 900 MHz, 1800 MHz, and 1900 MHz bands)

Category	Question	Answer
Sub-Category		
Recovery Solution Factory Reset	How do I perform a factory reset?	<ol style="list-style-type: none"> 1. From the Home screen, press the Menu Key . 2. Touch Settings > Privacy > Factory data reset. 3. Read the warning and touch Reset phone. 4. Touch Erase everything. <p>Attention:</p> <p>If a factory reset is performed, all installed application and user data will be erased. Please remember to back up any important data before performing a factory reset.</p>
Recovery Solution Factory Reset	How can I perform a factory reset if I can't access the phone's setting menu?	<p>How to perform a factory reset:</p> <ol style="list-style-type: none"> 1. Turn the power off. 2. Press and hold the following keys at the same time for 15 seconds: Power/Lock Key + Down Volume Key. 3. When the LG logo is displayed, release the keys. <p>Attention:</p> <p>If a factory reset is performed, all installed applications and user data will be erased. Please remember to back up any important data before performing a factory reset.</p>

For Your Safety

Important Information

This user guide contains important information on the use and operation of this phone. Please read all the information carefully for optimal performance and to prevent any damage to or misuse of the phone. Any changes or modifications not expressly approved in this user guide could void your warranty for this equipment.

Before You Start

Safety Instructions



WARNING

To reduce the possibility of electric shock, do not expose your phone to high humidity areas, such as the bathroom, swimming pool, etc.

Always store your phone away from heat. Never store your phone in settings that may expose it to temperatures less than 32°F (0°C) or greater than 104°F (40°C), such as outside during extreme weather conditions or in your car on a hot day. Exposure to excessive cold or heat will result in malfunction, damage and/or catastrophic failure.

Be careful when using your phone near other electronic devices. RF emissions from your mobile phone may affect nearby in adequately shielded electronic equipment. You should consult with manufacturers of any personal medical devices such as pacemakers and hearing aides to determine if they are susceptible to interference from your mobile phone. Turn off your phone in a medical facility or at a gas station. Never place your phone in a microwave oven as this will cause the battery to explode.

IMPORTANT! Please read the TIA SAFETY INFORMATION on page 116 before using your phone.

Safety Information

Read these simple guidelines. Breaking the rules may be dangerous or illegal. Further detailed information is given in this user guide.

- Never use an unapproved battery since this could damage the phone and/or battery and could cause the battery to explode.
- Never place your phone in a microwave oven as it will cause the battery to explode.
- Do not dispose of your battery by fire or with hazardous or flammable materials.
- Make sure that no sharp-edged items come into contact with the battery. There is a risk of this causing a fire.
- Store the battery in a place out of reach of children.
- Be careful that children do not swallow any parts such as rubber plugs (earphone, connection parts of the phone, etc.). This could cause asphyxiation or suffocation.
- Unplug the power cord and charger during lightning storms to avoid electric shock or fire.
- When riding in a car, do not leave your phone or set up the hands-free kit near to the air bag. If wireless equipment is improperly installed and the air bag is activated, you may be seriously injured.
- Do not use a hand-held phone while driving.
- Do not use the phone in areas where its use is prohibited. (For example: aircraft).
- Do not expose the battery charger or adapter to direct sunlight or use it in places with high humidity, such as a bathroom.
- Never store your phone in temperatures less than -4°F (-20°C) or greater than 122°F (50°C).

- Do not use harsh chemicals (such as alcohol, benzene, thinners, etc.) or detergents to clean your phone. There is a risk of this causing a fire.
- Do not drop, strike, or shake your phone severely. Such actions may harm the internal circuit boards of the phone.
- Do not use your phone in high explosive areas as the phone may generate sparks.
- Do not damage the power cord by bending, twisting, pulling, or heating.
- Do not use the plug if it is loose as it may cause a fire or electric shock.
- Do not place any heavy items on the power cord. Do not allow the power cord to be crimped as it may cause fire or electric shock.
- Do not handle the phone with wet hands while it is being charged. It may cause an electric shock or seriously damage your phone.
- Do not disassemble the phone.
- Do not place or answer calls while charging the phone as it may short-circuit the phone and/or cause electric shock or fire.
- Only use the batteries, antennas, and chargers provided by LG. The warranty will not be applied to products provided by other suppliers.
- Only authorized personnel should service the phone and its accessories. Faulty installation or service may result in accidents and consequently invalidate the warranty.
- Do not hold or let the antenna come in contact with your body during a call.
- An emergency call can be made only within a service area. For an emergency call, make sure that you are within a service area and that the phone is turned on.
- Use accessories, such as earphones and headsets, with caution. Ensure that cables are tucked away safely and do not touch the antenna unnecessarily.

Memory card information and care

- Always insert/ remove the memory card while the handset power is off. If you remove it while the power is on, it may be damaged.
- If a damage cannot be fixed, format the memory card.
- The memory card cannot be used for recording copyright protected data.
- Do not write forcefully on the memo area.
- Carry and store the memory card in its case.
- Do not allow the memory card to get wet.
- Do not leave the memory card in extremely hot location.
- Do not disassemble or modify the memory card.

FCC RF Exposure Information

WARNING

Read this information before operating the phone.

In August 1996, the Federal Communications Commission (FCC) of the United States, with its action in Report and Order FCC 96-326, adopted an updated safety standard for human exposure to radio frequency (RF) electromagnetic energy emitted by FCC regulated transmitters. Those guidelines are consistent with the safety standard previously set by both U.S. and international standards bodies.

The design of this phone complies with the FCC guidelines and these international standards.

CAUTION

Use only the supplied and approved antenna. Use of unauthorized antennas or modifications could impair call quality, damage the phone, void your warranty and/or result in violation of FCC regulations. Do not use the phone with a damaged antenna. If a damaged antenna comes into contact with skin, a minor burn may result. Contact your local dealer for a replacement antenna.

Body-worn Operation

This device was tested for typical body-worn operations with the back of the phone kept 2cm (0.79 inches) between the user's body and the back of the phone. To comply with FCC RF exposure requirements, a minimum separation distance of 2cm (0.79 inches) must be maintained between the user's body and the back of the phone. Third-party belt-clips, holsters, and similar accessories containing metallic components should not be used.

Body-worn accessories that cannot maintain 2cm (0.79 inches) separation distance between the user's body and the back of the phone, and have not been tested for typical body-worn operations may not comply with FCC RF exposure limits and should be avoided.

Vehicle Mounted External Antenna (optional, if available)

A minimum separation distance of 20cm (8 inches) must be maintained between the user/bystander and the vehicle mounted external antenna to satisfy FCC RF exposure requirements. For more information about RF exposure, visit the FCC website at www.fcc.gov

FCC Part 15 Class B Compliance

This device and its accessories comply with part 15 of FCC rules and ICES-003 Class B digital apparatus requirements for Industry Canada. Operation is subject to the following two conditions:

- (1) This device and its accessories may not cause harmful interference, and
- (2) this device and its accessories must accept any interference received, including interference that may cause undesired operation.

Cautions for Battery

- Do not disassemble.
- Do not short-circuit.
- Do not expose to high temperature: 140°F (60°C).
- Do not incinerate.

Battery Disposal

- Please dispose of your battery properly or bring to your local wireless carrier for recycling.
- Do not dispose in fire or with hazardous or flammable materials.

Adapter (Charger) Cautions

- Using the wrong battery charger could damage your phone and void your warranty.
- The adapter or battery charger is intended for indoor use only.

Do not expose the adapter or battery charger to direct sunlight or use it in places with high humidity, such as the bathroom.

Avoid damage to your hearing

- Damage to your hearing can occur if you are exposed to loud sound for long periods of time. We therefore recommend that you do not turn on or off the handset close to your ear. We also recommend that music and call volumes are set to a reasonable level.
- If you are listening to music whilst out and about, please ensure that the volume is at a reasonable level so that you are aware of your surroundings. This is particularly imperative when attempting to cross the street.

Safety Guidelines

TIA Safety Information

Provided herein is the complete TIA Safety Information for Wireless Handheld phones. Inclusion of the text covering Pacemakers, Hearing Aids, and Other Medical Devices is required in the owner's manual for CTIA Certification. Use of the remaining TIA language is encouraged when appropriate.

Exposure to Radio Frequency Signal

Your wireless handheld portable telephone is a lowpower radio transmitter and receiver. When it is ON, it receives and also sends out radio frequency (RF) signals.

In August, 1996, the Federal Communications Commissions (FCC) adopted RF exposure guidelines with safety levels for handheld wireless phones.

Those guidelines are consistent with the safety standards previously set by both U.S. and international standards bodies:

ANSI C95.1 (1992) *

NCRP Report 86 (1986)

ICNIRP (1996)

Those standards were based on comprehensive and periodic evaluations of the relevant scientific literature. For example, over 120 scientists, engineers, and physicians from universities, government health agencies, and industry reviewed the available body of research to develop the ANSI Standard (C95.1).

* American National Standards Institute; National Council on Radiation Protection and Measurements; International Commission on Non-Ionizing Radiation Protection

The design of your phone complies with the FCC guidelines (and those standards).

Antenna Care

Use only the supplied or an approved replacement antenna. Unauthorized antennas, modifications, or attachments could damage the phone and may violate FCC regulations.

Phone Operation

NORMAL POSITION: Hold the phone as you would any other telephone with the antenna pointed up and over your shoulder.

Tips on Efficient Operation

For your phone to operate most efficiently:

- Do not touch the antenna unnecessarily when the phone is in use. Contact with the antenna affects call quality and may cause the phone to operate at a higher power level than otherwise needed.

Driving

Check the laws and regulations on the use of wireless phones in the areas where you drive. Always obey them. Also, if using your phone while driving, please:

- Give full attention to driving - driving safely is your first responsibility;
- Use hands-free operation, if available;
- Pull off the road and park before making or answering a call if driving conditions so require.

Electronic Devices

Most modern electronic equipment is shielded from RF signals.

However, certain electronic equipment may not be shielded against the RF signals from your wireless phone.

Pacemakers

The Health Industry Manufacturers Association recommends that a minimum separation of six (6") inches be maintained between a handheld wireless phone and a pacemaker to avoid potential interference with the pacemaker. These recommendations are consistent with the independent research by and recommendations of Wireless Technology Research. Persons with pacemakers:

- Should ALWAYS keep the phone more than six inches from their pacemaker when the phone is turned ON;
- Should not carry the phone in a breast pocket.
- Should use the ear opposite the pacemaker to minimize the potential for interference.
- If you have any reason to suspect that interference is taking place, turn your phone OFF immediately.

Hearing Aids

Some digital wireless phones may interfere with some hearing aids. In the event of such interference, you may want to consult your service provider.

Other Medical Devices

If you use any other personal medical device, consult the manufacturer of your device to determine if they are adequately shielded from external RF energy. Your physician may be able to assist you in obtaining this information.

Health Care Facilities

Turn your phone OFF in health care facilities when any regulations posted in these areas instruct you to do so. Hospitals or health care facilities may use equipment that could be sensitive to external RF energy.

Vehicles

RF signals may affect improperly installed or inadequately shielded electronic systems in motor vehicles. Check with the manufacturer or its representative regarding your vehicle.

You should also consult the manufacturer of any equipment that has been added to your vehicle.

Posted Facilities

Turn your phone OFF in any facility where posted notices so require.

Aircraft

FCC regulations prohibit using your phone while in the air. Turn your phone OFF before boarding an aircraft.

Blasting Areas

To avoid interfering with blasting operations, turn your phone OFF when in a blasting areas or in areas posted: 'Turn off two-way radio'. Obey all signs and instructions.

Potentially Explosive Atmosphere

Turn your phone OFF when in any area with a potentially explosive atmosphere and obey all signs and instructions. Sparks in such areas could cause an explosion or fire resulting in bodily injury or even death.

Areas with a potentially explosive atmosphere are often, but not always, marked clearly.

Potential areas may include: fueling areas (such as gasoline stations); below deck on boats; fuel or chemical transfer or storage facilities; vehicles using liquefied petroleum gas (such as propane or butane); areas where the air contains chemicals or particles (such as grain, dust, or metal powders); and any other area where you would normally be advised to turn off your vehicle engine.

For Vehicles Equipped with an Air Bag

An air bag inflates with great force. DO NOT place objects, including either installed or portable wireless equipment, in the area over the air bag or in the air bag deployment area. If in-vehicle wireless equipment is improperly installed and the air bag inflates, serious injury could result.

Safety Information

Please read and observe the following information for safe and proper use of your phone and to prevent damage. Also, keep the user guide in an accessible place at all the times after reading it.

Charger and Adapter Safety

- The charger and adapter are intended for indoor use only.

Battery Information and Care

- Please dispose of your battery properly or take it to your local wireless carrier for recycling.
- The battery does not need to be fully discharged before recharging.
- Use only LG-approved chargers specific to your phone model since they are designed to maximize battery life.
- Do not disassemble or impact the battery as it may cause electric shock, short-circuit, and fire. Store the battery in a place out of reach of children.
- Keep the battery's metal contacts clean.
- Replace the battery when it no longer provides acceptable performance. The battery can be recharged several hundred times before replacement.
- Recharge the battery after long periods of non-use to maximize battery life.
- Battery life will vary due to usage patterns and environmental conditions.
- Use of extended backlighting, Media Net Browsing, and data connectivity kits affect battery life and talk/standby times.

- The self-protection function of the battery cuts the power of the phone when its operation is in an abnormal state. In this case, remove the battery from the phone, reinstall it, and turn the phone on.
- Actual battery life will depend on network configuration, product settings, usage patterns, battery and environmental conditions.

Explosion, Shock, and Fire Hazards

- Do not put your phone in a place subject to excessive dust and keep the minimum required distance between the power cord and heat sources.
- Unplug the power cord prior to cleaning your phone, and clean the power plug pin when it is dirty.
- When using the power plug, ensure that it is firmly connected. If it is not, it may cause excessive heat or fire.
- If you put your phone in a pocket or bag without covering the receptacle of the phone (power plug pin), metallic articles (such as a coin, paperclip or pen) may short-circuit the phone. Always cover the receptacle when not in use.
- Do not short-circuit the battery. Metallic articles such as a coin, paperclip or pen in your pocket or bag may short-circuit the + and - terminals of the battery (metal strips on the battery) upon moving. Short-circuit of the terminal may damage the battery and cause an explosion.

General Notice

- Using a damaged battery or placing a battery in your mouth may cause serious injury.
- Do not place items containing magnetic components such as a credit card, phone card, bank book or subway ticket near your phone. The magnetism of the phone may damage the data stored in the magnetic strip.
- Talking on your phone for a long period of time may reduce call quality due to heat generated during use.

- When the phone is not used for a long period time, store it in a safe place with the power cord unplugged.
- Using the phone in proximity to receiving equipment (i.e., TV or radio) may cause interference to the phone.
- Do not use the phone if the antenna is damaged. If a damaged antenna contacts skin, it may cause a slight burn. Please contact an LG Authorized Service Centre to replace the damaged antenna.
- Do not immerse your phone in water. If this happens, turn it off immediately and remove the battery. If the phone does not work, take it to an LG Authorized Service Centre.
- Do not paint your phone.
- The data saved in your phone might be deleted due to careless use, repair of the phone, or upgrade of the software. Please backup your important phone numbers. (Ring tones, text messages, voice messages, pictures, and videos could also be deleted.) The manufacturer is not liable for damage due to the loss of data.
- When you use the phone in public places, set the ring tone to vibration so as not to disturb others.
- Do not turn your phone on or off when putting it in your ear.

FDA Consumer Update

The U.S. Food and Drug Administration Centre for Devices and Radiological Health Consumer Update on Mobile Phones.

1. Do wireless phones pose a health hazard?

The available scientific evidence does not show that any health problems are associated with using wireless phones. There is no proof, however, that wireless phones are absolutely safe. Wireless phones emit low levels of radio frequency energy (RF) in the microwave range while being used. They also emit very low levels of RF when in the standby mode. Whereas

high levels of RF can produce health effects (by heating tissue), exposure to low level RF that does not produce heating effects causes no known adverse health effects. Many studies of low level RF exposures have not found any biological effects. Some studies have suggested that some biological effects may occur, but such findings have not been confirmed by additional research. In some cases, other researchers have had difficulty in reproducing those studies, or in determining the reasons for inconsistent results.

2. What is the FDA's role concerning the safety of wireless phones?

Under the law, the FDA does not review the safety of radiation emitting consumer products such as wireless phones before they can be sold, as it does with new drugs or medical devices. However, the agency has authority to take action if wireless phones are shown to emit radio frequency energy (RF) at a level that is hazardous to the user. In such a case, the FDA could require the manufacturers of wireless phones to notify users of the health hazard and to repair, replace, or recall the phones so that the hazard no longer exists.

Although the existing scientific data do not justify FDA regulatory actions, the FDA has urged the wireless phone industry to take a number of steps, including the following:

- Support needed research into possible biological effects of RF of the type emitted by wireless phones;
- Design wireless phones in a way that minimizes any RF exposure to the user that is not necessary for device function; and
- Cooperate in providing of wireless phones with the best possible information on possible effects of wireless phone use on human health.

The FDA belongs to an interagency working group of the federal agencies that have responsibility for different aspects of RF safety to ensure coordinated efforts at the federal level. The following agencies belong to this working group:

- National Institute for Occupational Safety and Health
- Environmental Protection Agency
- Occupational Safety and Health Administration (Administración de la seguridad y salud laborales)
- Occupational Safety and Health Administration
- National Telecommunications and Information Administration

The National Institutes of Health participates in some interagency working group activities, as well.

The FDA shares regulatory responsibilities for wireless phones with the Federal Communications Commission (FCC). All phones that are sold in the United States must comply with FCC safety guidelines that limit RF exposure. The FCC relies on the FDA and other health agencies for safety questions about wireless phones.

The FCC also regulates the base stations that the wireless phone networks rely upon. While these base stations operate at higher power than do the wireless phones themselves, the RF exposures that people get from these base stations are typically thousands of times lower than those they can get from wireless phones. Base stations are thus not the subject of the safety questions discussed in this document.

3. What kinds of phones are the subject of this update?

The term 'wireless phone' refers here to handheld wireless phones with built-in antennas, often called 'cell', 'mobile', or 'PCS' phones. These types of wireless phones can expose the user to measurable radiofrequency energy (RF) because of the short distance between the phone and the user's head. These RF exposures are limited by FCC safety guidelines that were developed with the advice of the FDA and other federal health and safety agencies. When the phone is located at greater distances from the user, the exposure to RF is drastically lower because a person'

s RF exposure decreases rapidly with increasing distance from the source. The so-called 'cordless phones,' which have a base unit connected to the telephone wiring in a house, typically operate at far lower power levels, and thus produce RF exposures far below the FCC safety limits.

4. What are the results of the research done already?

The research done thus far has produced conflicting results, and many studies have suffered from flaws in their research methods. Animal experiments investigating the effects of radiofrequency energy (RF) exposures characteristic of wireless phones have yielded conflicting results that often cannot be repeated in other laboratories. A few animal studies, however, have suggested that low levels of RF could accelerate the development of cancer in laboratory animals. However, many of the studies that showed increased tumor development used animals that had been genetically engineered or treated with cancer causing chemicals so as to be predisposed to develop cancer in the absence of RF exposure. Other studies exposed the animals to RF for up to 22 hours per day. These conditions are not similar to the conditions under which people use wireless phones, so we don't know with certainty what the results of such studies mean for human health. Three large epidemiology studies have been published since December 2000. Between them, the studies investigated any possible association between the use of wireless phones and primary brain cancer, glioma, meningioma, or acoustic neuroma, tumors of the brain or salivary gland, leukemia, or other cancers. None of the studies demonstrated the existence of any harmful health effects from wireless phone RF exposures.

However, none of the studies can answer questions about longterm exposures, since the average period of phone use in these studies was around three years.

5. What research is needed to decide whether RF exposure from wireless phones poses a health risk?

A combination of laboratory studies and epidemiological studies of people actually using wireless phones would provide some of the data that are needed. Lifetime animal exposure studies could be completed in a few years. However, very large numbers of animals would be needed to provide reliable proof of a cancer promoting effect if one exists. Epidemiological studies can provide data that is directly applicable to human populations, but 10 or more years follow-up may be needed to provide answers about some health effects, such as cancer.

This is because the interval between the time of exposure to a cancer-causing agent and the time tumors develop - if they do may be many, many years. The interpretation of epidemiological studies is hampered by difficulties in measuring actual RF exposure during day-to-day use of wireless phones. Many factors affect this measurement, such as the angle at which the phone is held, or which model of phone is used.

6. What is the FDA doing to find out more about the possible health effects of wireless phone RF?

The FDA is working with the U.S. National Toxicology Program and with groups of investigators around the world to ensure that high priority animal studies are conducted to address important questions about the effects of exposure to radiofrequency energy (RF). The FDA has been a leading participant in the World Health Organization International Electromagnetic Fields (EMF) Project since its inception in 1996. An influential result of this work has been the development of a detailed agenda of research needs that has driven the establishment of new research programs around the world. The project has also helped develop a series of public information documents on EMF issues. The FDA and the Cellular Telecommunications & Internet Association (CTIA) have a formal Cooperative Research and

Development Agreement (CRADA) to do research on wireless phone safety. The FDA provides the scientific oversight, obtaining input from experts in government, industry, and academic organizations. CTIA funded research is conducted through contracts with independent investigators. The initial research will include both laboratory studies and studies of wireless phone users. The CRADA will also include a broad assessment of additional research needs in the context of the latest research developments around the world.

7. How can I find out how much radiofrequency energy exposure I can get by using my wireless phone?

All phones sold in the United States must comply with Federal Communications Commission (FCC) guidelines that limit radiofrequency energy (RF) exposures.

The FCC established these guidelines in consultation with the FDA and the other federal health and safety agencies. The FCC limit for RF exposure from wireless telephones is set at a Specific Absorption Rate (SAR) of 1.6 watts per kilogram (1.6 W/kg). The FCC limit is consistent with the safety standards developed by the Institute of Electrical and Electronic Engineering (IEEE) and the National Council on Radiation Protection and Measurement. The exposure limit takes into consideration the body's ability to remove heat from the tissues that absorb energy from the wireless phone and is set well below levels known to have effects. Manufacturers of wireless phones must report the RF exposure level for each model of phone to the FCC. The FCC website (<http://www.fcc.gov/oet/rfsafety>) gives directions for locating the FCC identification number on your phone so you can find your phone's RF exposure level in the online listing.

8. What has the FDA done to measure the radiofrequency energy coming from wireless phones?

The Institute of Electrical and Electronic Engineers (IEEE) is developing a technical standard for measuring the radiofrequency energy (RF) exposure from wireless phones and other wireless handsets with the participation and leadership of FDA scientists and engineers. The standard, 'Recommended Practice for Determining the Spatial- Peak Specific Absorption Rate (SAR) in the Human Body Due to Wireless Communications Devices: Experimental Techniques,' sets forth the first consistent test methodology for measuring the rate at which RF is deposited in the heads of wireless phone users. The test method uses a tissuesimulating model of the human head. Standardized SAR test methodology is expected to greatly improve the consistency of measurements made at different laboratories on the same phone. SAR is the measurement of the amount of energy absorbed in tissue, either by the whole body or a small part of the body. It is measured in watts/kg (or milliwatts/g) of matter. This measurement is used to determine whether a wireless phone complies with safety guidelines.

9. What steps can I take to reduce my exposure to radiofrequency energy from my wireless phone?

If there is a risk from these products - and at this point we do not know that there is - it is probably very small. But if you are concerned about avoiding even potential risks, you can take a few simple steps to minimize your exposure to radiofrequency energy (RF). Since time is a key factor in how much exposure a person receives, reducing the amount of time spent using a wireless phone will reduce RF exposure. If you must conduct extended conversations by wireless phone every day, you could place more distance between your body and the source of the RF, since the exposure level drops off dramatically with distance. For example, you could use a headset and carry the wireless phone away from your body or use

a wireless phone connected to a remote antenna. Again, the scientific data do not demonstrate that wireless phones are harmful. But if you are concerned about the RF exposure from these products, you can use measures like those described above to reduce your RF exposure from wireless phone use.

10. What about children using wireless phones?

The scientific evidence does not show a danger to users of wireless phones, including children and teenagers. If you want to take steps to lower exposure to radiofrequency energy (RF), the measures described above would apply to children and teenagers using wireless phones. Reducing the time of wireless phone use and increasing the distance between the user and the RF source will reduce RF exposure. Some groups sponsored by other national governments have advised that children be discouraged from using wireless phones at all. For example, the government in the United Kingdom distributed leaflets containing such a recommendation in December 2000. They noted that no evidence exists that using a wireless phone causes brain tumors or other ill effects. Their recommendation to limit wireless phone use by children was strictly precautionary; it was not based on scientific evidence that any health hazard exists.

11. What about wireless phone interference with medical equipment?

Radiofrequency energy (RF) from wireless phones can interact with some electronic devices. For this reason, the FDA helped develop a detailed test method to measure electromagnetic interference (EMI) of implanted cardiac pacemakers and defibrillators from wireless telephones. This test method is now part of a standard sponsored by the Association for the Advancement of Medical Instrumentation (AAMI). The final draft, a joint effort by the FDA, medical device manufacturers, and many other groups, was completed in late 2000. This standard will allow manufacturers to

ensure that cardiac pacemakers and defibrillators are safe from wireless phone EMI. The FDA has tested hearing aids for interference from handheld wireless phones and helped develop a voluntary standard sponsored by the Institute of Electrical and Electronic Engineers (IEEE). This standard specifies test methods and performance requirements for hearing aids and wireless phones so that no interference occurs when a person uses a 'compatible' phone and a 'compatible' hearing aid at the same time. This standard was approved by the IEEE in 2000. The FDA continues to monitor the use of wireless phones for possible interactions with other medical devices. Should harmful interference be found to occur, the FDA will conduct testing to assess the interference and work to resolve the problem.

12. Where can I find additional information?

For additional information, please refer to the following resources: FDA web page on wireless phones (<http://www.fda.gov/>)

Federal Communications Commission (FCC) RF Safety Program (<http://www.fcc.gov/oet/rfsafety>)

International Commission on Non-Ionizing Radiation Protection (<http://www.icnirp.de>)

World Health Organization
(WHO) International EMF Project
(<http://www.who.int/emf>)

National Radiological Protection Board (UK)
(<http://www.nrpb.org.uk/>)

10 Driver Safety Tips

Your wireless phone gives you the powerful ability to communicate by voice almost anywhere, anytime. An important responsibility accompanies the benefits of wireless phones, one that every user must uphold.

When operating a car, driving is your first responsibility.

When using your wireless phone behind the wheel of a car, practice good common sense and remember the following tips:

1. Get to know your wireless phone and its features such as speed dial and redial. Carefully read your instruction manual and learn to take advantage of valuable features most phones offer, including automatic redial and memory. Also, work to memorize the phone keypad so you can use the speed dial function without taking your attention off the road.
2. When available, use a handsfree device. A number of handsfree wireless phone accessories are readily available today. Whether you choose an installed mounted device for your wireless phone or a speaker phone accessory, take advantage of these devices if available to you.
3. Position your wireless phone within easy reach. Make sure you place your wireless phone within easy reach and where you can reach it without removing your eyes from the road. If you get an incoming call at an inconvenient time, if possible, let your voicemail answer it for you.
4. Suspend conversations during hazardous driving conditions or situations. Let the person you are speaking with know you are driving; if necessary, suspend the call in heavy traffic or hazardous weather conditions. Rain, sleet, snow and ice can be hazardous, but so is heavy traffic. As a driver, your first responsibility is to pay attention to the road.
5. Do not take notes or look up phone numbers while driving. If you are reading an address book or business card, or writing a "to-do" list while driving a car, you are not watching where you are going. It is common sense. Don't get caught in a dangerous situation because you are reading or writing and not paying attention to the road or nearby vehicles.
6. Dial sensibly and assess the traffic; if possible, place calls when you are not moving or before pulling into traffic. Try to plan your calls before you begin your trip or attempt to coincide your calls with times you may be stopped

at a stop sign, red light or otherwise stationary. But if you need to dial while driving, follow this simple tip – dial only a few numbers, check the road and your mirrors, then continue.

7. Do not engage in stressful or emotional conversations that may be distracting. Stressful or emotional conversations and driving do not mix; they are distracting and even dangerous when you are behind the wheel of a car. Make people you are talking with aware you are driving and if necessary, suspend conversations which have the potential to divert your attention from the road.
8. Use your wireless phone to call for help. Your wireless phone is one of the greatest tools you can own to protect yourself and your family in dangerous situations – with your phone at your side, help is only three numbers away. Dial 911 or other local emergency number in the case of fire, traffic accident, road hazard or medical emergency. Remember, it is a free call on your wireless phone!
9. Use your wireless phone to help others in emergencies. Your wireless phone provides you a perfect opportunity to be a "Good Samaritan" in your community. If you see an auto accident, crime in progress or other serious emergency where lives are in danger, call 911 or other local emergency number, as you would want others to do for you.
10. Call roadside assistance or a special wireless nonemergency assistance number when necessary. Certain situations you encounter while driving may require attention, but are not urgent enough to merit a call for emergency services. But you can still use your wireless phone to lend a hand. If you see a broken-down vehicle posing no serious hazard, a broken traffic signal, a minor traffic accident where no one appears injured or a vehicle, you know to be stolen, call roadside assistance or other special non-emergency wireless number.

For more information, please call to 888-901-SAFE, or visit our website www.wow-com.com

Consumer Information on SAR (Specific Absorption Rate)

This Model Phone Meets the Government's Requirements for Exposure to Radio Waves.

Your wireless phone is a radio transmitter and receiver. It is designed and manufactured not to exceed the emission limits for exposure to radiofrequency (RF) energy set by the Federal Communications Commission (FCC) of the U.S. Government. These limits are part of comprehensive guidelines and establish permitted levels of RF energy for the general population. The guidelines are based on standards that were developed by independent scientific organizations through periodic and thorough evaluation of scientific studies. The standards include a substantial safety margin designed to assure the safety of all persons, regardless of age and health.

The exposure standard for wireless mobile phones employs a unit of measurement known as the Specific Absorption Rate, or SAR. The SAR limit set by the FCC is 1.6W/kg. *

Tests for SAR are conducted using standard operating positions specified by the FCC with the phone transmitting at its highest certified power level in all tested frequency bands.

Although SAR is determined at the highest certified power level, the actual SAR level of the phone while operating can be well below the maximum value. Because the phone is designed to operate at multiple power levels to use only the power required to reach the network, in general, the closer you are to a wireless base station antenna, the lower the power output.

Before a phone model is available for sale to the public, it must be tested and certified to the FCC that it does not exceed the limit established by the government adopted requirement for safe exposure. The tests are performed in positions and locations (e.g., at the ear and worn on the body) as required

by the FCC for each model.

The highest SAR value for this model phone when tested for use at the ear is 0.83 W/kg and when worn on the body, as described in this user's manual, is 0.72 W/kg.

(Body-worn measurements differ among phones models, depending upon available accessories and FCC/IC requirements.) While there may be differences between SAR levels of various phones and at various positions, they all meet the government requirement for safe exposure.

The FCC has granted an Equipment Authorization for this model phone with all reported SAR levels evaluated as in compliance with the FCC RF emission guidelines. SAR information on this model phone is on file with the FCC and can be found under the Display Grant section of <http://www.fcc.gov/oet/ea/fccid> after searching on FCC ID: BEJP999DW.

Additional information on Specific Absorption Rates (SAR) can be found on the Cellular Telecommunications Industry Association (CTIA) website at <http://www.ctia.org/>

* In the United States and Canada, the SAR limit for mobile phones used by the public is 1.6 watts/kg (W/kg) averaged over one gram of tissue. The standard incorporates a substantial margin of safety to give additional protection for the public and to account for any variations in measurements.

* Product meets current FCC & IC Radio Frequency Exposure Guidelines.

FCC ID: BEJP999DW

IC ID: 2703C-P999

LIMITED WARRANTY STATEMENT

1. WHAT THIS WARRANTY COVERS:

LG offers you a limited warranty that the enclosed subscriber unit and its enclosed accessories will be free from defects in material and workmanship, according to the following terms and conditions:

1. The limited warranty for the product extends for ONE (1) year beginning on the date of purchase of the product by the original end user.
2. The limited warranty extends only to the original end user of the product and is not assignable or transferable to any subsequent purchaser/end user.
3. This warranty is good only to the original end user of the product during the warranty period as long as it is in Canada.
4. Upon request from LG, the consumer must provide information to reasonably prove the date of purchase.
5. During the applicable warranty period, LG will repair or replace at LG's sole option, without charge to the original end user, any defective component part of the phone or accessory.
6. LG may use rebuilt, reconditioned or new parts or components when repairing any product or replace a product with a rebuilt, reconditioned or new product.

2. WHAT THIS WARRANTY DOES NOT COVER:

1. Defects or damages resulting from use of the product in other than its normal and customary manner.
2. Defects or damages from abnormal use, abnormal conditions, improper storage, exposure to moisture or dampness, unauthorized modifications, unauthorized connections, unauthorized repair, misuse, neglect, abuse, accident, alteration, improper installation or other acts which are not the fault of LG, including damage caused by spills of food or liquids.
3. Breakage or damage to antennas unless caused directly by defects in material or workmanship.
4. The fact that the Customer Service Department at LG was not notified by the original end user of the alleged defect or malfunction of the product, during the warranty period.
5. Products which have had their serial numbers removed or made illegible.
6. Damage resulting from use of non-LG approved accessories.
7. All plastic surfaces and all other externally exposed parts that are scratched or damaged due to normal customer use.

8. Products serviced by non-authorized persons or companies.

Notes:

1. This limited warranty supersedes all other warranties, expressed or implied either in fact or by operations of law, statutory or otherwise, including, but not limited to any implied warranty of merchantability or fitness for a particular purpose.
2. Shipping damage is the sole responsibility of the shipping company.

3. EXCLUSION OF LIABILITY:

No other express warranty is applicable to this product.

THE DURATION OF ANY IMPLIED WARRANTIES, INCLUDING THE IMPLIED WARRANTY OF MARKETABILITY, IS LIMITED TO THE DURATION OF THE EXPRESS WARRANTY HEREIN. LG ELECTRONICS CANADA, INC. SHALL NOT BE LIABLE FOR THE LOSS OF THE USE OF THE PRODUCT, INCONVENIENCE, LOSS OR ANY OTHER DAMAGES, DIRECT OR CONSEQUENTIAL, ARISING OUT OF THE USE OF, OR INABILITY TO USE, THIS PRODUCT OR FOR ANY BREACH OF ANY EXPRESS OR IMPLIED WARRANTY, INCLUDING THE IMPLIED WARRANTY OF MARKETABILITY APPLICABLE TO THIS PRODUCT.

4. HOW TO GET WARRANTY SERVICE:

To obtain warranty service, please call the following telephone number from anywhere in Canada:

LG Electronics Canada, Inc.

Tel. 1-888-LG-Canada (1-888-542-2623)

http://www.lg.com/ca_en (see links to "Support > Mobile phone support")



LG Electronics Canada Inc.

Mississauga, Ontario