Component Placing, Electrical

Applicable for K850

Contents

1	Mounting drawing table	2
2	Mounting drawing.....	3
3	Revision history.....	6

1 Mounting drawing table

Board Number	Drawing	Comments
1200-2038 Rev 2B		

By using the “Search” function and enter the component name you can find the position of the component (Use Adobe Reader 7.0 or a later version). Example: You can see the component name highlighted on the circuit board (use zoom to enlarge).

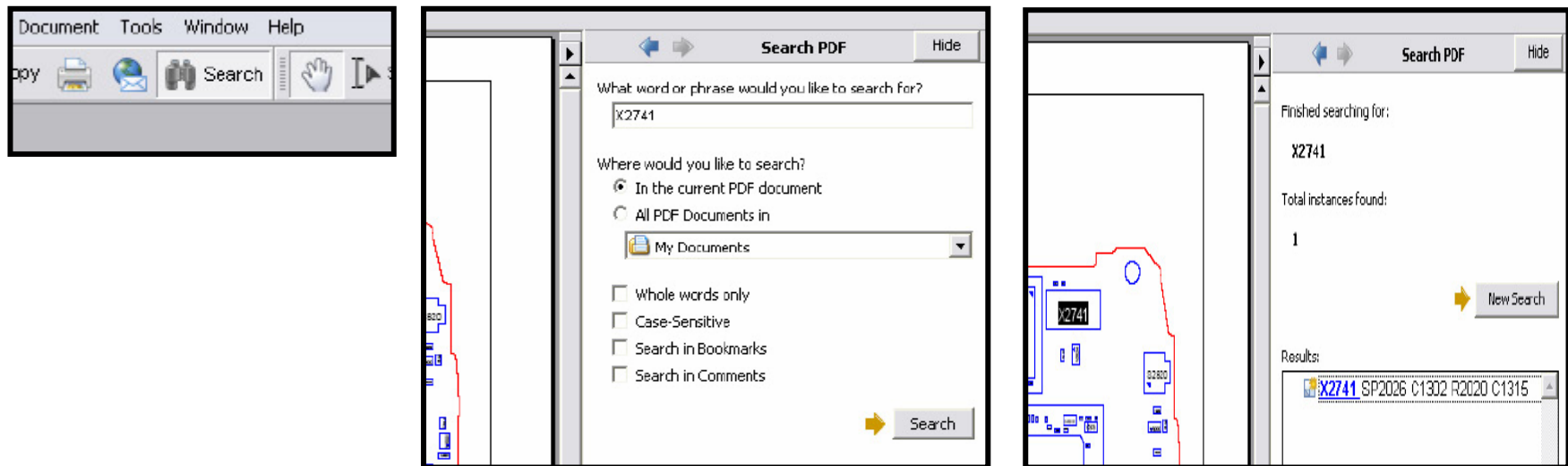

2 Mounting drawing

3 Revision history

Rev.	Date	Changes / Comments
A	2007-10-11	Initial release
2	2008-02-29	New board picture